

SILO 2 - SURFACE MOUNTING

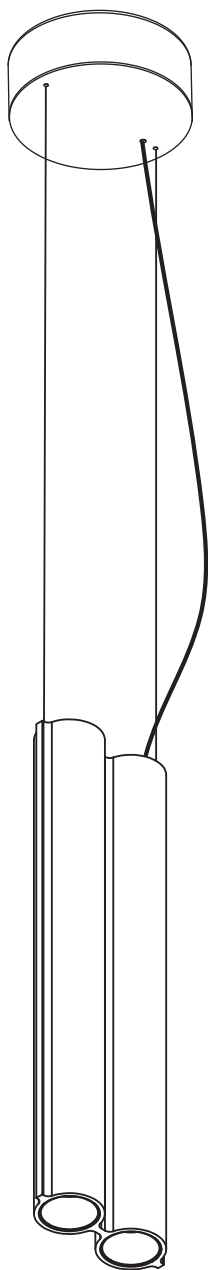

- Please read entire manual before beginning install
- To be installed by an electrician to an electrical box
- Use appropriate screws where necessary
- Wear enclosed gloves when handling lamp
- Handle materials with care. Please consult lamp maintenance sheet on our web site



**NEVER TURN ON POWER SUPPLY
UNTIL CONNECTIONS AND
INSTALLATION ARE COMPLETED.
DOING OTHERWISE COULD BE
HARMFUL TO YOUR LUMINAIRE.**

1

To remove cover,
push down where
indicated by image.

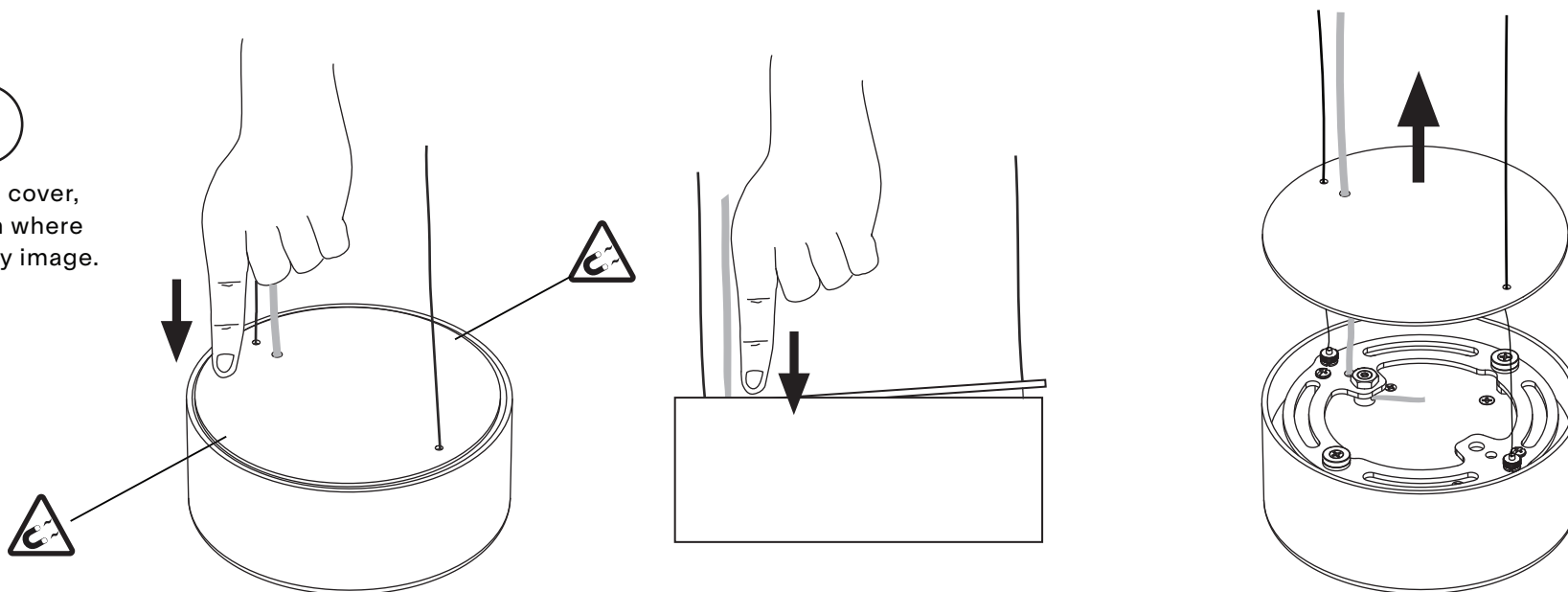

2

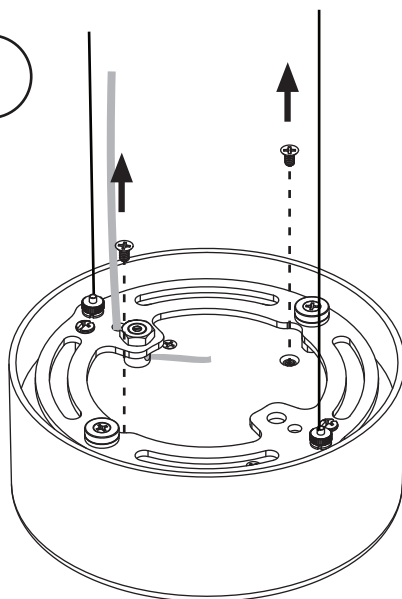

3

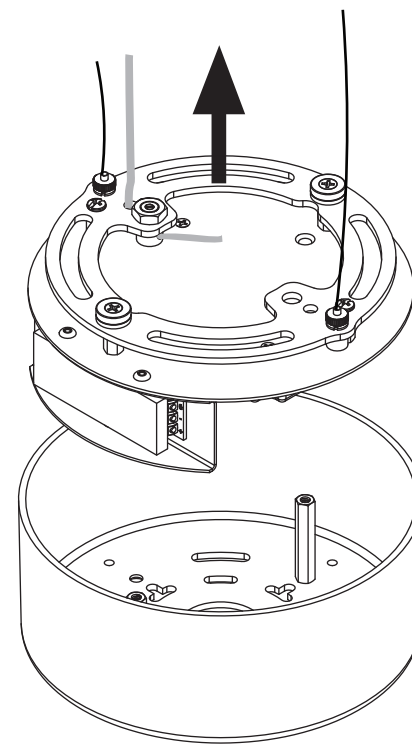

4

If provided, connect the extension harness to the junction box.

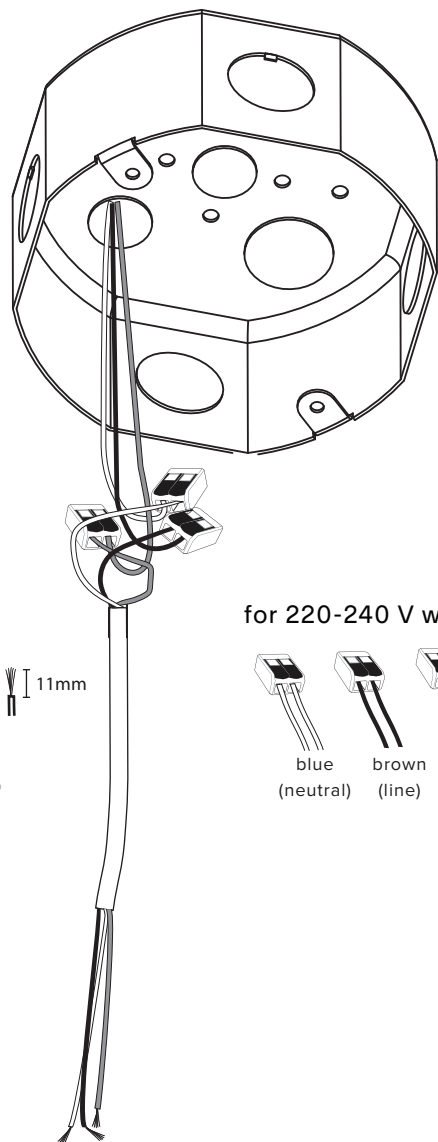

for 120 V wiring

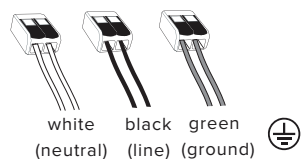

11mm

for 220-240 V wiring

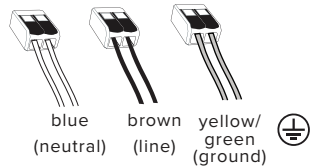

5

Note that the canopy is directional depending on standoffs.

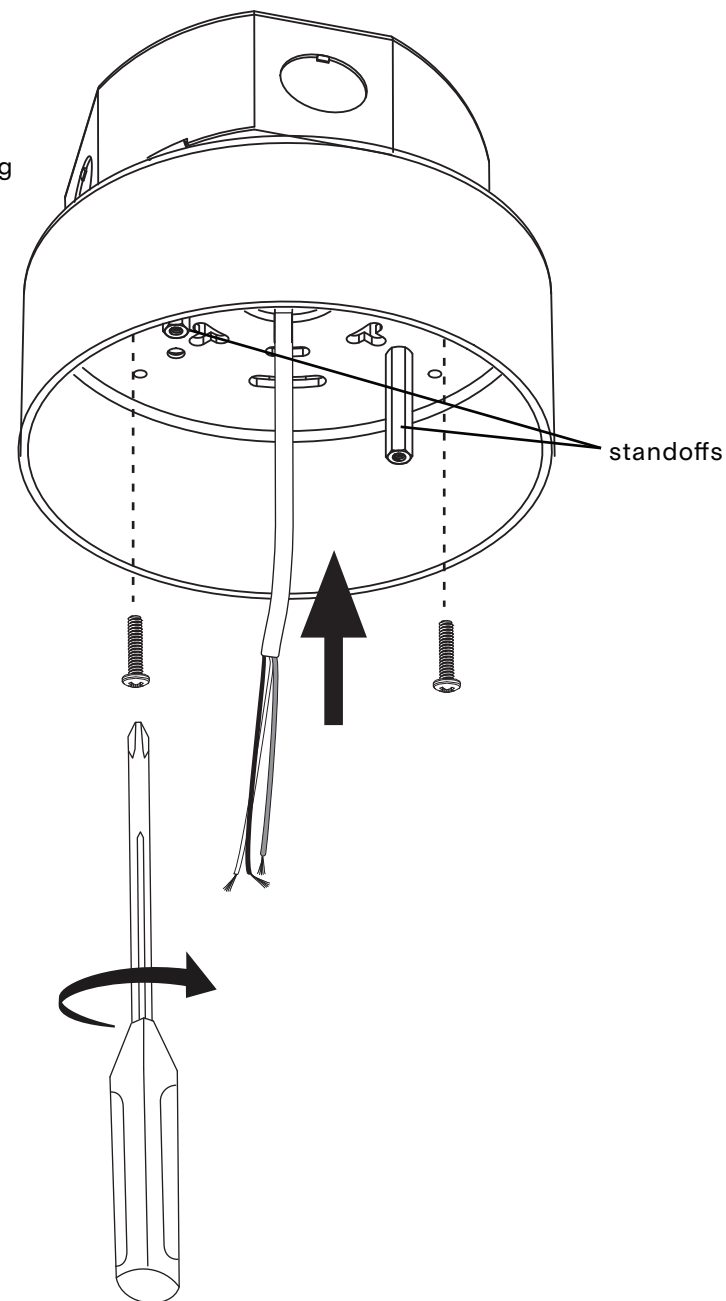

6

Have someone hold the luminaire while the connections are being made.

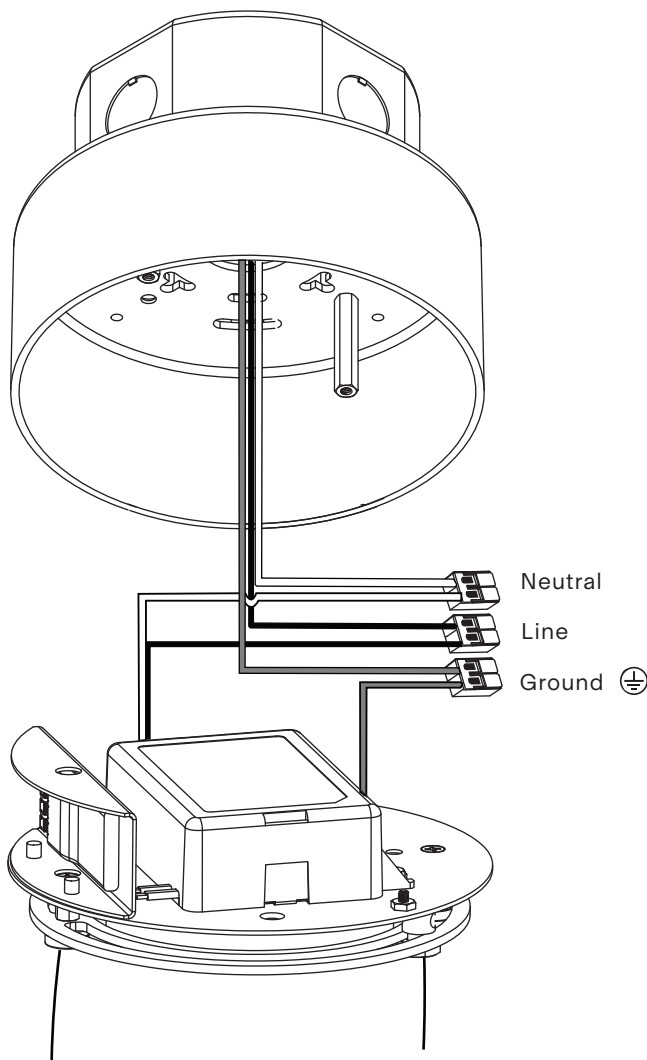

for 120 V wiring

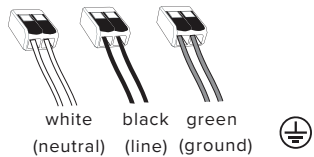

for 220-240 V wiring

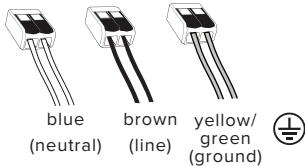

7

Dimming wiring (if equipped)
If not using, cap wires individually.

0-10V Dimming (if equipped)

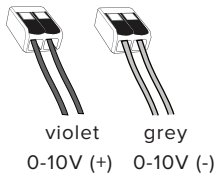

DALI Dimming (If equipped)

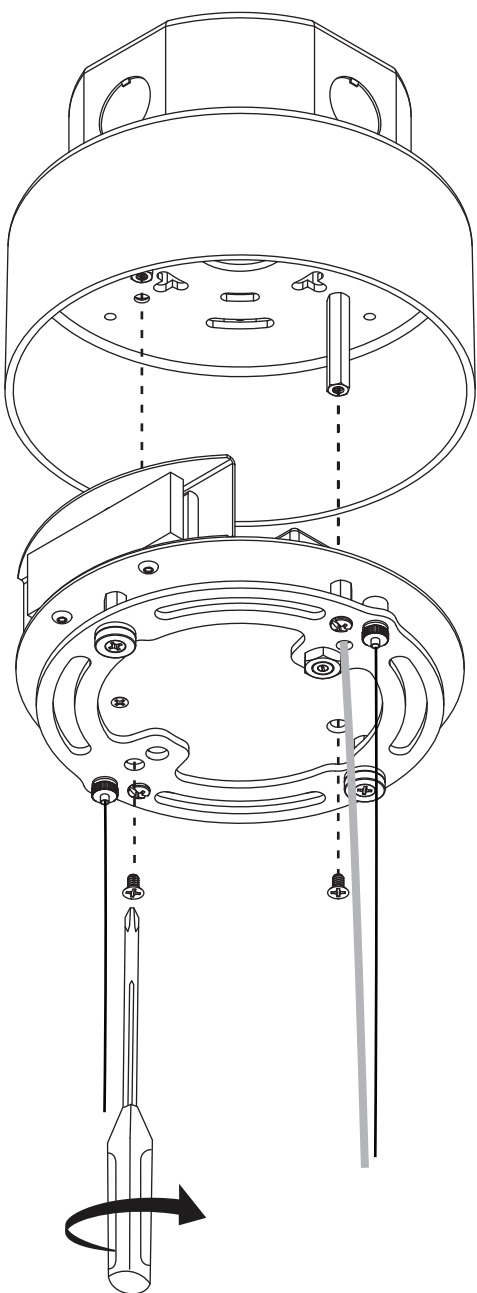
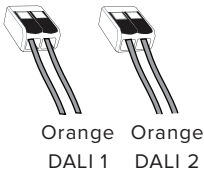

8

Level luminaire.

to lower luminaire

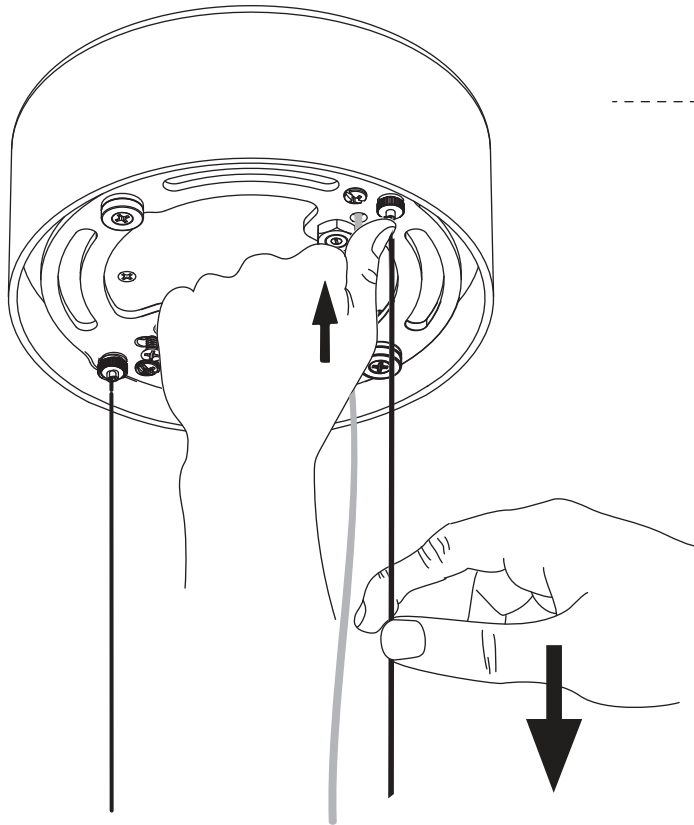

to raise luminaire

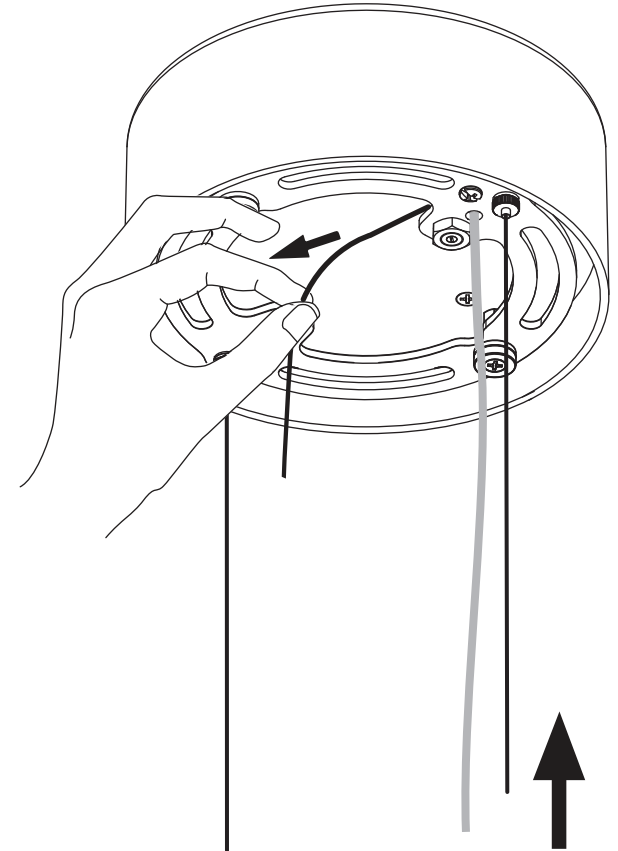

Losen lock, make adjustments as required, retighten lock.

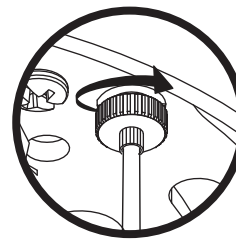
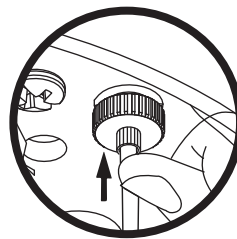
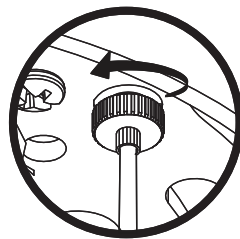

9

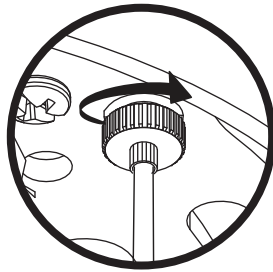
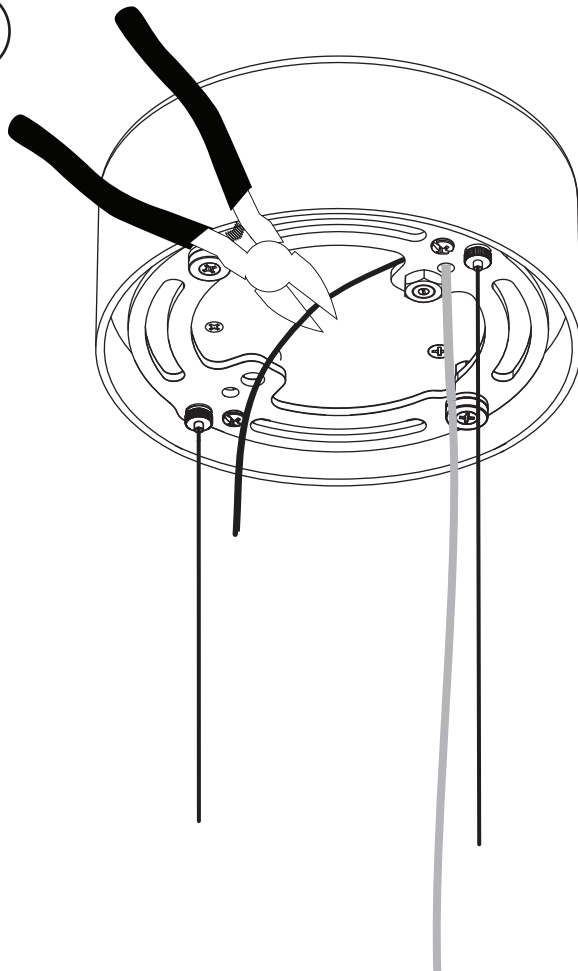

Secure lock when
desired height and level
are reached



Cut stainless steel
cables **ONLY** after
installation is complete
and luminaire is leveled.

10

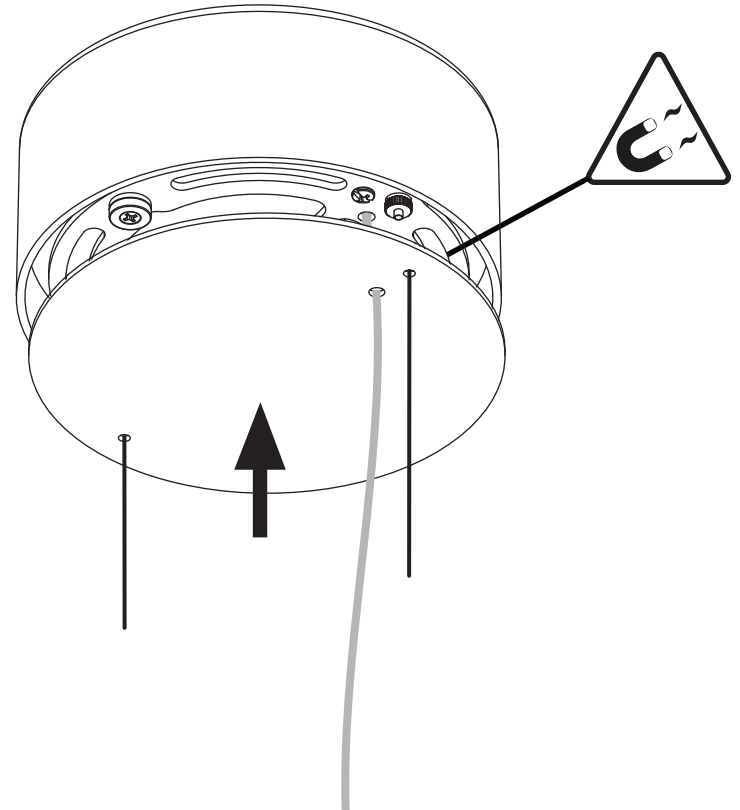

Determine desired cord length.

11

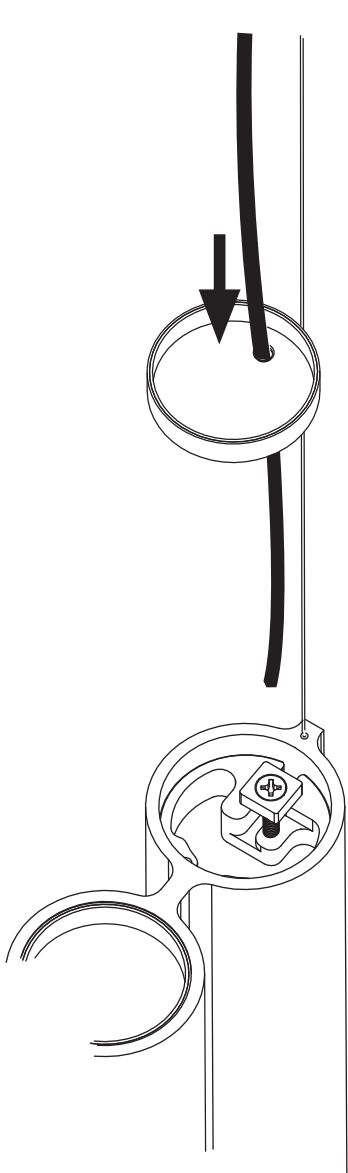

12

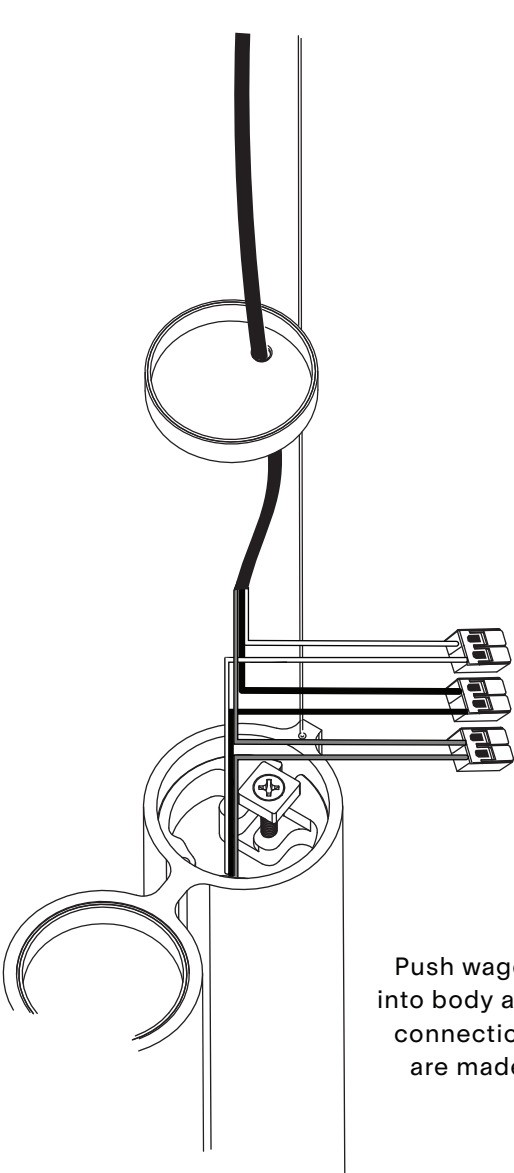

white to white
black to black
red to red

Push wago
into body after
connections
are made

13

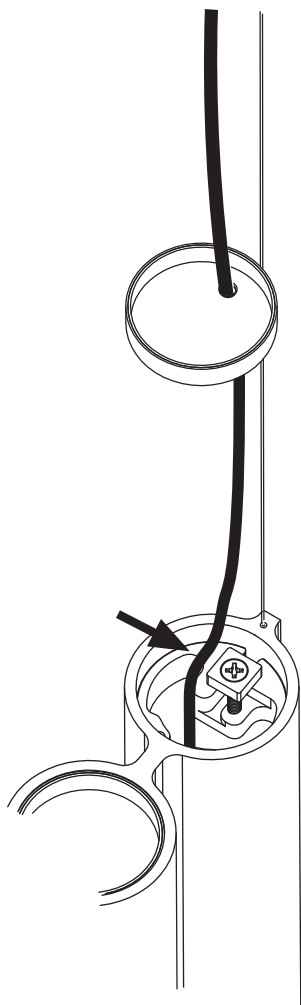

14

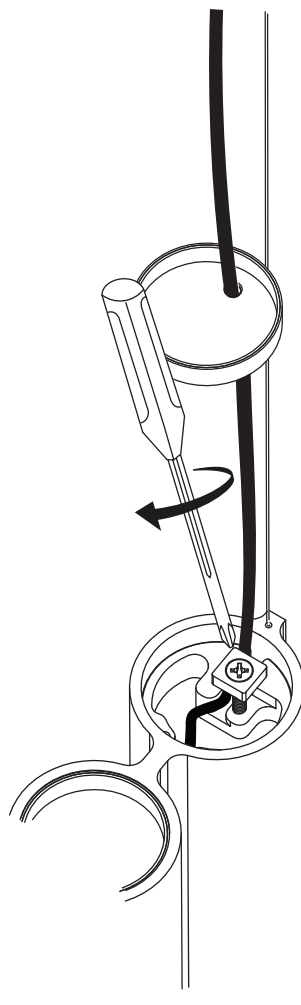

15

