

SHOWROOM PARCS

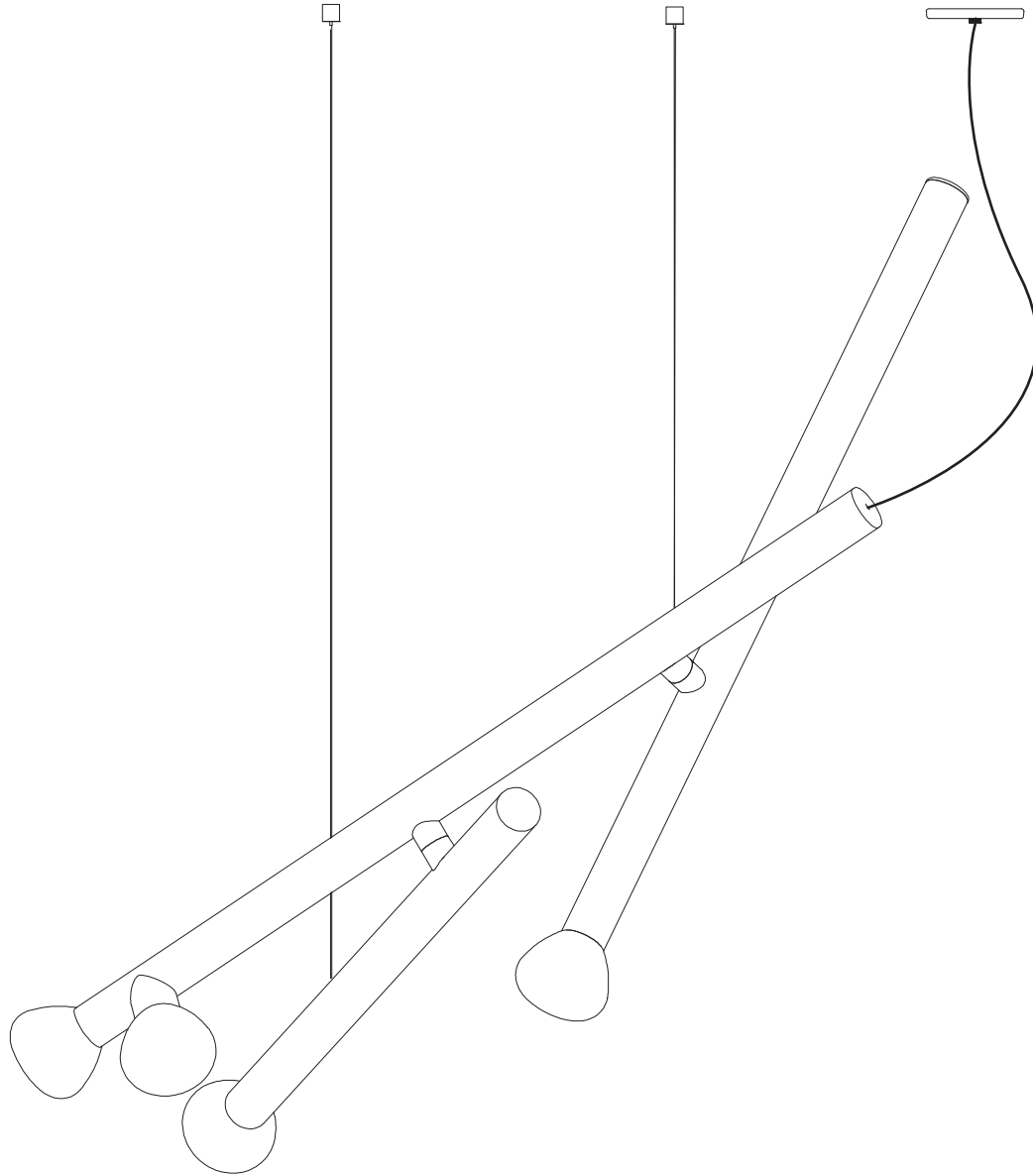

- Please read entire manual before beginning install
- To be installed by an electrician to an electrical box
- Use appropriate screws where necessary
- Wear enclosed gloves when handling lamp
- Handle materials with care. Please consult lamp maintenance sheet on our web site
- Should be used exclusively as a lamp and not as a shelving, display or hanging unit



1

Position the three arms
on a non abrasive surface
as represented here.

Sockets facing right.
Caps facing left.

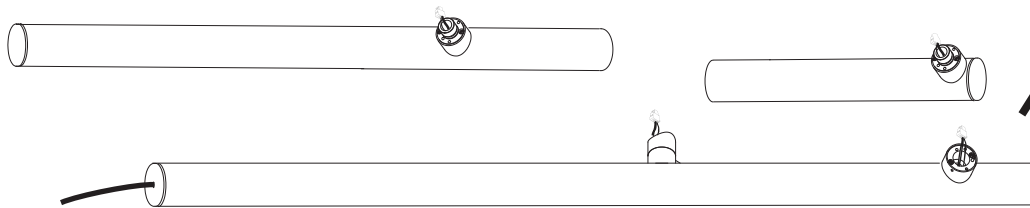

Attach quick-connectors

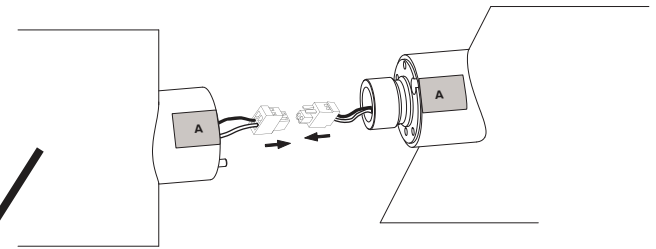

Carefully push quick-connectors into arm.

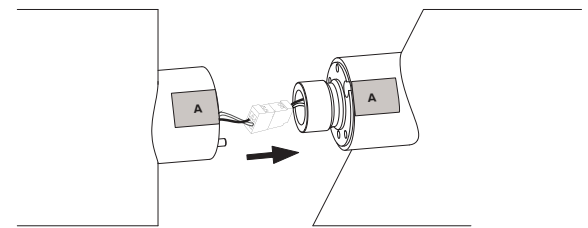

Align connector pin and
push arms together

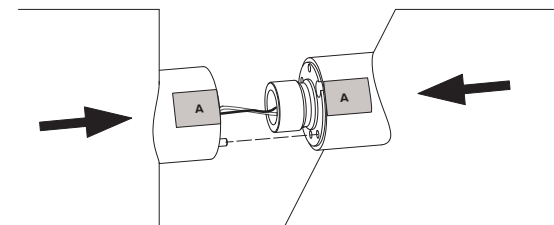

Make sure there are no gaps
and that the tapes are aligned

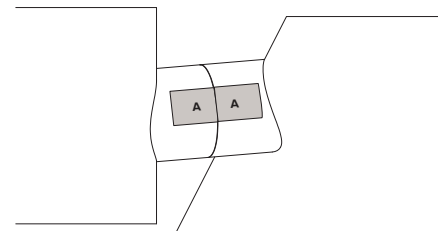

Wear enclosed gloves when handling
lamp, particularly the globe.
Use 90% alcohol to clean globes.

2

Hold arms tightly together
while tightening set screw

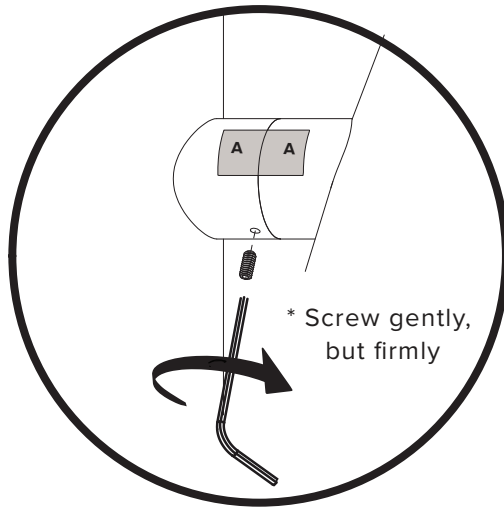

3

Carefully rotate the connected
larger arm into this position so that
the **B** junctions are close.

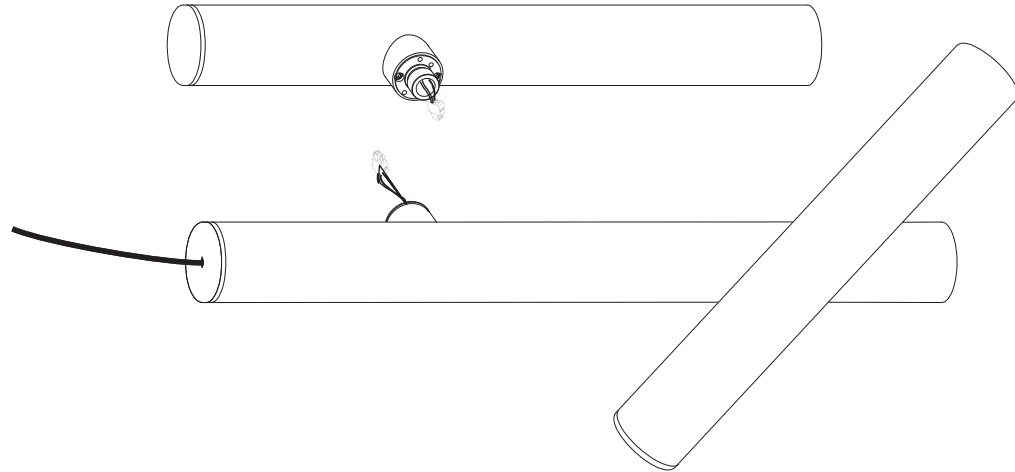

4

Follow steps 1 and 2
for the third arm while aligning
the **B** tape

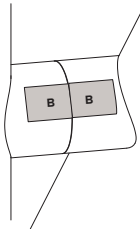

5

Retighten first set screw
to ensure that it has not loosened
while installing third arm.
Recheck second set screw.

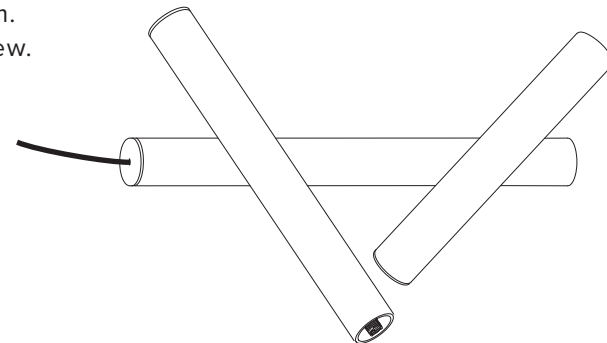

6

Install ceiling anchors

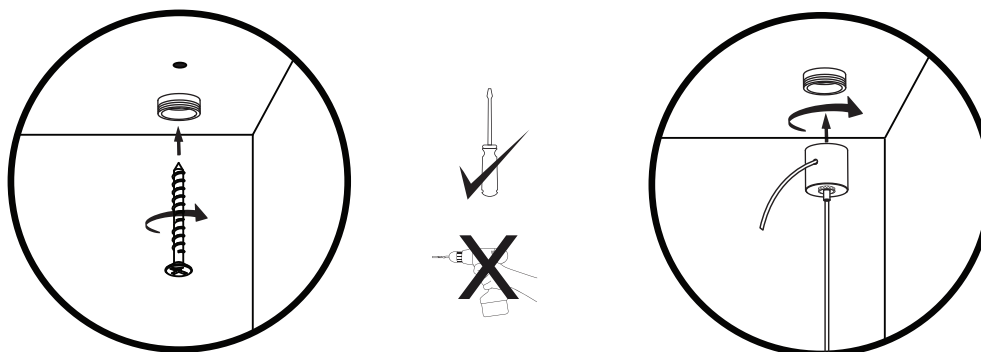

USE APPROPRIATE ANCHORS



Note that the placement of your canopy in relation to the anchor will affect the direction of your luminaire

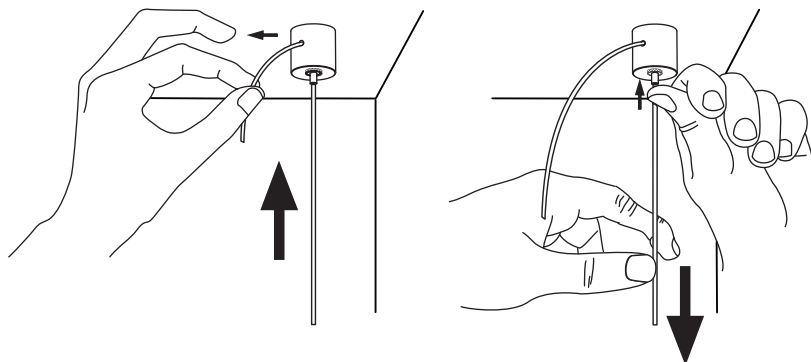
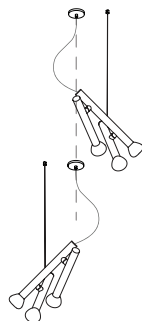

7

Secure the cable gripper then trim extra cable when desired level and height (X) are achieved

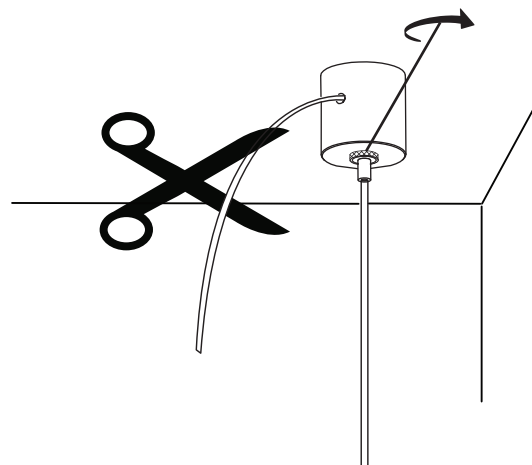
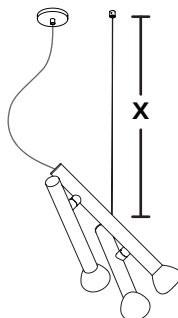

3

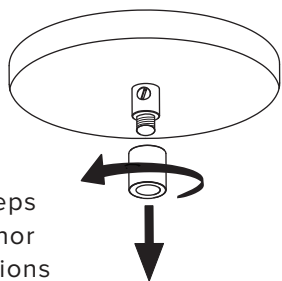

The following steps are for both anchor and no anchor options

4

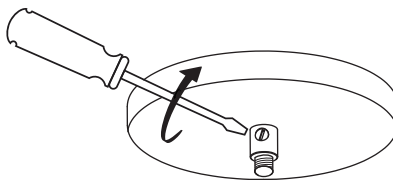

5

Feed cord through then adjust cord length. Leave at least 8" / 20.3 cm of cord after the bracket.

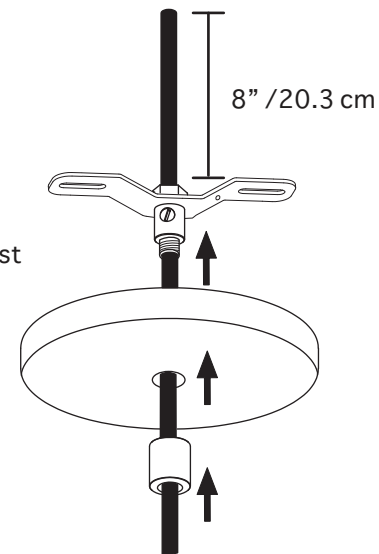

6

MAKE MAIN/LINE VOLTAGE CONNECTIONS

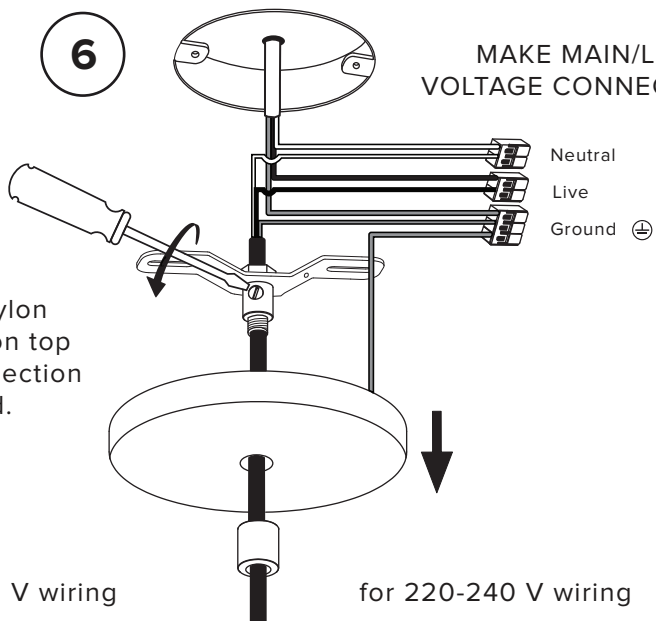

Tighten nylon set screw on top of sleeved section of cord.

for 120 V wiring

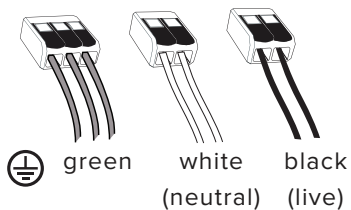

for 220-240 V wiring

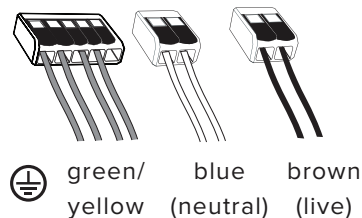

7

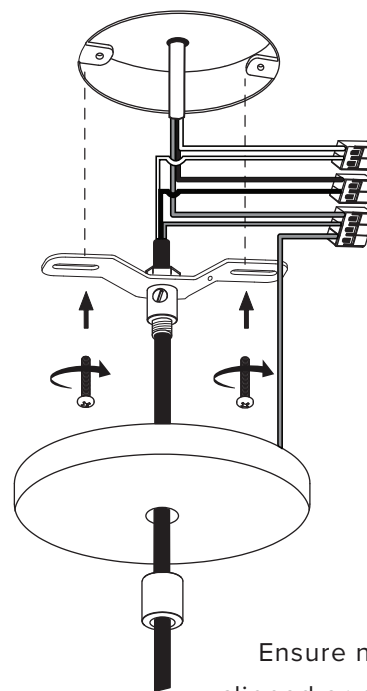

Ensure no wires are clipped or pinched during this operation.

8

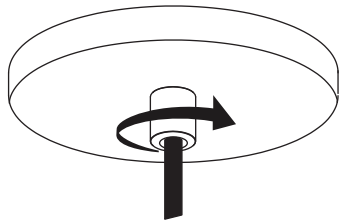
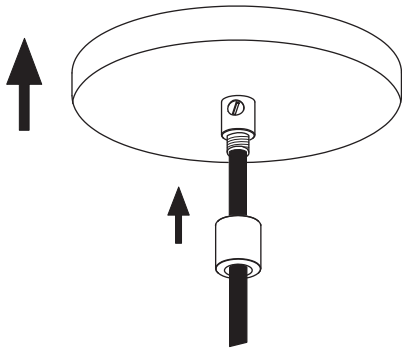

9

Insert bulb and globe.



Wear enclosed gloves
when handling luminaire,
particularly the globe.

To clean the globe, ensure
the luminaire is disconnected
from supply, then use 90% alcohol
to clean it.

