

LAURENT ATELIER

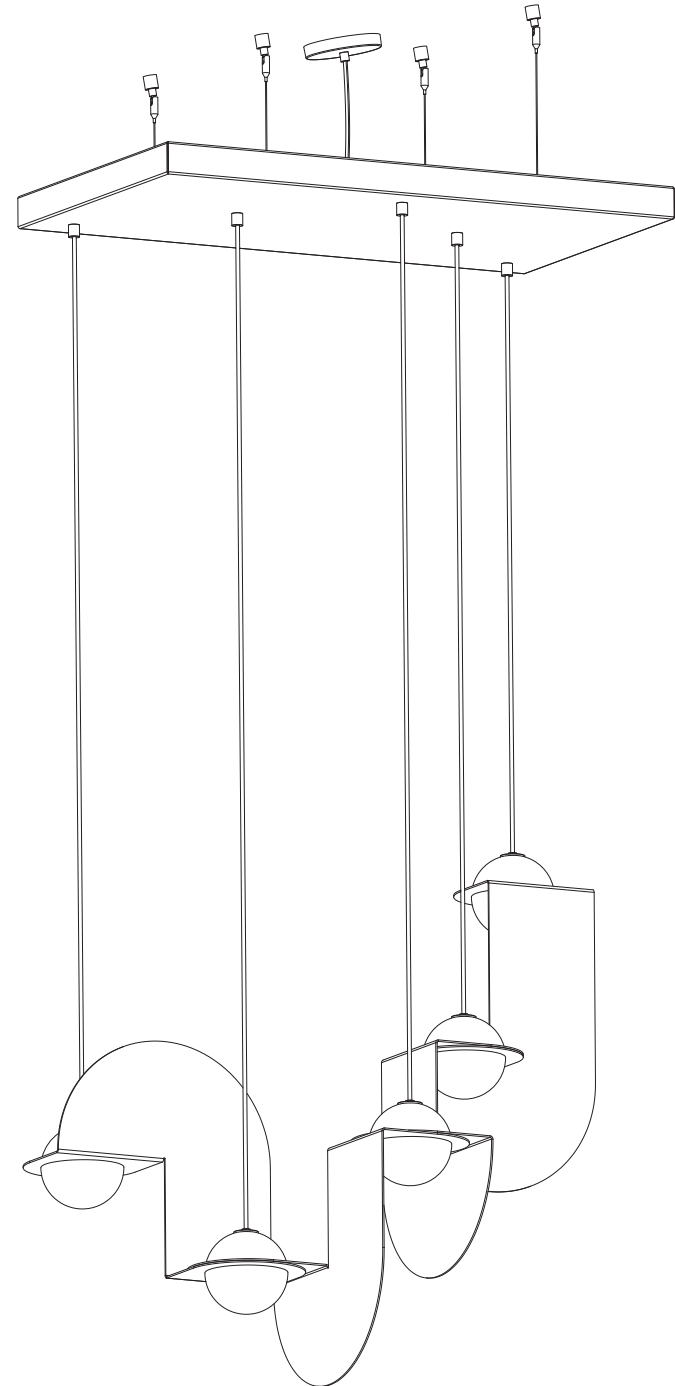

- Please read entire manual before beginning install
- To be installed by an electrician to an electrical box
- Use appropriate screws where necessary
- Wear enclosed gloves when handling lamp
- Handle materials with care. Please consult lamp maintenance sheet on our web site
- Should be used exclusively as a lamp and not as a shelving, display or hanging unit



CEILING MOUNTING POINTS

1

Mark anchor locations
using electrical box and
canopy as a guide.

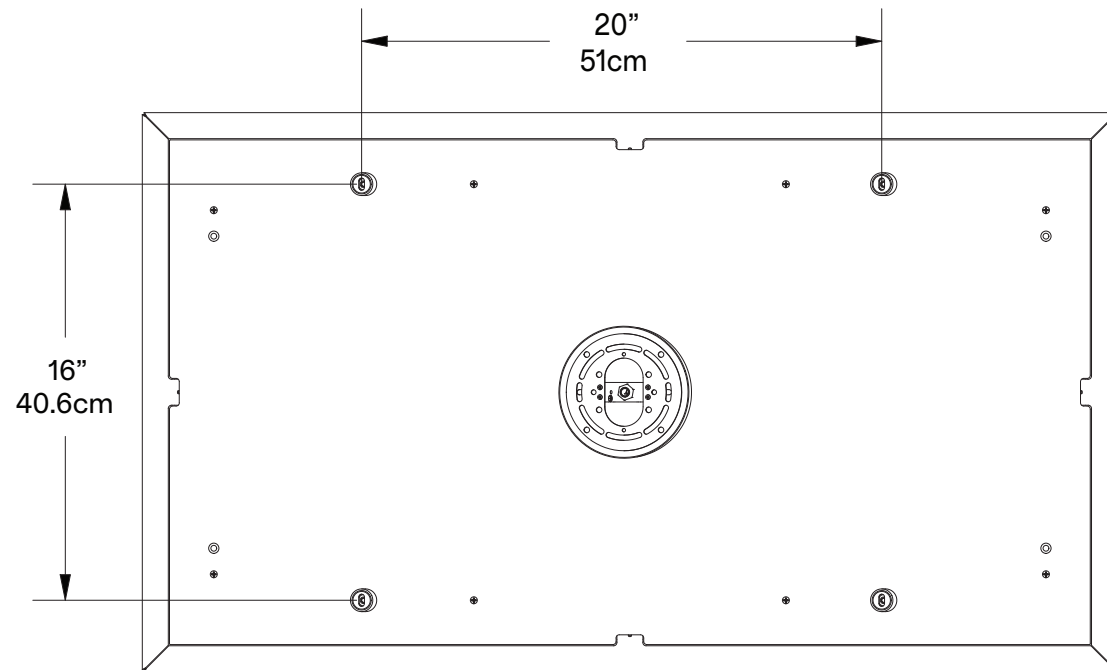



Only for ceilings
slanted **45°** or less

2

Install ceiling anchors then
screw the gripper onto it.

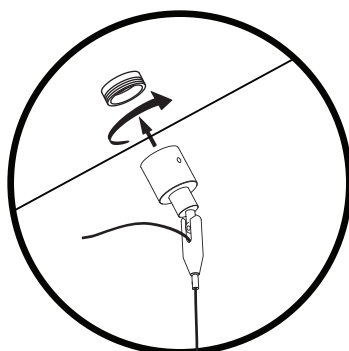
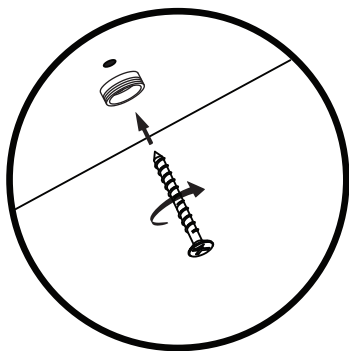

USE APPROPRIATE ANCHORS

3

To raise your luminaire pull on cable.

To lower luminaire push up on plunger
while holding the cable, then pull downwards.

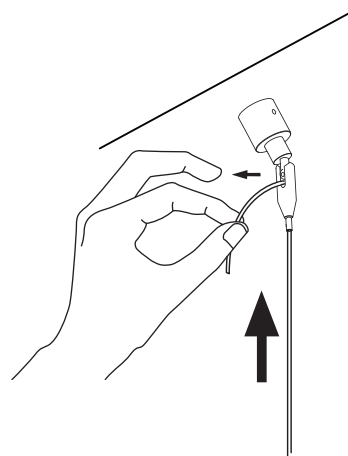

UP

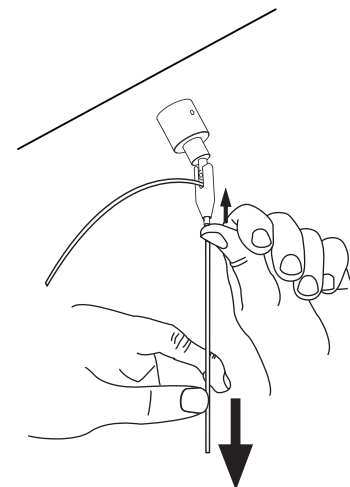

DOWN

4

Trim excess cable
only after final height
and level are reached.

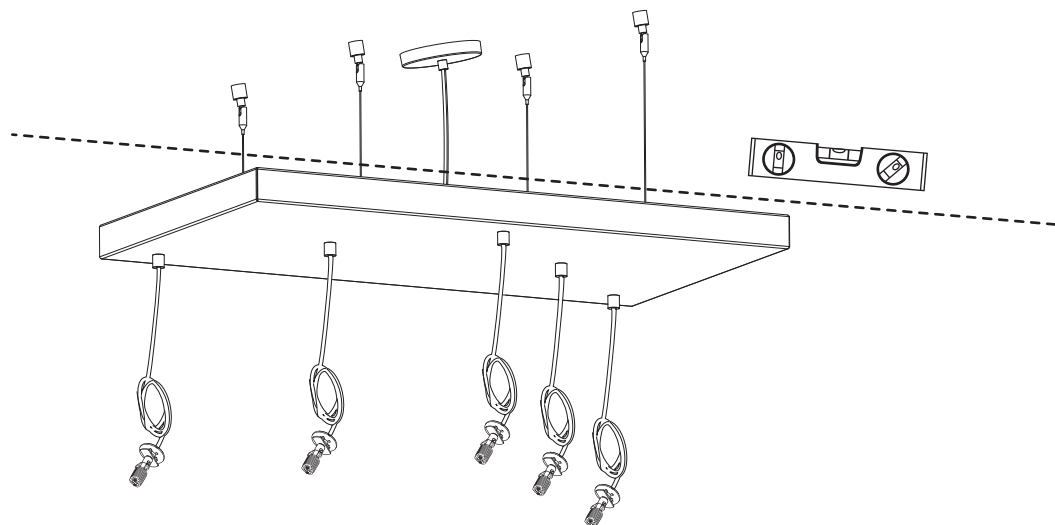
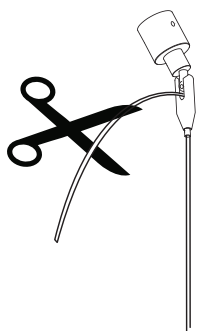

5

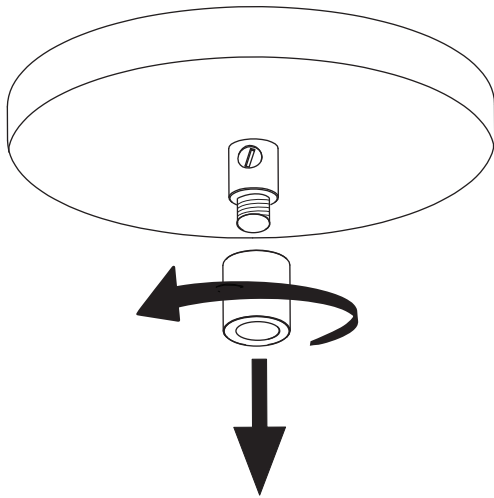

6

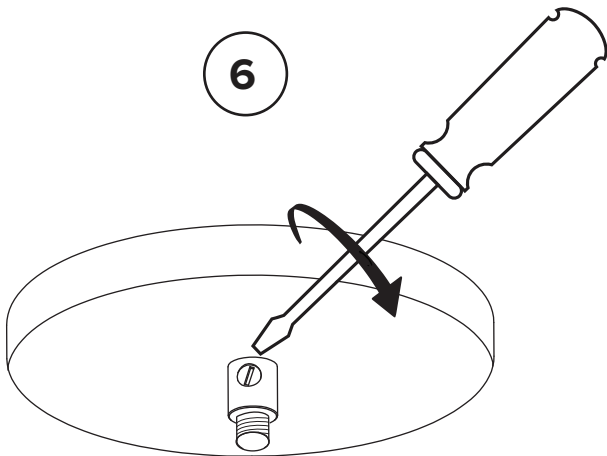

7

Feed cord through then adjust cord length. Leave 8" / 20.3 cm of cord after the bracket.

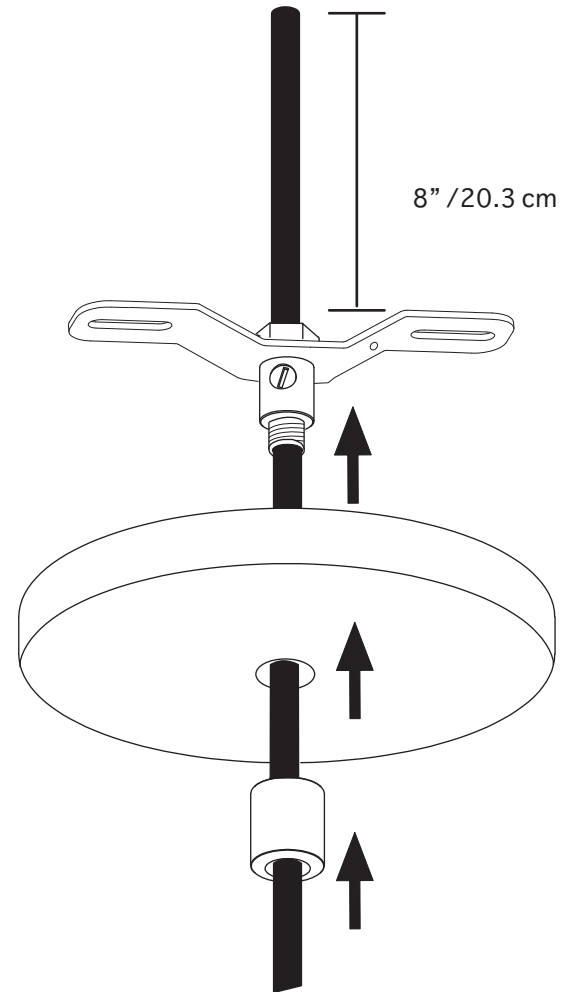

8

MAKE MAIN /LINE
VOLTAGE CONNECTIONS

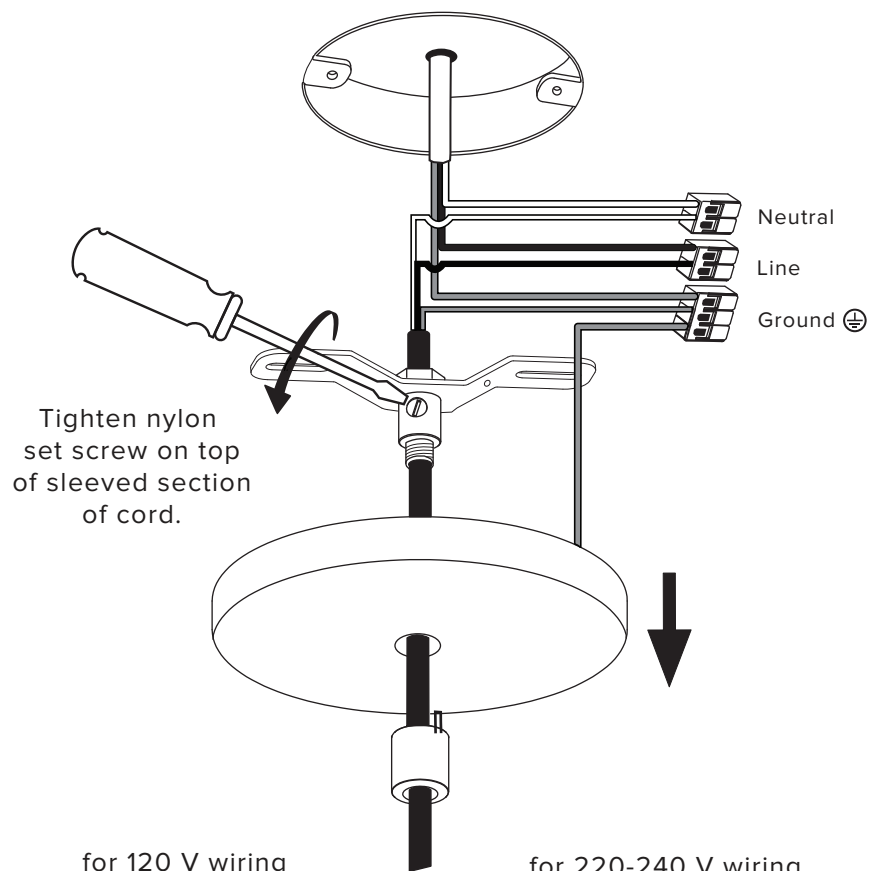

for 120 V wiring

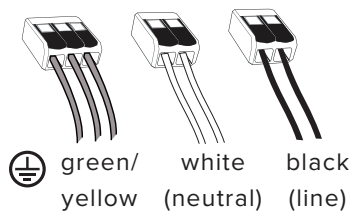

for 220-240 V wiring

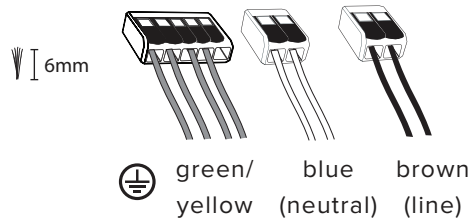

9

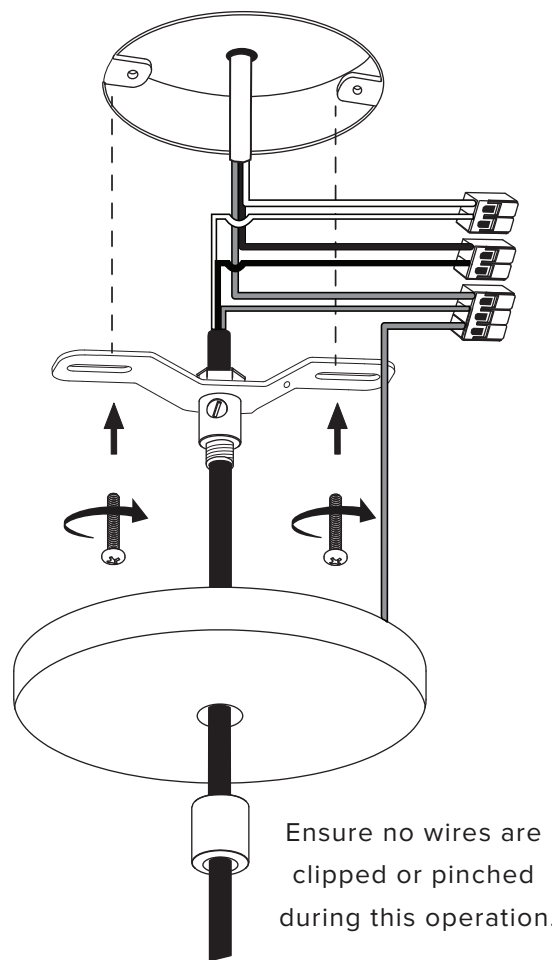

10

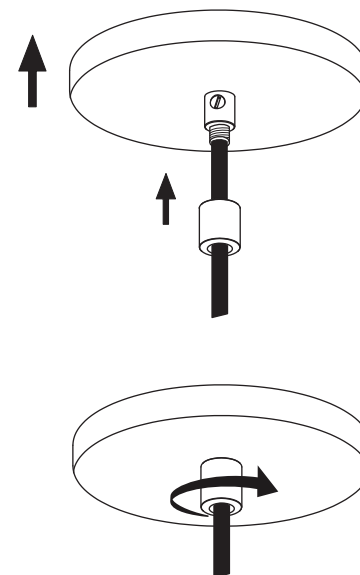

11

The globes and shades need to be installed in order as presented.
There are aluminium and steel shades that need to be layered correctly.

The shades are clearly labeled.

After each step (1 to 5) screw on the globes by following the steps on next page.

1. Pass wire for globe **1** trough shade **A**
2. Pass wire for globe **2** trough shade **B**, then **A**
3. Pass wire for globe **3** trough shade **C**, then **B**
4. Pass wire for globe **4** trough shade **C**, then **D**
5. Pass wire for globe **5** trough shade **D**

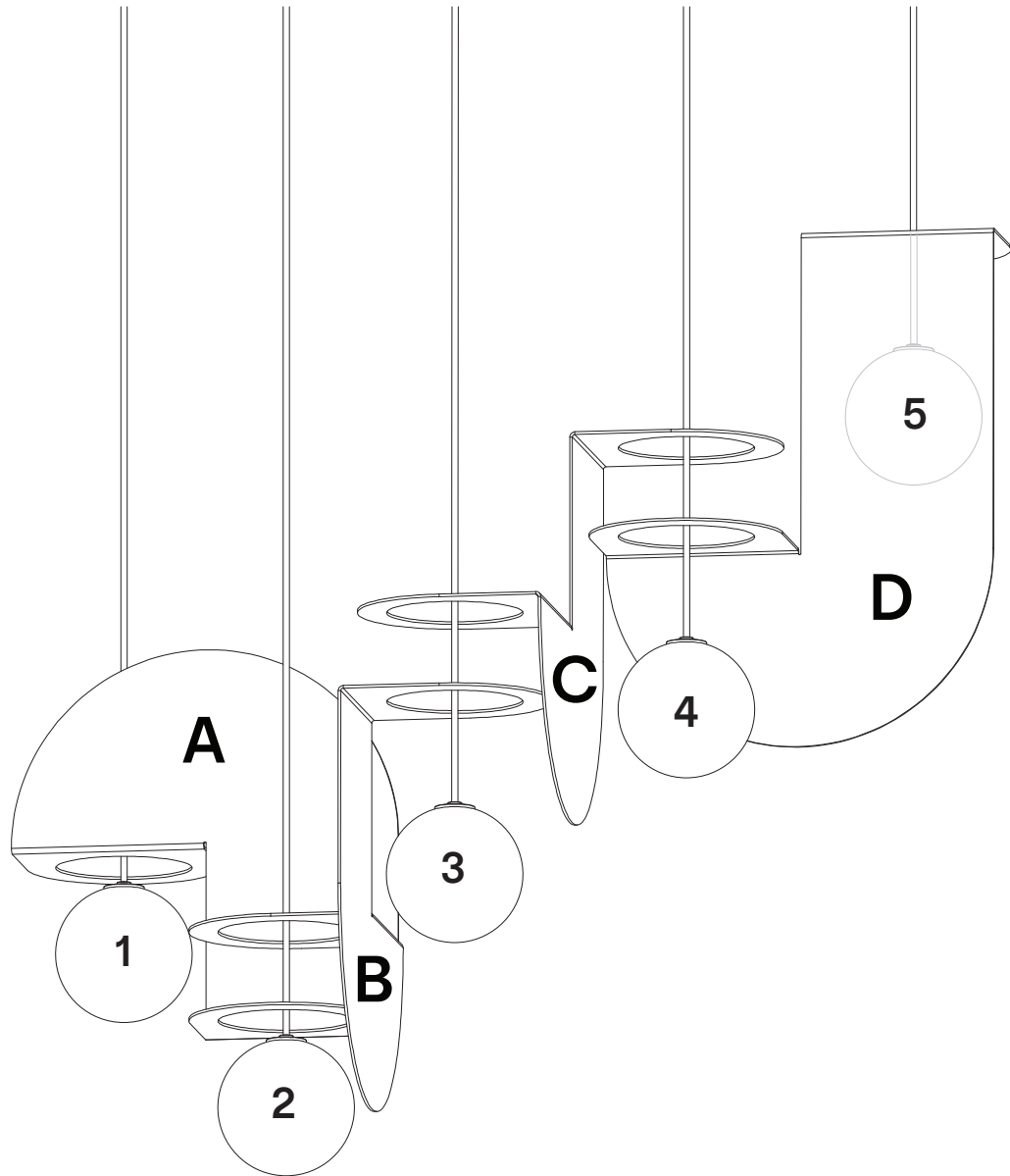

12

Place the wire through the shade then unthread the top cap counter-clockwise.

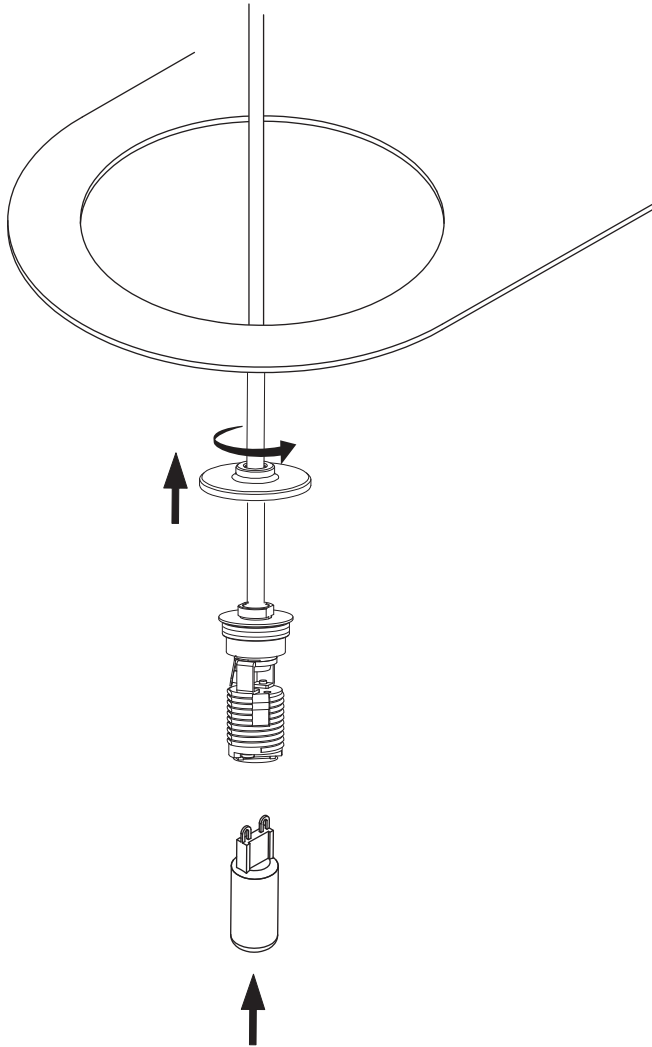

13

Screw the globe to the assembled light source.

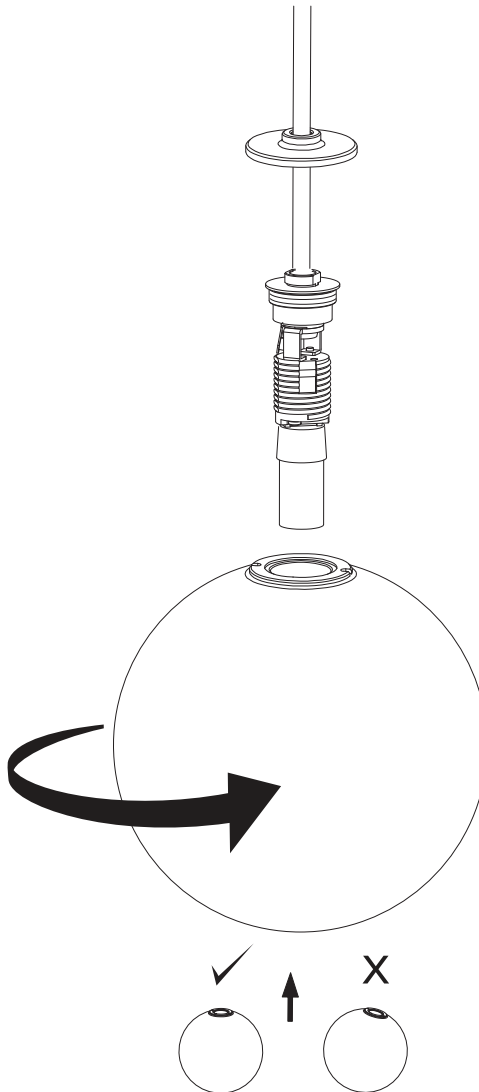

14

Screw the cap on the globe.

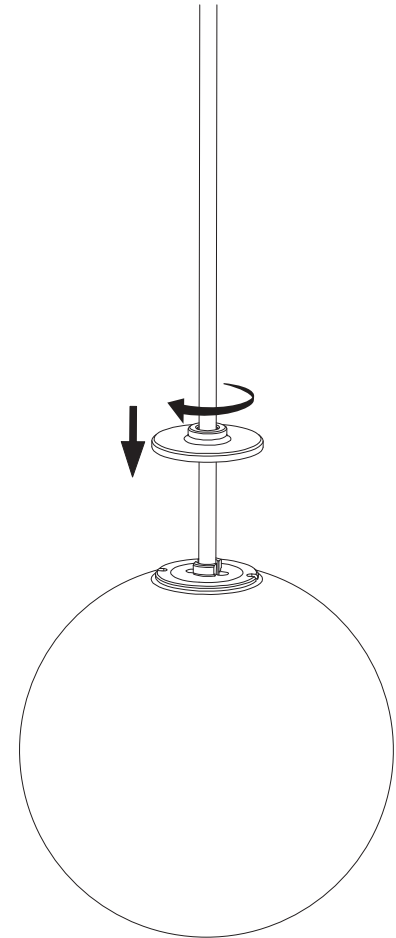

15

Make sure the luminaire is level and balanced.

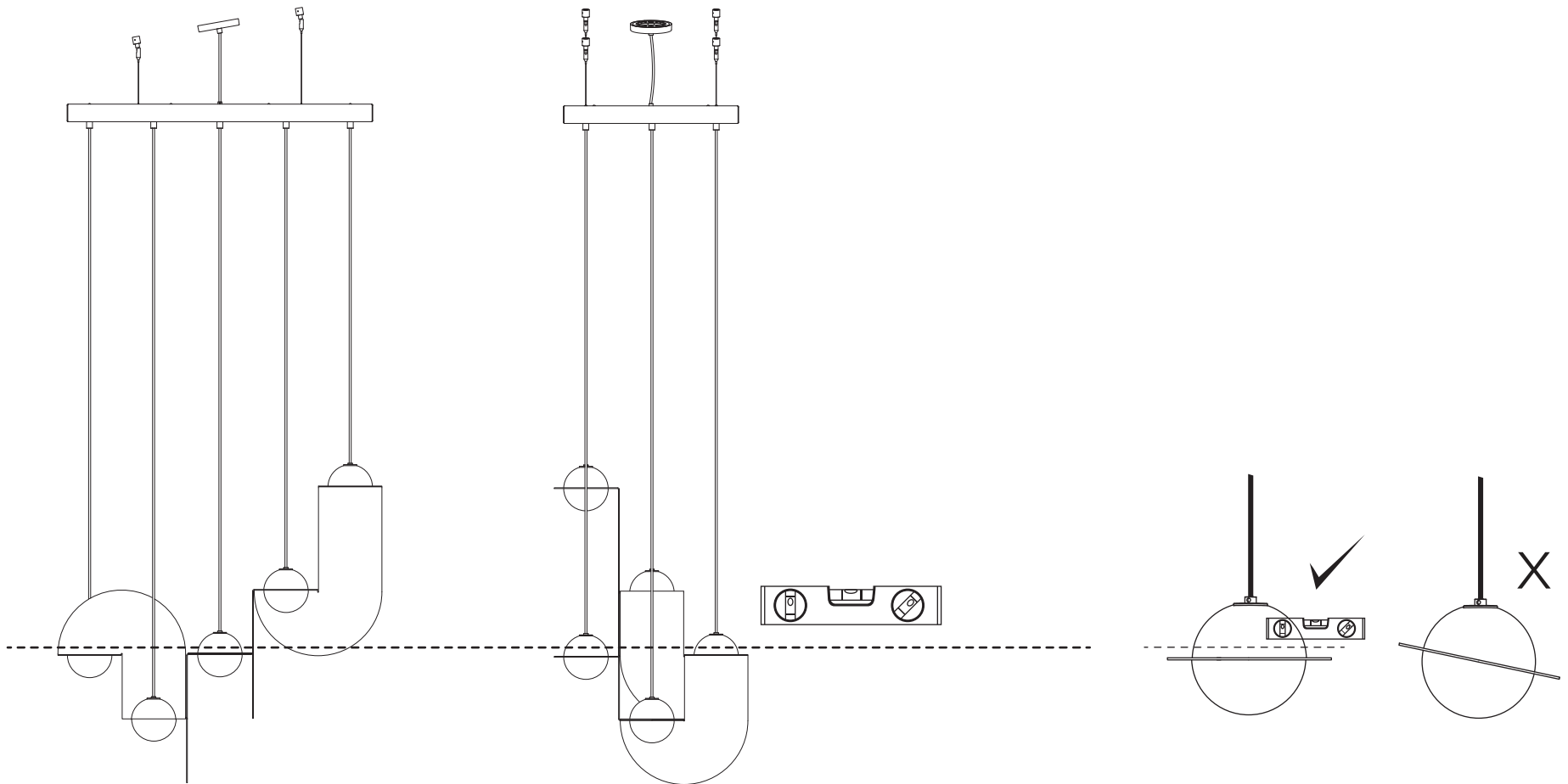

16

If micro adjustments to wire length are needed, open canopy cover by rotating the 5 caps.

The lower part of the canopy is temporarily held in place with stainless steel cables to facilitate adjustments.

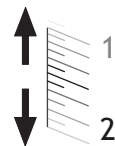

Micro-adjustments cannot exceed 1" / 2.5cm up or down.

SCREW GENTLY BUT FIRMLY

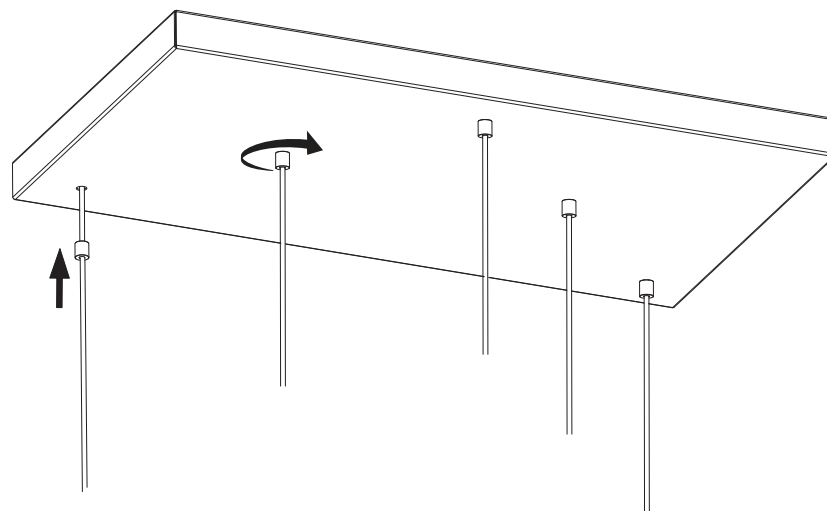
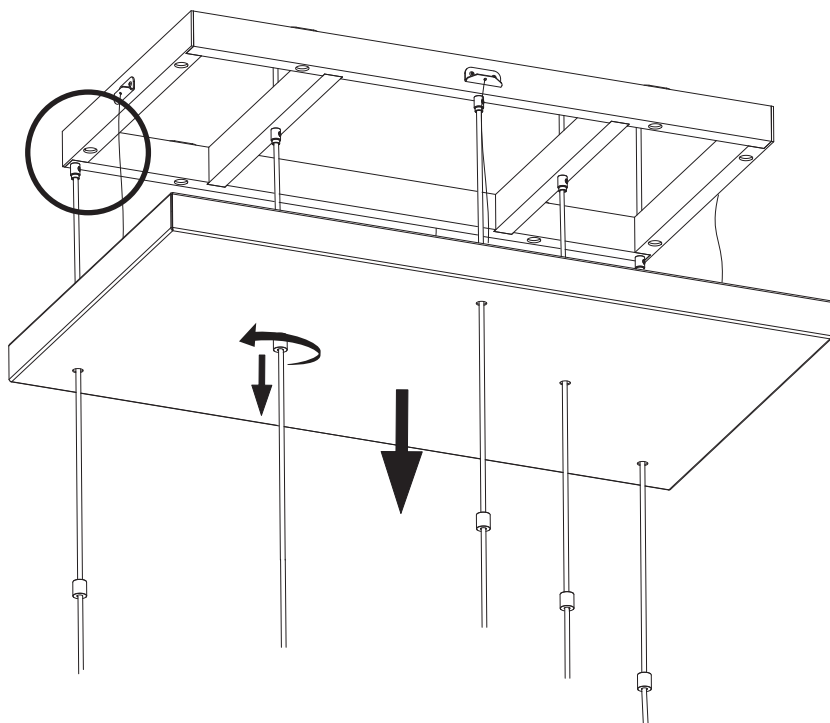
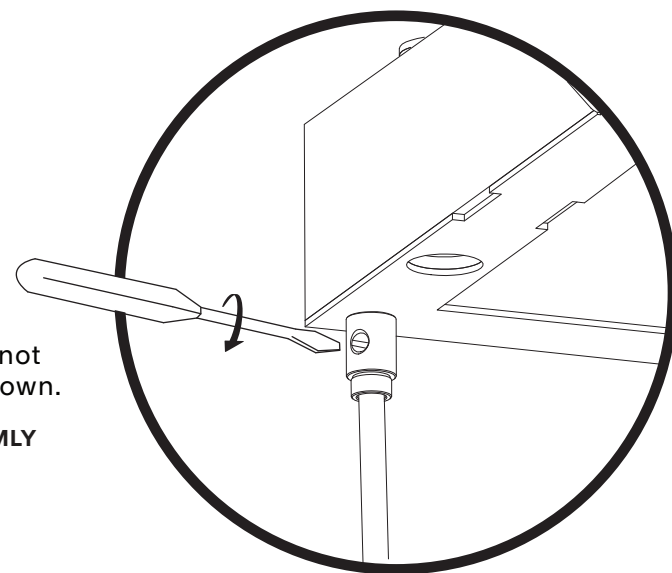

When adjustments are complete, raise the canopy cover and secure it in place by screwing the caps back into place.

Make sure the stainless steel cable is tucked inside of the canopy cover when raising it.