

BEAUBIEN SUSPENSION

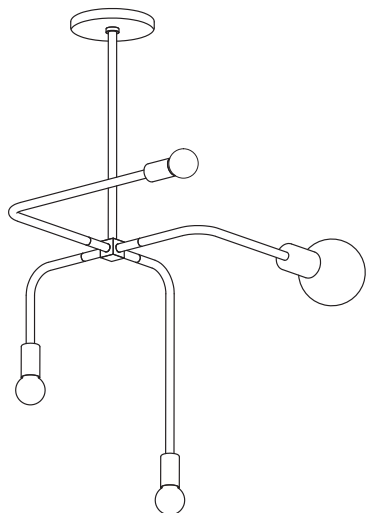

1 x



1 x



3 x

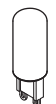

3.5W

3 x



1 x



4.5W

1 x

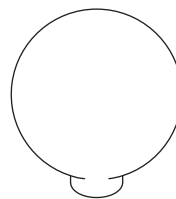

2 x



1 x



- 
- To be installed by an electrician to an electrical box
 - Use appropriate screws and anchors where necessary
 - Wear enclosed gloves when handling lamp
 - Handle materials with care. Please consult lamp maintenance sheet on our web site

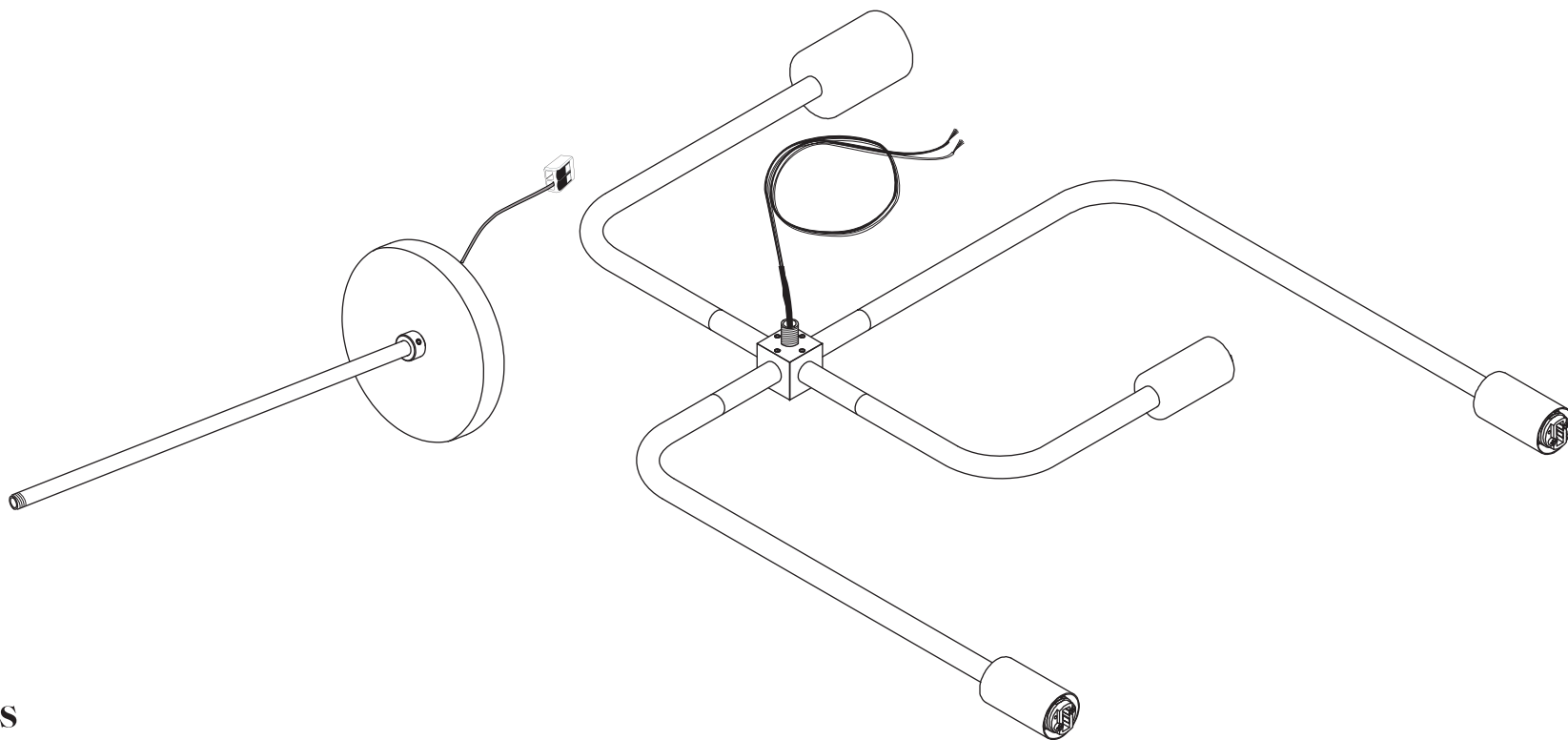

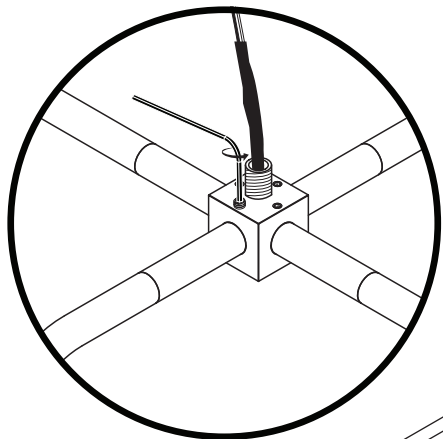

* Screw gently, but firmly

1

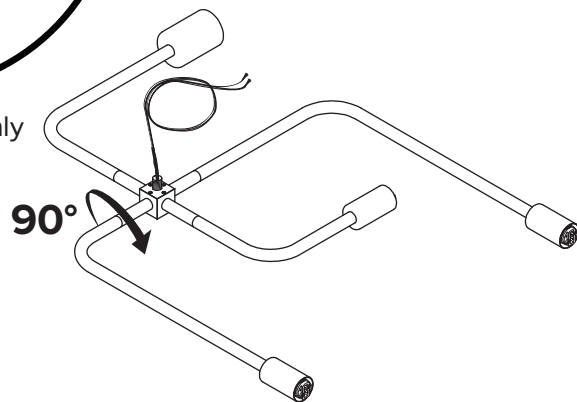

2

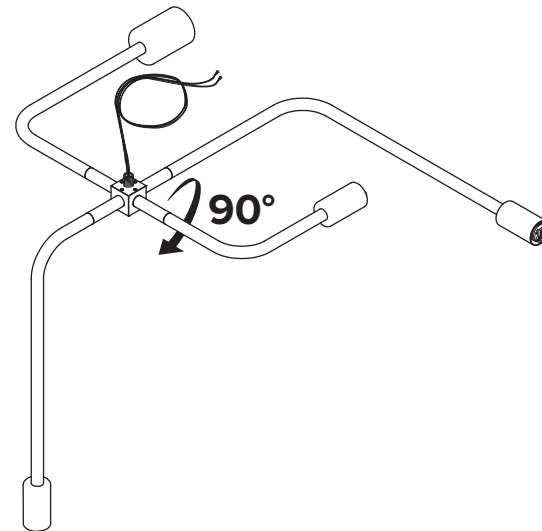

3

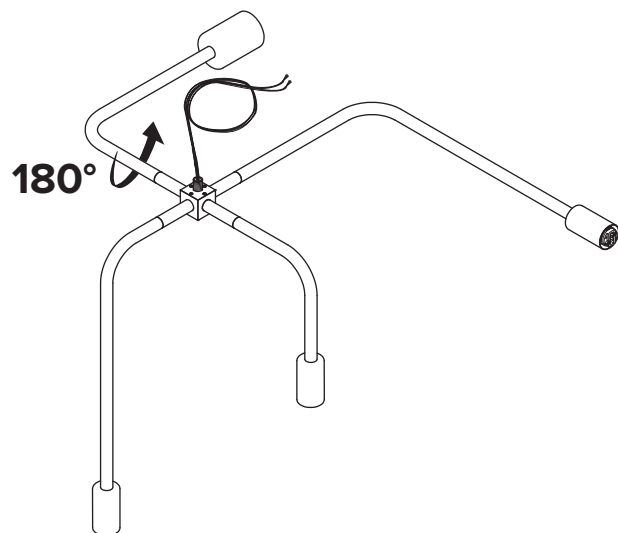

4

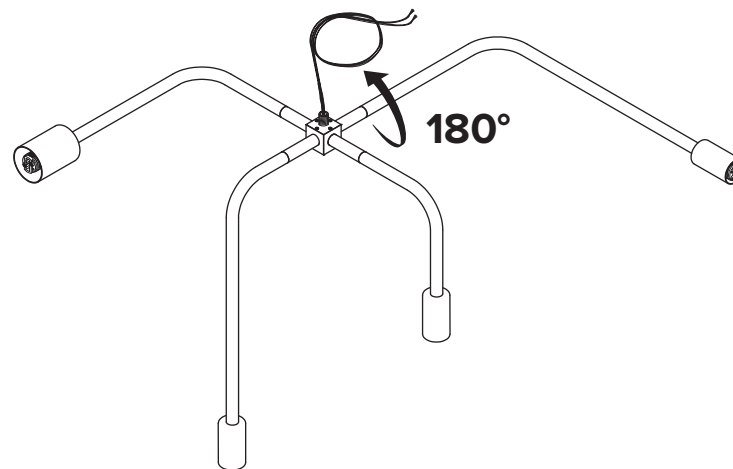

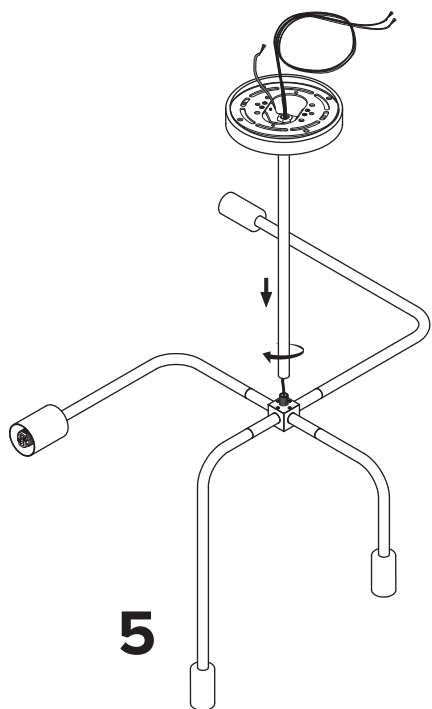

5

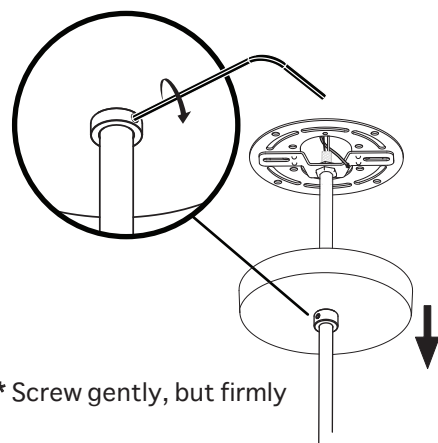

* Screw gently, but firmly

6

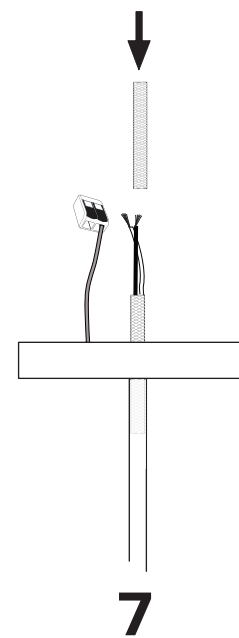

7

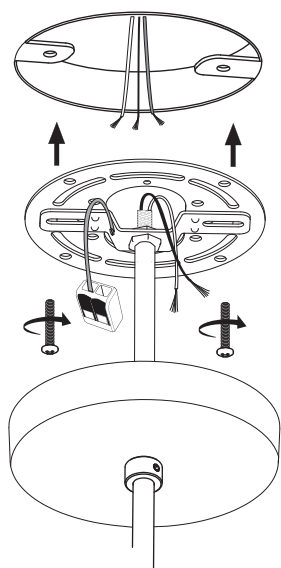

8

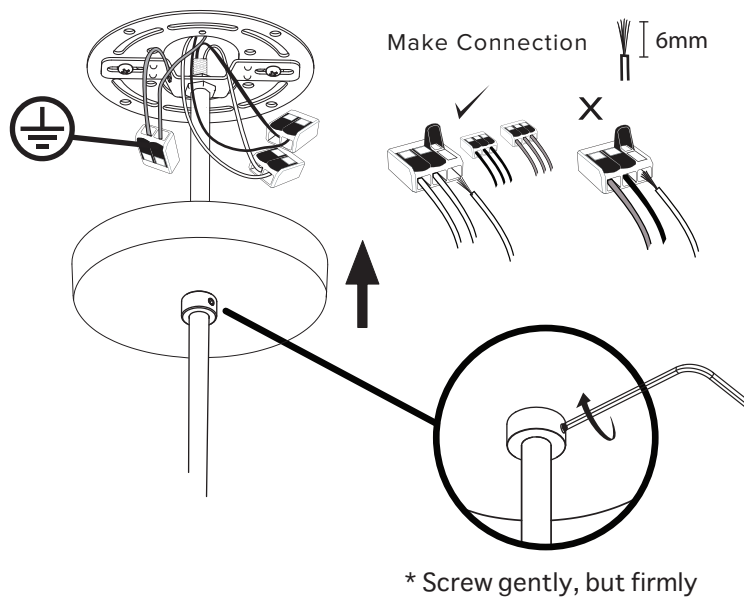

Make Connection

6mm

* Screw gently, but firmly

9

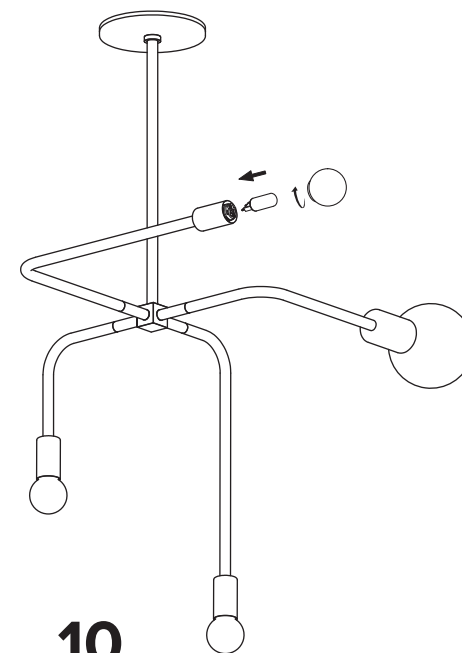

10