







## PARC 04

Parc is a collection inspired by childhood imagination and the essentiality of homemade forms — created in collaboration with Swiss designer Adrien Rovero. Evoking the archetype of a flashlight, each lamp of the Parc Collection is a playful reminder of time spent in nature, when a simple tube and piece of string could be used to fashion any number of creations. These makeshift things, at once naive and functional, harness the unique beauty of peeling an object back to its essence.

<b>type:</b>	pendant
<b>construction:</b>	hand blown frosted glass powder coated aluminum body polyester cord
<b>specifications:</b>	source: LED lamp provided (G9 base) power consumption: 3x 4,5W lumen output: 957lm colour temperature: 2700K included *3000K available upon request colour rendering index: 80 CRI standard * ≥ 90 CRI upon request expected lifetime: 25 000h
<b>control:</b>	refer to our recommended list of dimmer models
<b>cord length:</b>	108" / 274 cm
<b>stainless steel cable:</b>	96" / 244 cm
<b>weight:</b>	3.5lb / 1.6kg
<b>certifications:</b>	    IP20
<b>warranty:</b>	2 years

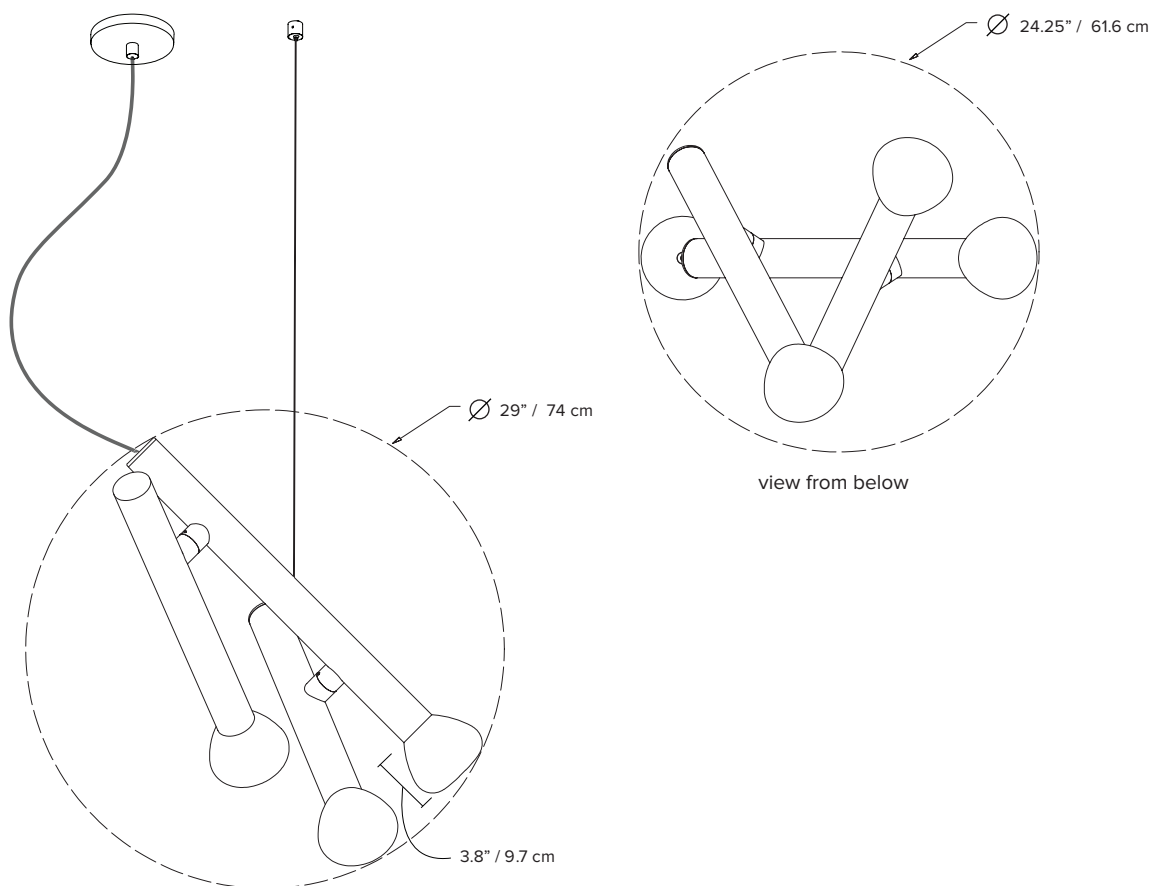

\*dimensions are approximate and may vary slightly

## ORDER GUIDE: SKU

<u>COLLECTION</u>	<u>MODEL</u>	<u>BODY</u>	<u>CORD</u>	<u>CANOPY AND ANCHOR</u>
<b>PRC</b> parc	<b>04</b>	<b>BK</b> black	<b>BK</b> black	<b>BK</b> black
		<b>MB</b> midnight blue	<b>MB</b> midnight blue	<b>MB</b> midnight blue
		<b>BE</b> blue	<b>BE</b> blue	<b>BE</b> blue
		<b>WH</b> white	<b>WH</b> white	<b>WH</b> white
		<b>BG</b> beige	<b>BG</b> beige	<b>BG</b> beige
		<b>BU</b> burgundy	<b>BU</b> burgundy	<b>BU</b> burgundy
		<b>GN</b> green	<b>GN</b> green	<b>GN</b> green
		<b>TC</b> terracotta		<b>TC</b> terracotta
<b>PRC</b>	<b>04</b>	<b>BK</b>	<b>BK</b>	<b>BK</b> = <b>PRC04BKBK</b> <b>example</b>

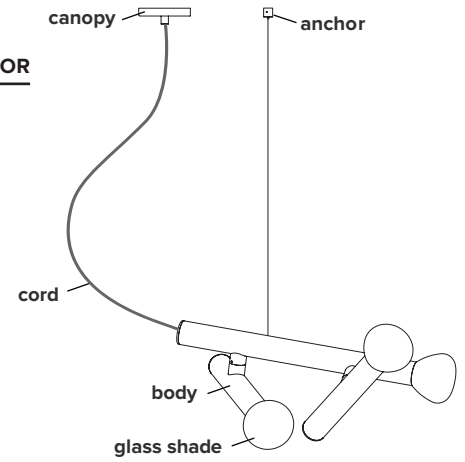

### FINISH

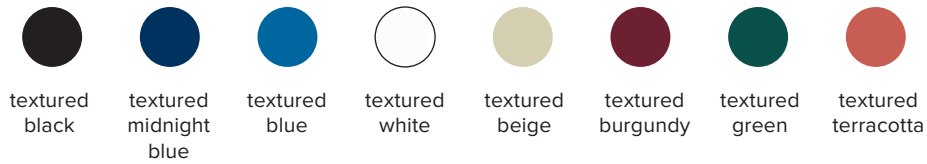

### NOTES:

- must be installed by an electrician
- ceiling anchors not meant for slanted ceilings (available upon request)
- not protected against liquids (refer to IP20)
- additional charges for modifications or for special orders
- please refer to maintenance sheet on website for cleaning instructions

## DIMMER SPECIFICATIONS

### DIMMER LIST COMPATIBILITY FOR G9 LED BULBS – 120V

The dimming technology offering the best results is ELV (electronic low voltage) dimmers with reverse phase or trailing edge control.

DIMMER BRAND	MODEL NUMBER	MIN LEVEL	MAX LEVEL	FLICKERING	OVERALL QUOTE
LUTRON - MAESTRO	MAELV-600	0%	100%	0%-10%	good
LUTRON - SKYLARK	SELV-300P	0%	100%	no	very good
LUTRON - SKYLARK	SELV-303P	0%	100%	no	very good
LUTRON - SKYLARK	CTELV-303P	0%	100%	no	very good
LUTRON - DIVA	DVELV-300P	0%	100%	no	very good
LEGRAND - ADORNE	TRUE UNIVERSAL	30%	100%	no	good

### DIMMER LIST COMPATIBILITY FOR G9 LED BULBS – 230V

DIMMER BRAND	MODEL NUMBER	MIN LEVEL	MAX LEVEL	FLICKERING	OVERALL QUOTE
VARILIGHT	V-PRO	2%	100%	no	very good
LEGRAND - NILOÉ	3 996 35	15%	87%	no	good
NIKO	310-0280X	5%	94%	no	very good
NIKO	310-0190X	1%	100%	no	very good

\*Other dimmers can yield good results and we recommend conducting your own test before final installation.

## EU ENERGY LABEL

