

## HUTCHISON

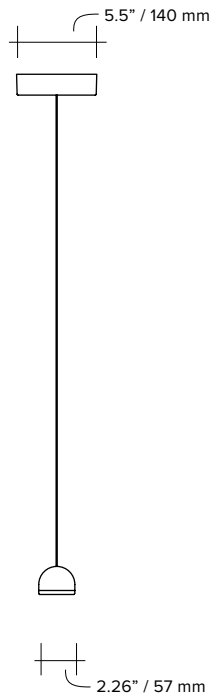

- type:** suspension
- materials:** body: powder coated aluminum  
lens: PMMA  
hardware: powder coated aluminum  
wire: waxed cotton
- wire length:** 108"
- weight:** 1.7 lb/ 0.8 kg (01), 3.4 lb/ 1.6 kg (02), 5.1 lb/ 2.4 kg (03), 6.8 lb/ 3.2 kg (04)
- light source:** 8W (01), 16W (02), 24W (03), 32W (04)
- voltage:** 120V / 277V
- dimmer:** refer to our recommended list of dimmer models
- certifications:** 
- notes:**
- must be installed by an electrician
  - additional charges for modifications or for special orders
  - dimensions are approximate and may vary slightly
  - lead time 7 to 9 weeks

## HUTCHISON 01

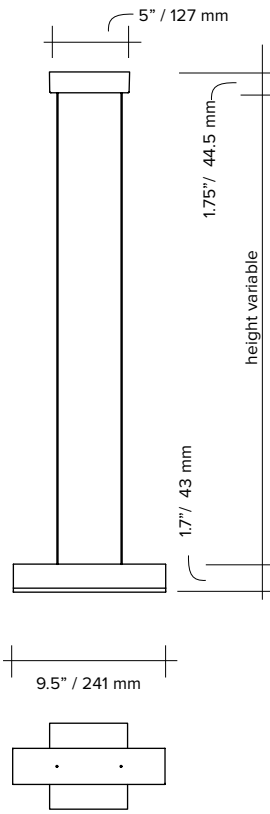

## HUTCHISON 02

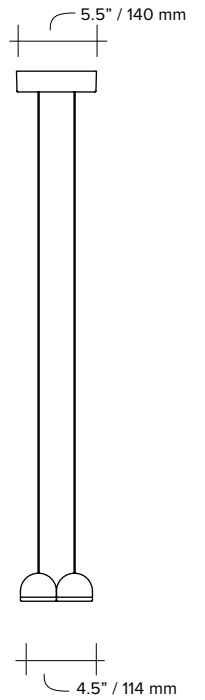
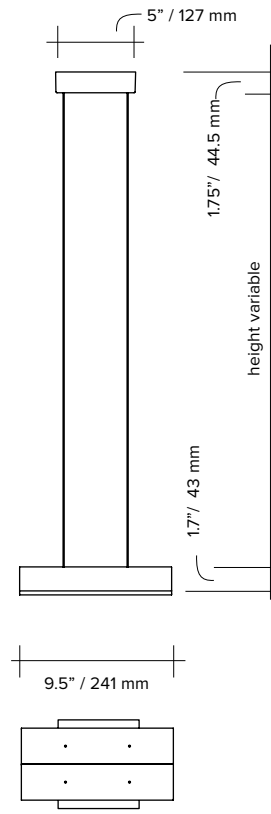

## HUTCHISON 03

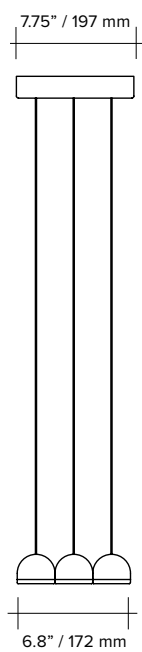
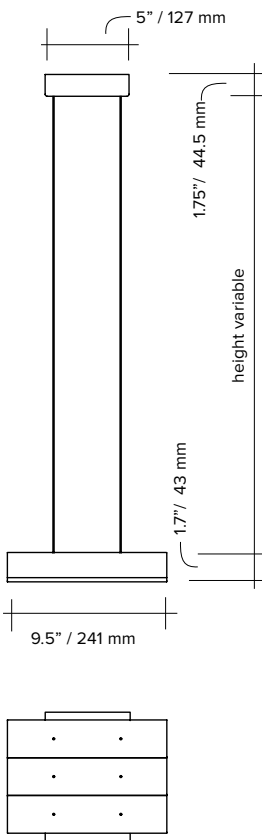

## HUTCHISON 04

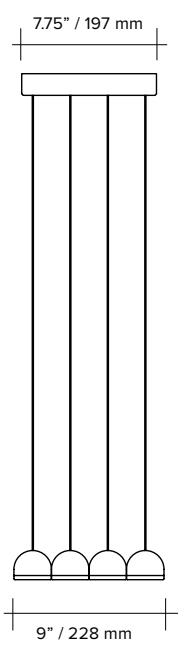
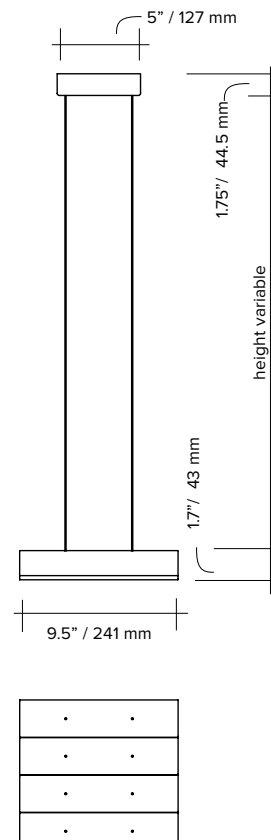

## ORDER GUIDE: SKU

COLLECTION	MODEL	BODY	WIRE	CANOPY
HUT hutchison	01	BL black	BL black	BL black
	02	WH white	WH white	WH white
	03	TC terracotta		TC terracotta
	04	AL aluminum		AL aluminum
HUT	01	BL	BL	BL = HUT01BLBLBL <i>example</i>

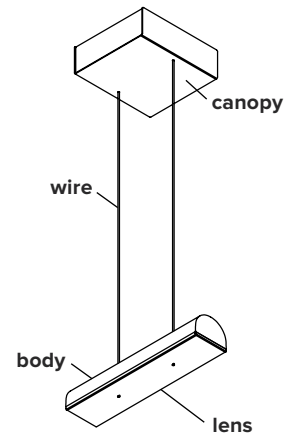

### COLOUR (body)

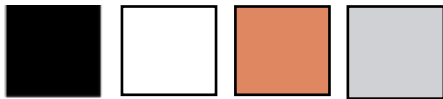

textured black    textured white    flat terracotta    polished aluminum

### COLOUR (wire)



black    white

### COLOUR (canopy)

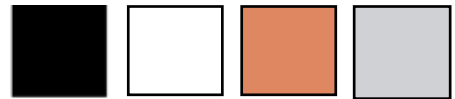

textured black    textured white    flat terracotta    polished aluminum

### CANOPIES

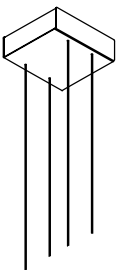

Hutchison 01, 02

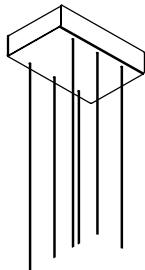

Hutchison 03

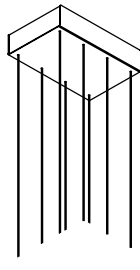

Hutchison 04

## **LIGHT SOURCE & DIMMER SPECIFICATIONS**

### **DC LOW VOLTAGE LED BOARD**

Replacement parts available through Lambert & Fils

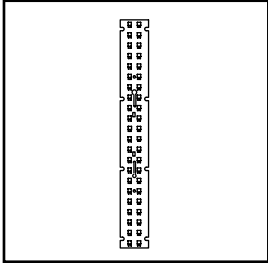

#### **HUTCHISON 01**

8 W  
Driver input 120-277V  
LED board delivered 700 lumen  
LED DIM TO WARM  
50 000 H  
CRI  $\geq 90$   
2 years warranty  
3 SDCM consistency

#### **HUTCHISON 02**

16 W  
Driver input 120-277V  
LED board delivered 1400 lumen  
LED DIM TO WARM  
50 000 H  
CRI  $\geq 90$   
2 years warranty  
3 SDCM consistency

#### **HUTCHISON 03**

24 W  
Driver input 120-277V  
LED board delivered 2100 lumen  
LED DIM TO WARM  
50 000 H  
CRI  $\geq 90$   
2 years warranty  
3 SDCM consistency

#### **HUTCHISON 04**

32 W  
Driver input 120-277V  
LED board delivered 2800 lumen  
LED DIM TO WARM  
50 000 H  
CRI  $\geq 90$   
2 years warranty  
3 SDCM consistency

Replacement parts available through Lambert & Fils