

# CLARK SUSPENSION

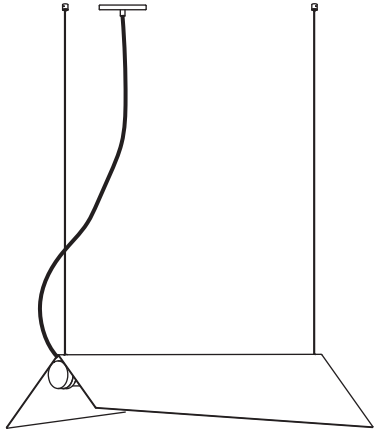

1 x  2 x 

- To be installed by an electrician to an electrical box
- Use appropriate screws and anchors where necessary
- Wear enclosed gloves when handling lamp
- Handle materials with care. Please consult lamp maintenance sheet on our web site

lamp weight **30 lbs / 13 kg**

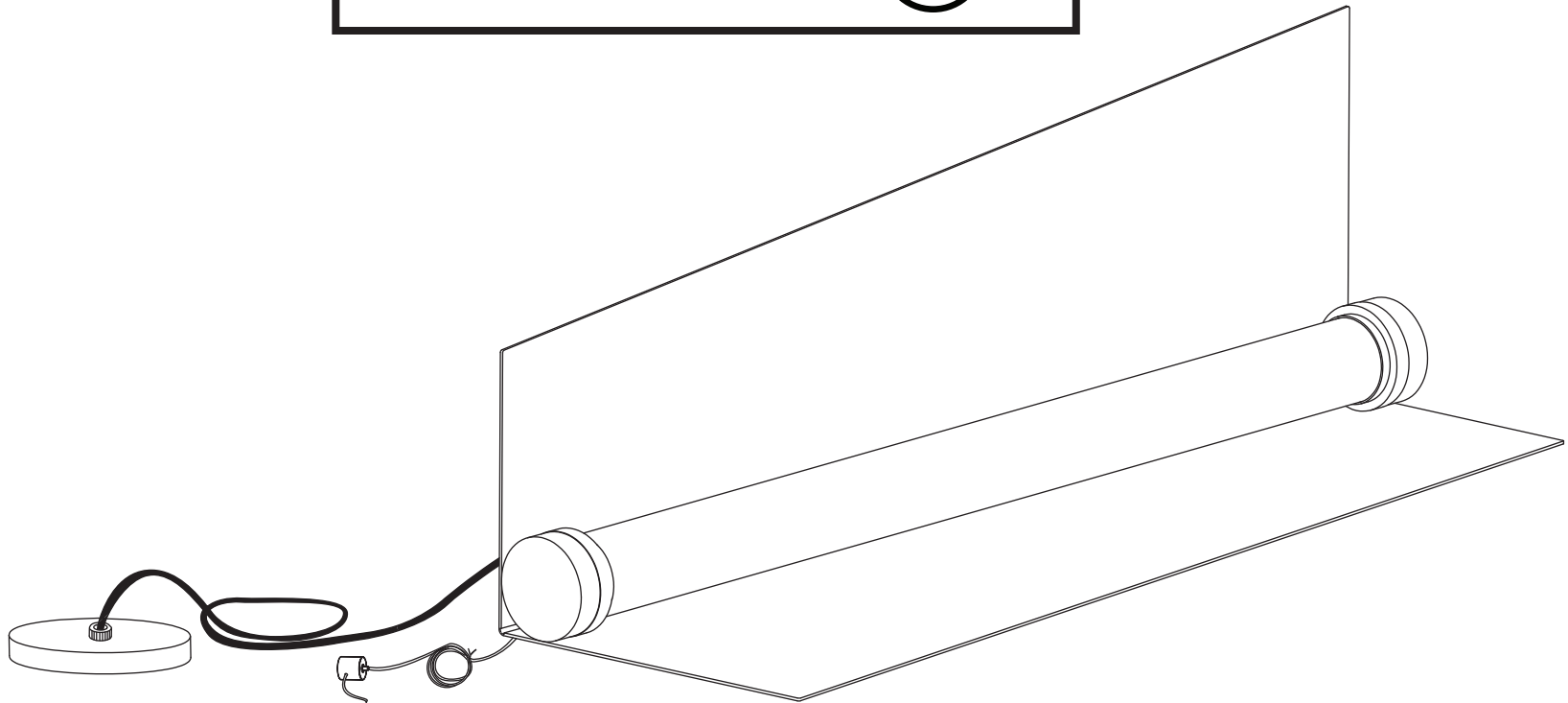

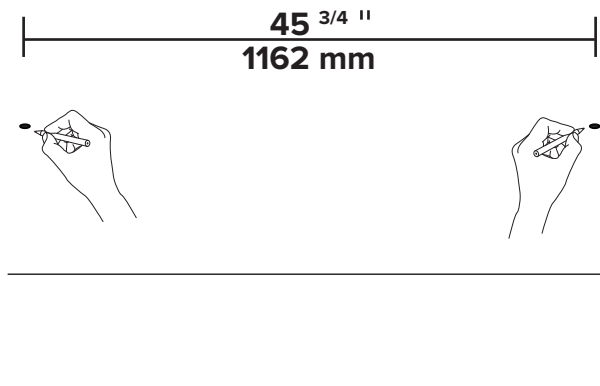

**1**

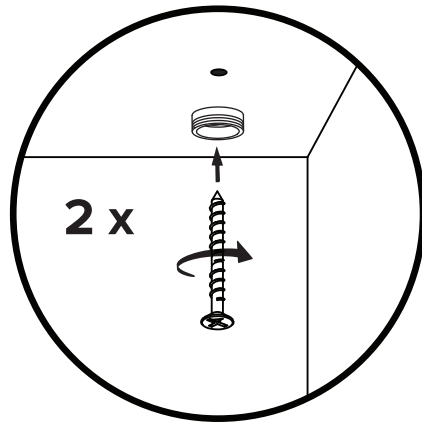

\* Use appropriate anchors

**2**

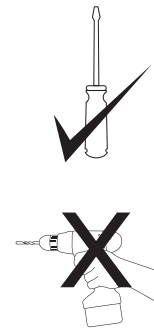

Each anchor must be able to support  
75 lbs / 34 kg

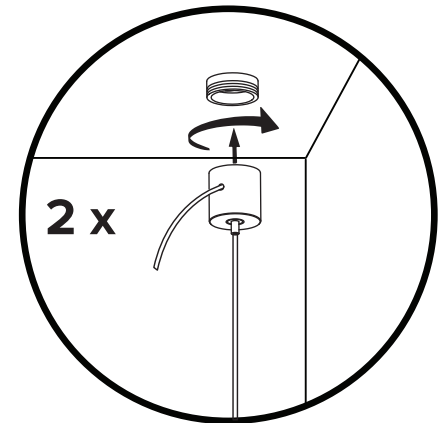

**3**

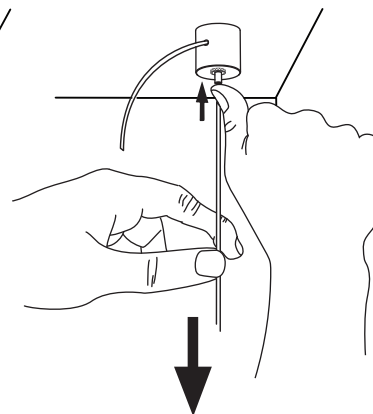
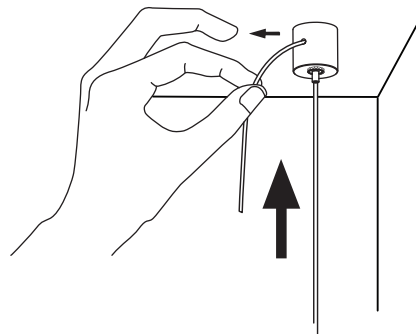
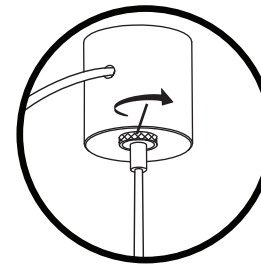
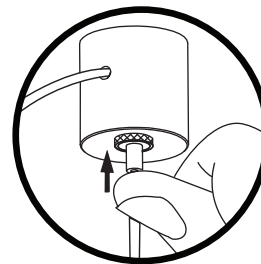
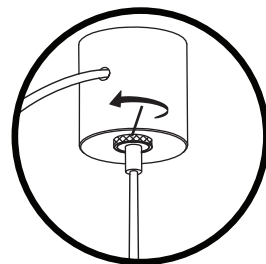
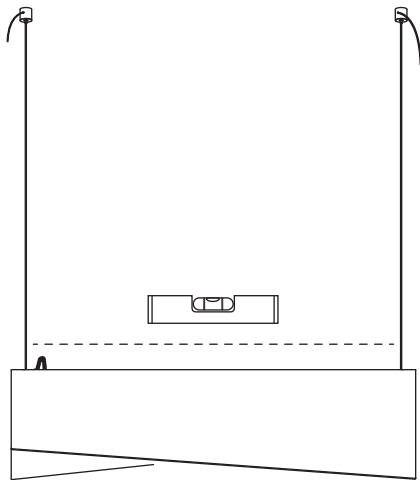

**4**

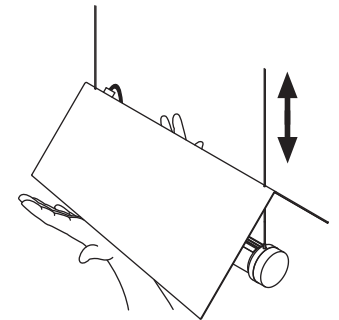

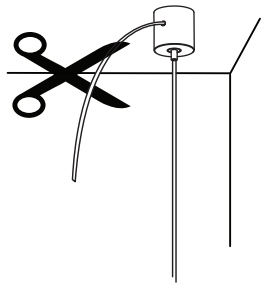

5

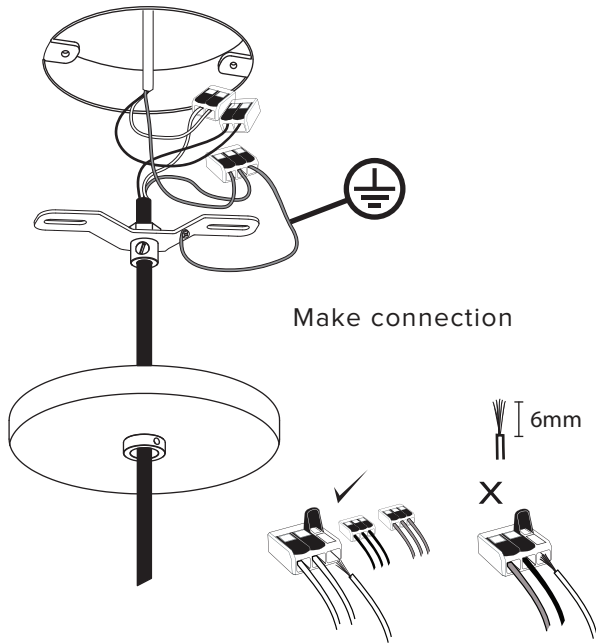

6

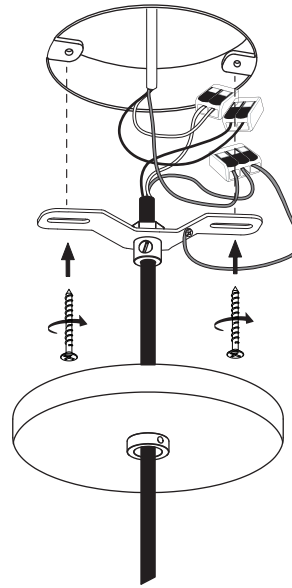

7

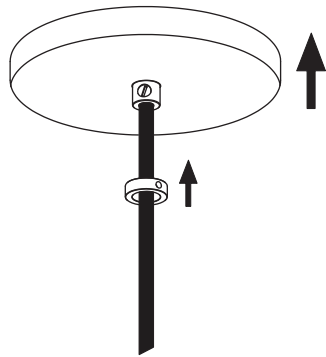

8

\* Screw gently, but firmly

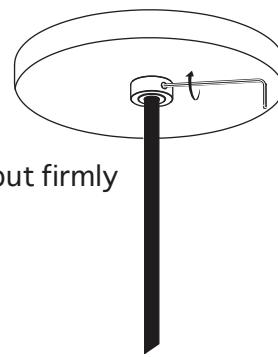

9

