

LAURENT 07

1 x  3 x 

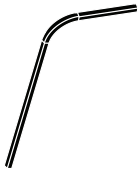

- To be installed by an electrician to an electrical box
- Use appropriate screws and anchors where necessary
- Wear enclosed gloves when handling lamp
- Handle materials with care. Please consult lamp maintenance sheet on our web site
- Should be used exclusively as a lamp and not as a shelving, display or hanging unit

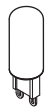
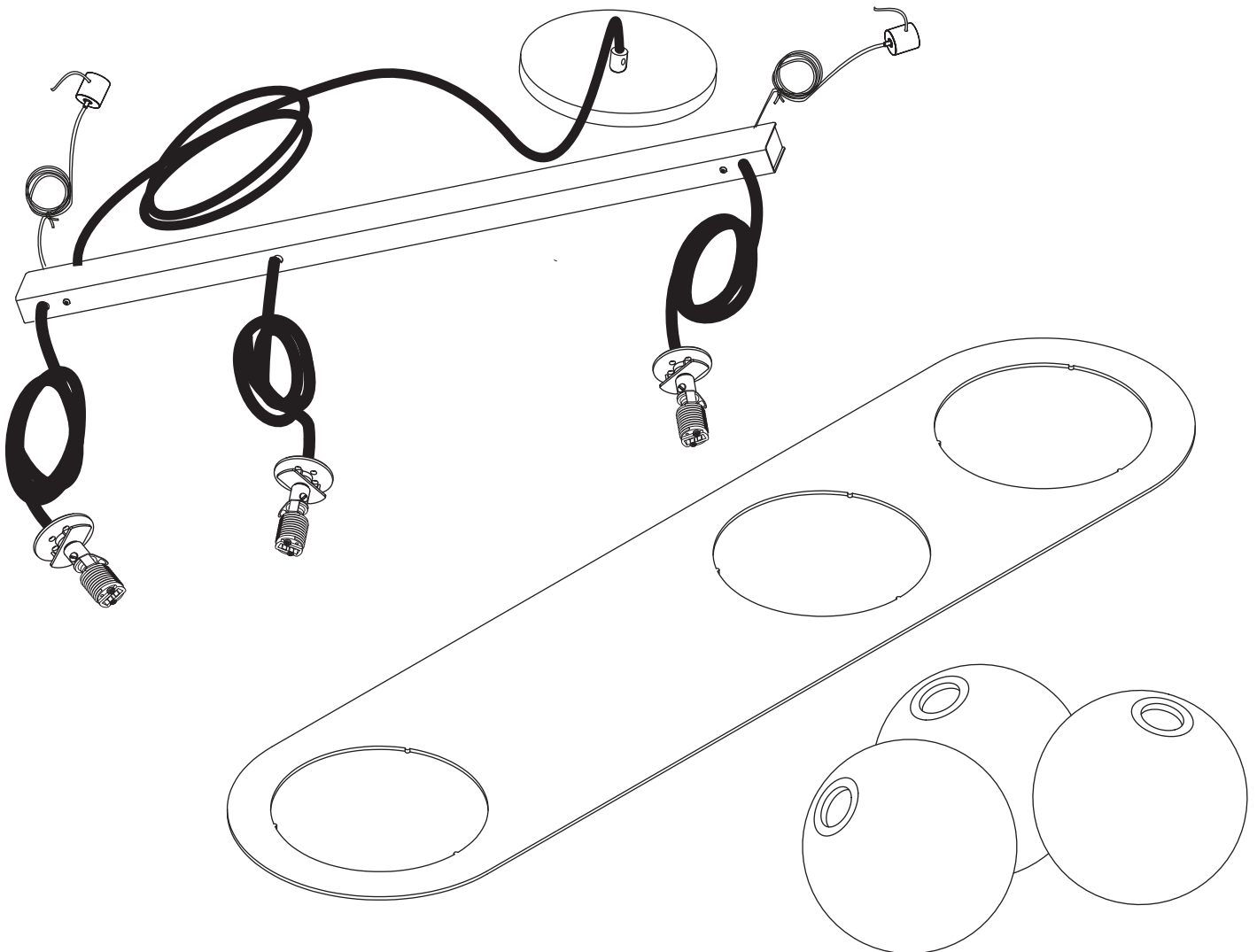

1

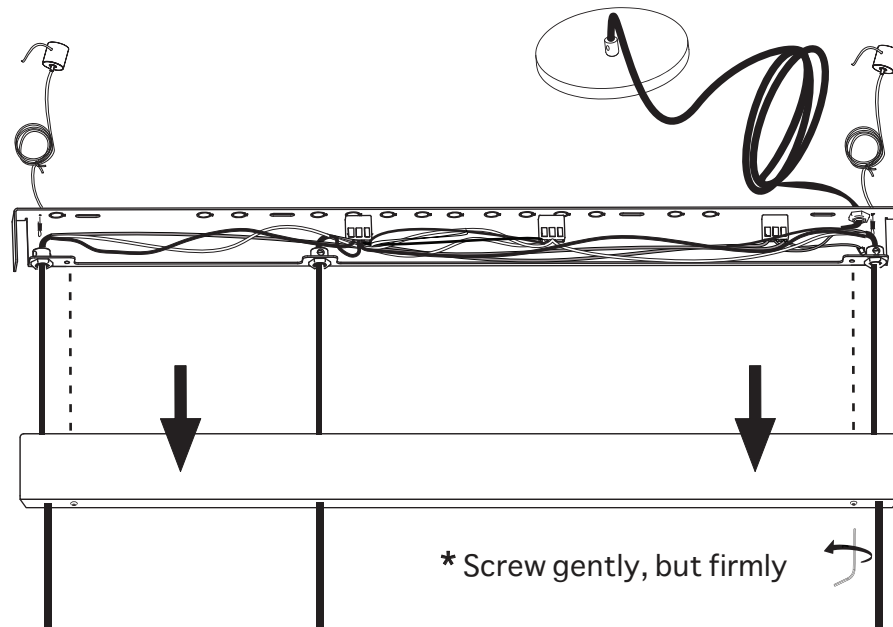

24"
610 mm

2

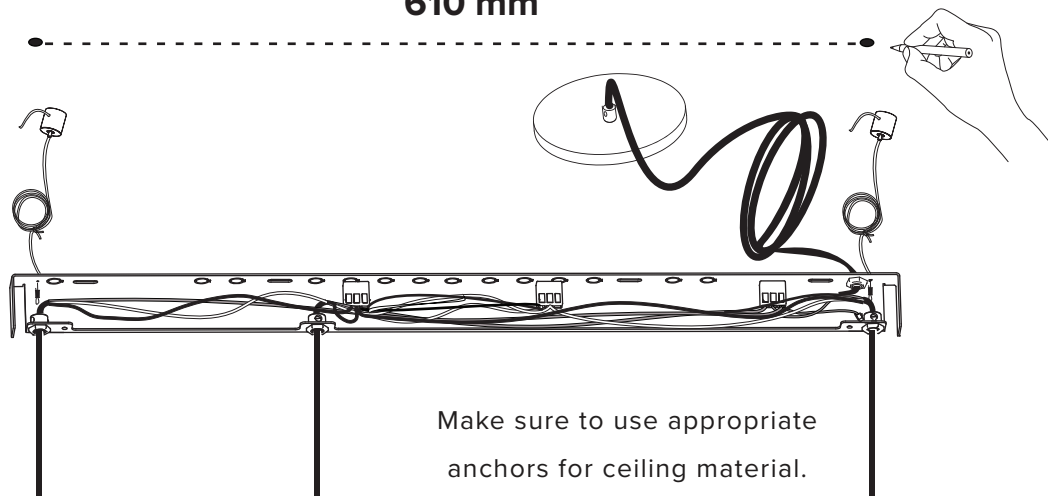

3

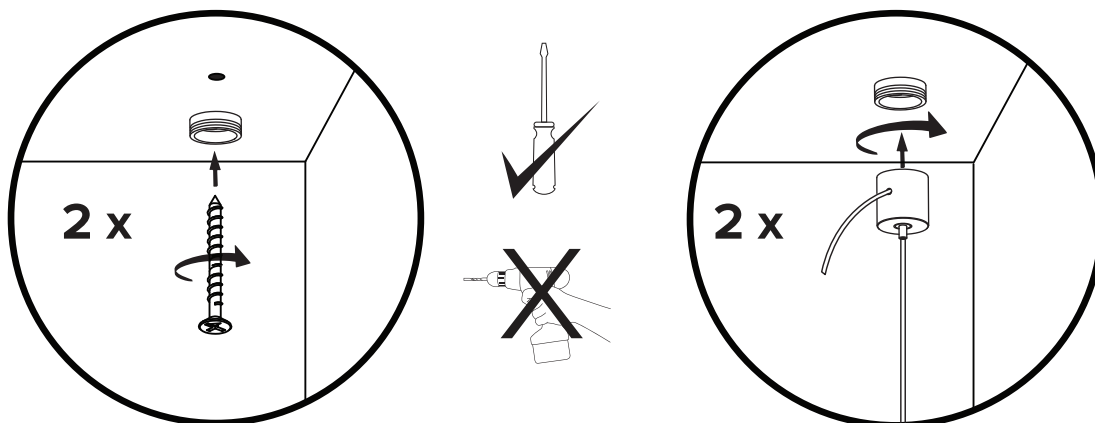

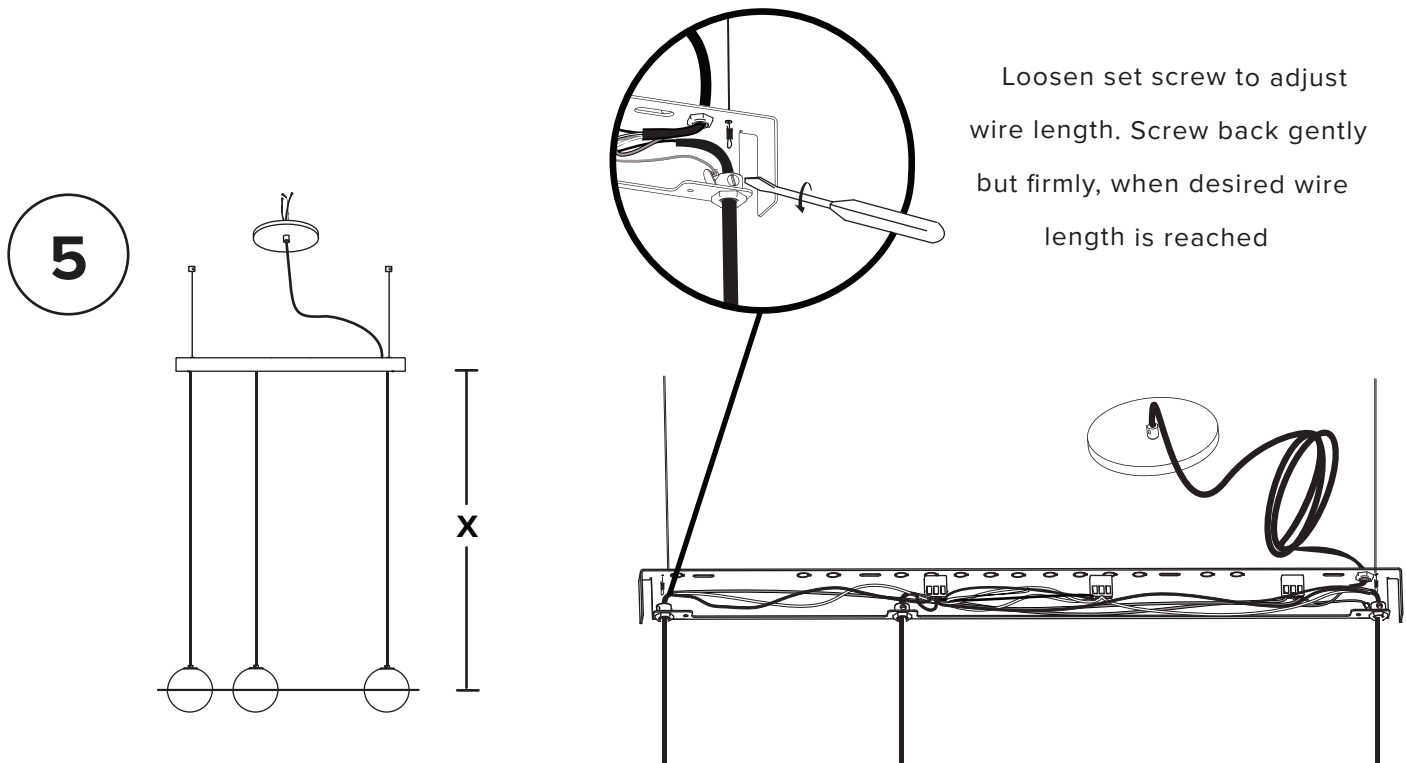
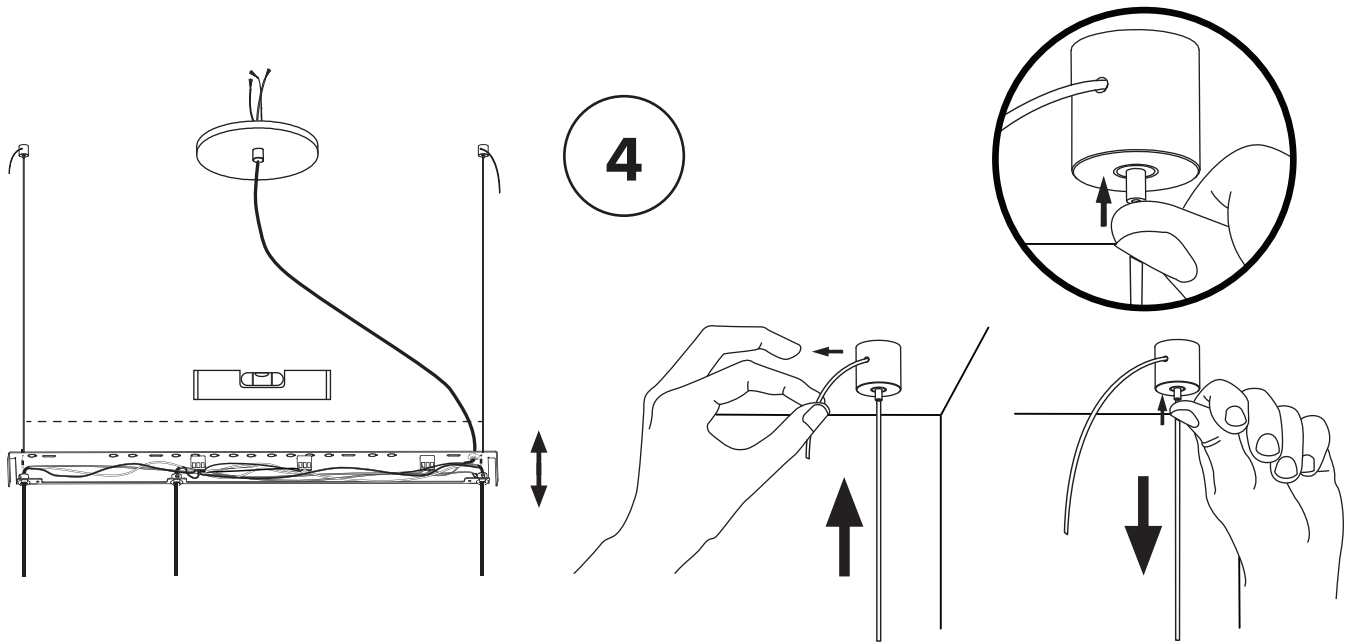

Trim wires to desired length (X).
Do not leave a large excess of wires
inside canopy. Reconnect them as before.

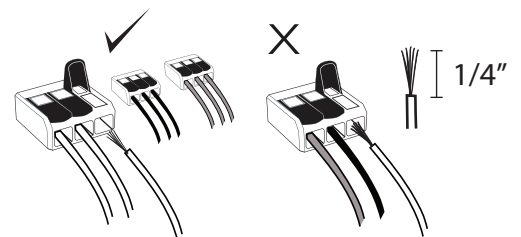

6

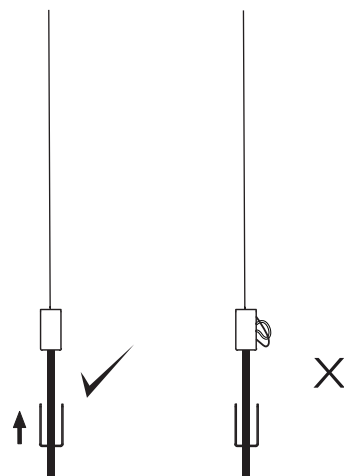
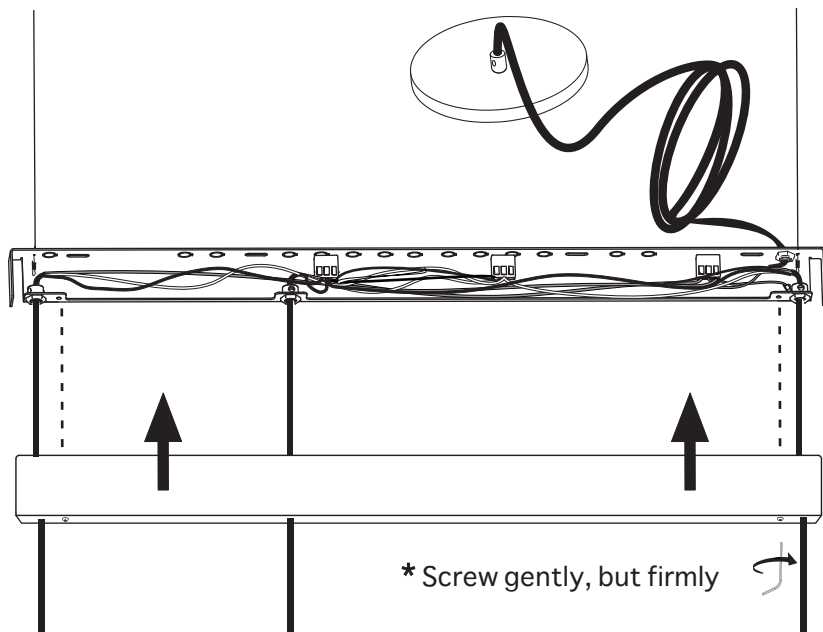

Ensure no wires are clipped or pinched during this operation.

7

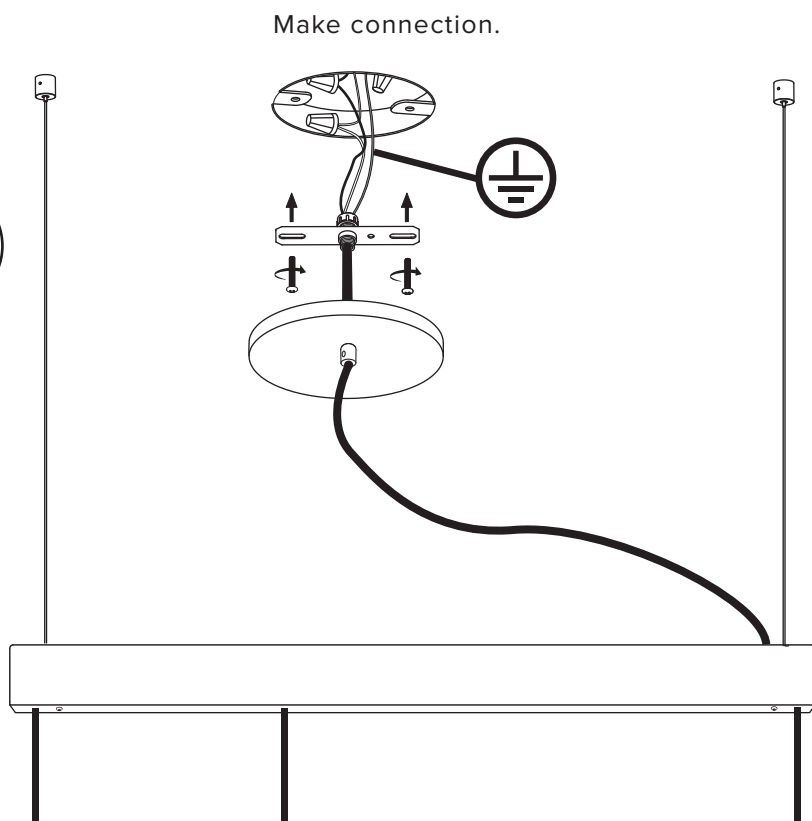

8

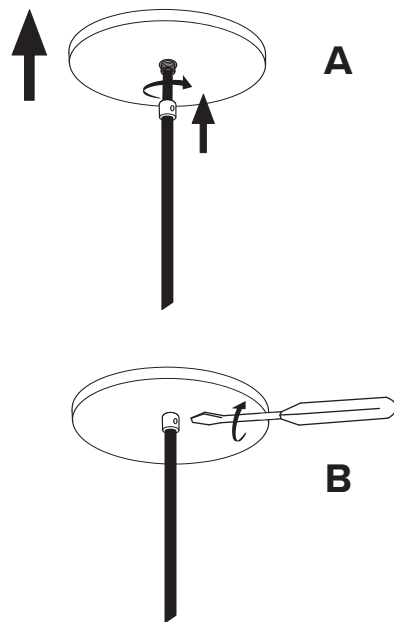

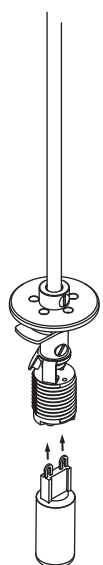

9

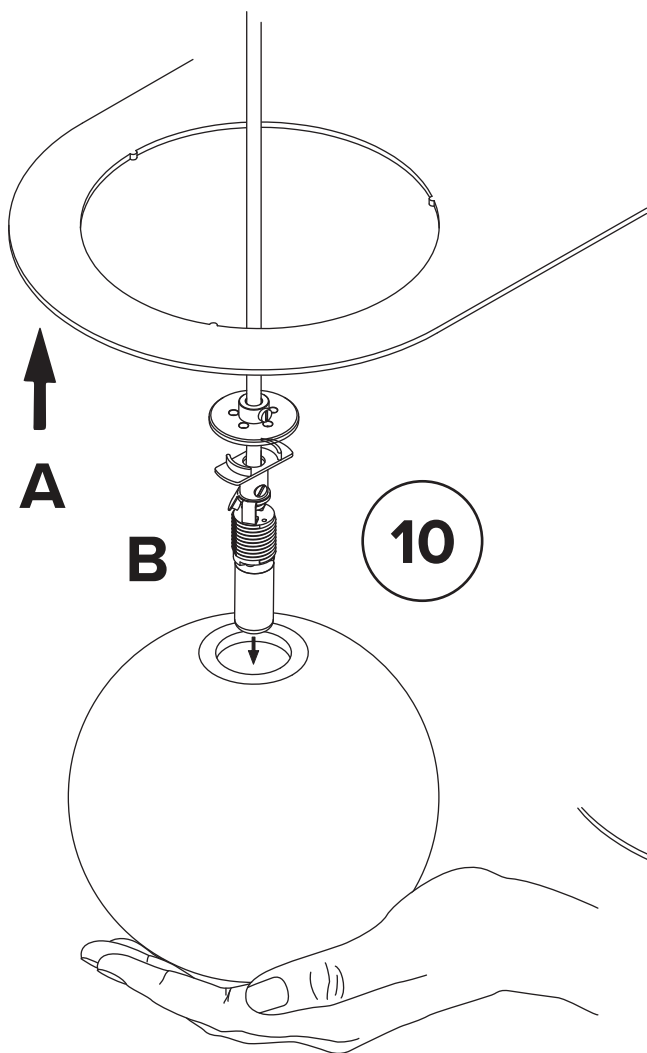

10

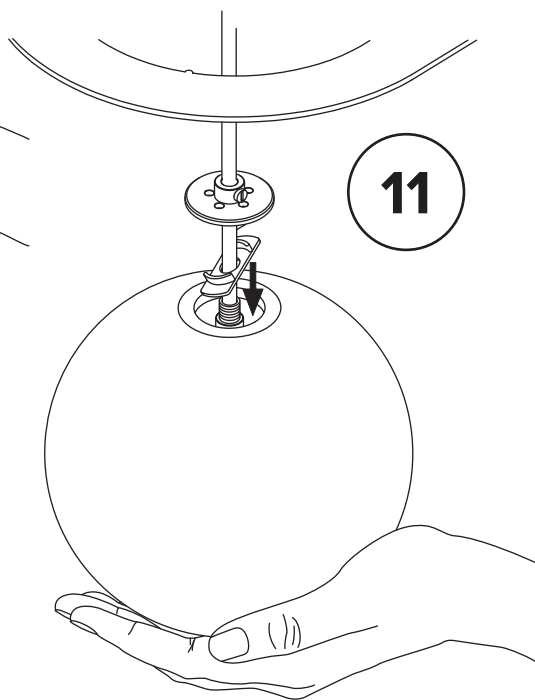

11

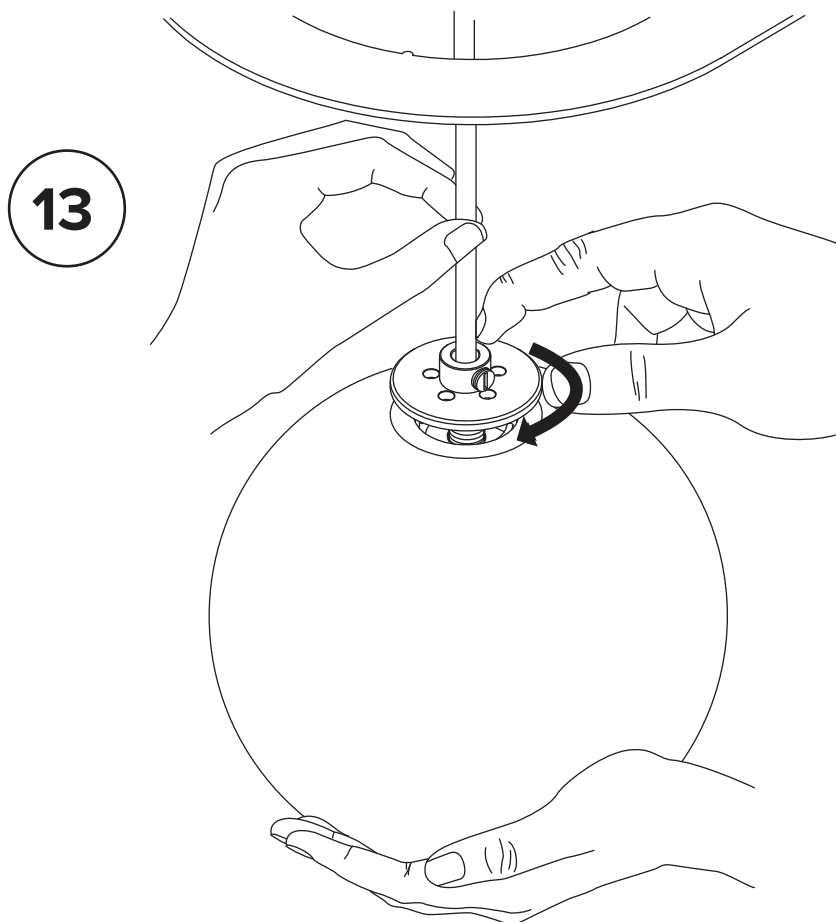
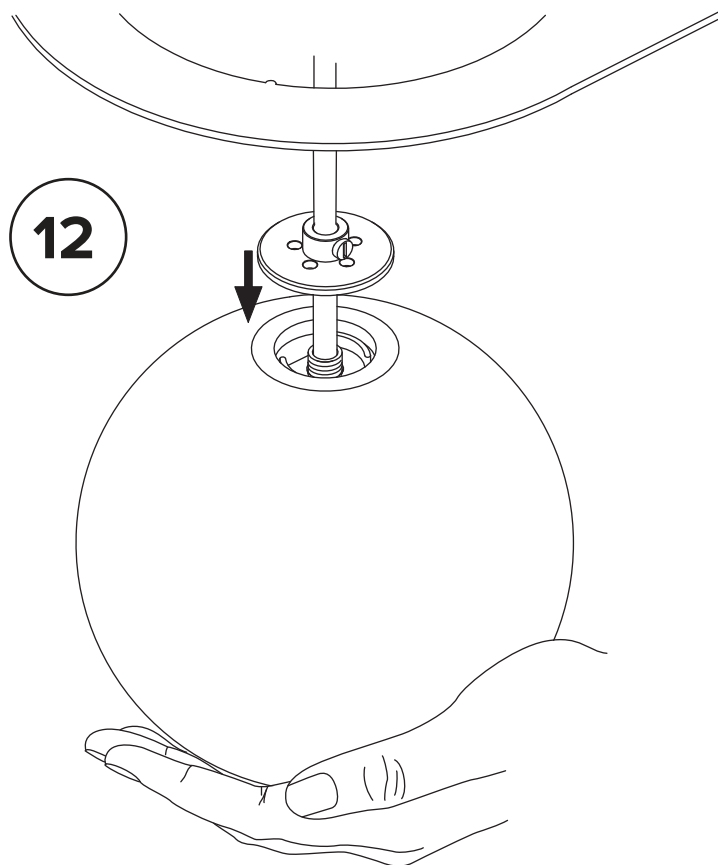

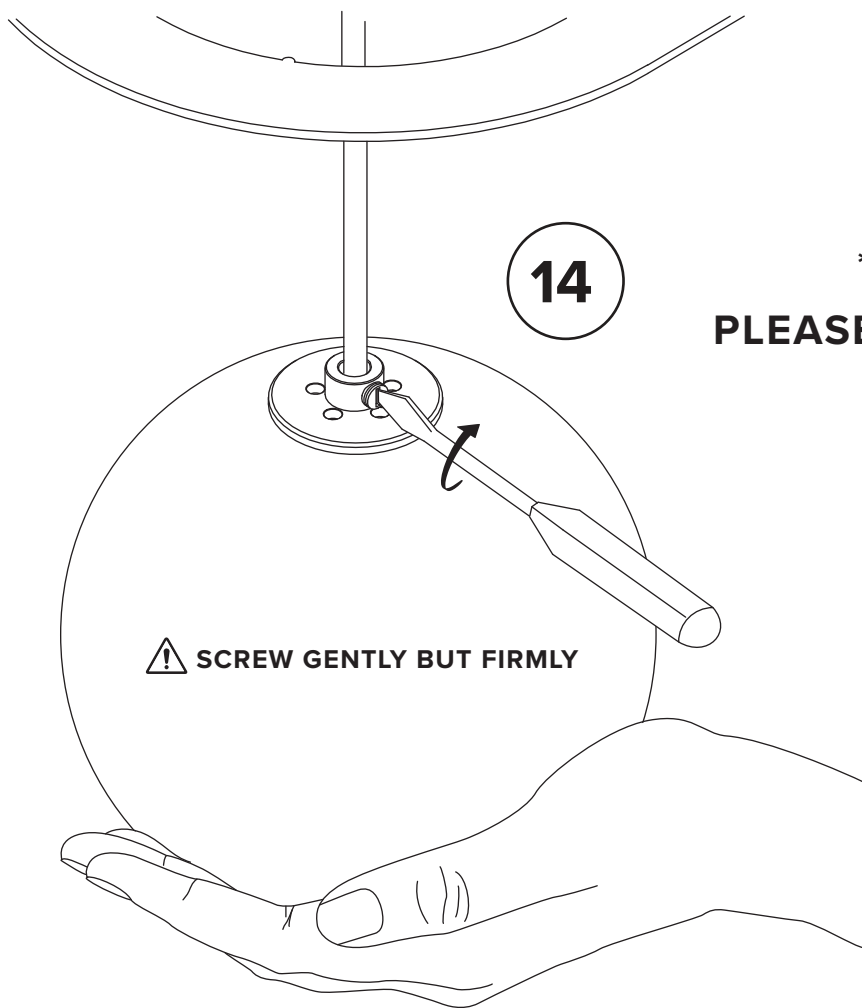

* To ensure safety,
**PLEASE FOLLOW THESE STEPS
CAREFULLY**

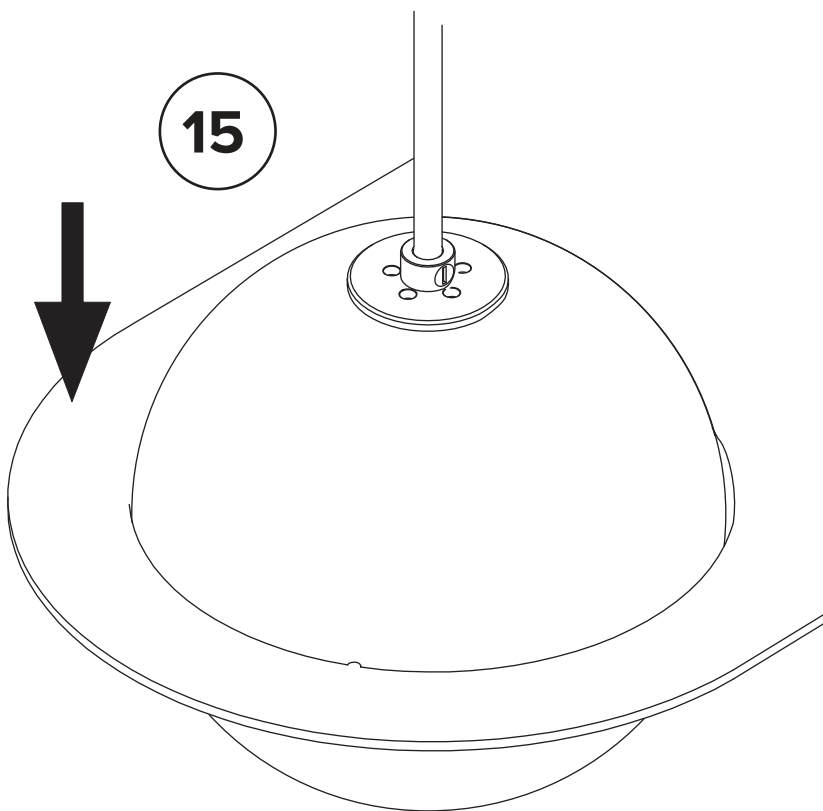

16

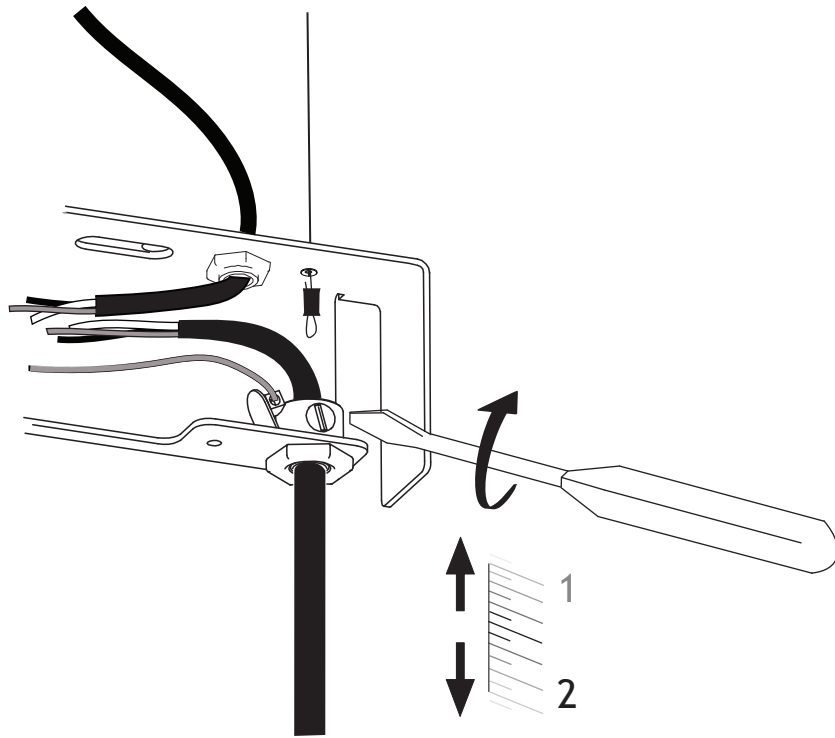

Make sure the globes are level
by micro-adjusting the wire
lengths.

SCREW GENTLY BUT FIRMLY

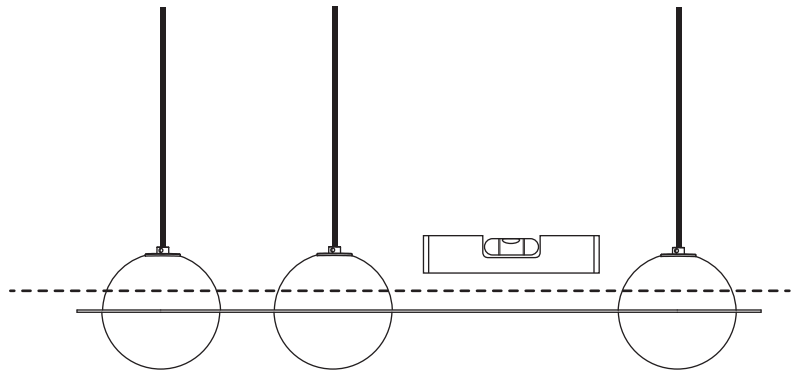
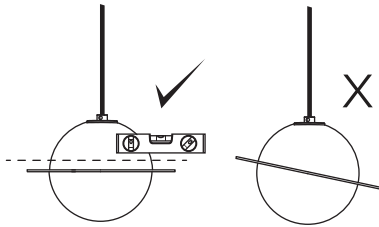

17

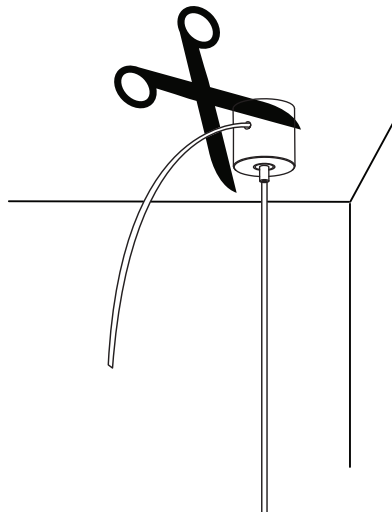

Trim extra cable when desired
height and level are achieved.

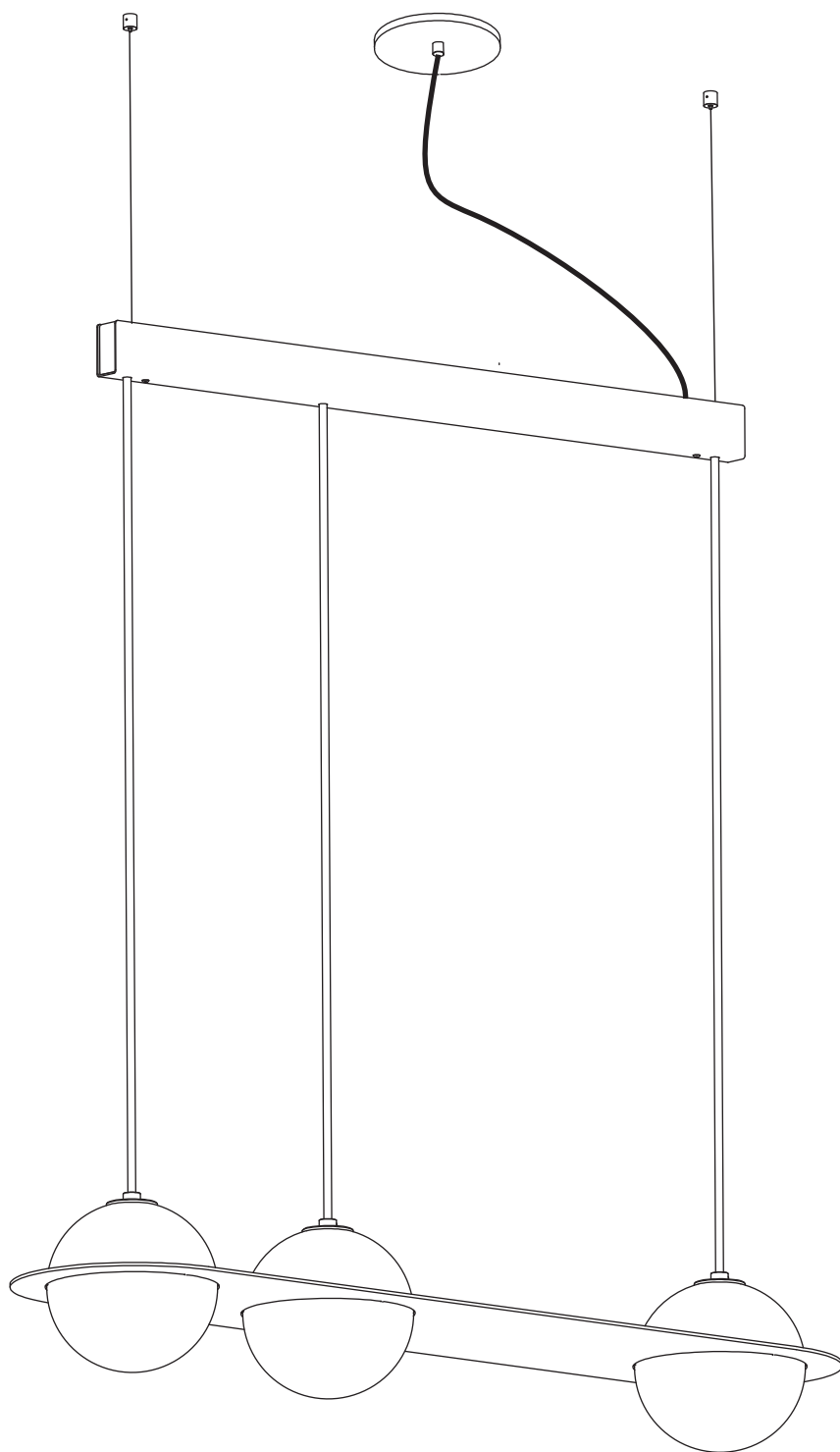

LAMBERT
& FILS
studio