

DOT LINE SUSPENSION

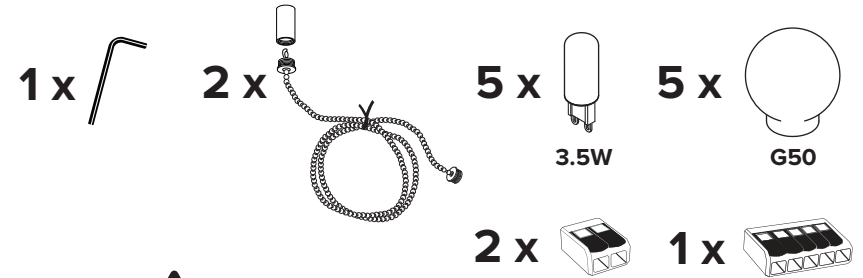

- To be installed by an electrician to an electrical box
- Use appropriate screws and anchors where necessary
- Wear enclosed gloves when handling lamp
- Handle materials with care. Please consult lamp maintenance sheet on our web site
- Should be used exclusively as a lamp and not as a shelving, display or hanging uni

lamp weight **11 lbs. / 5 kg**

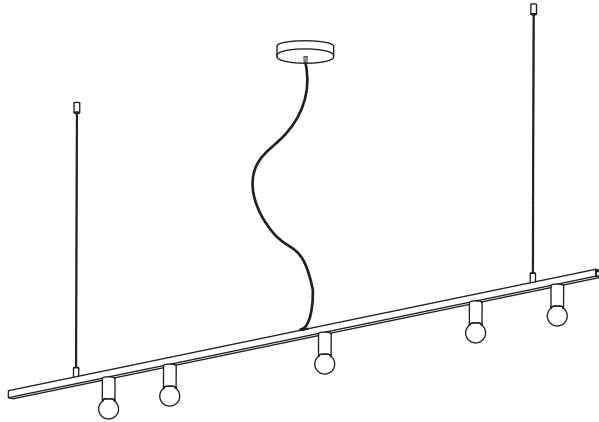
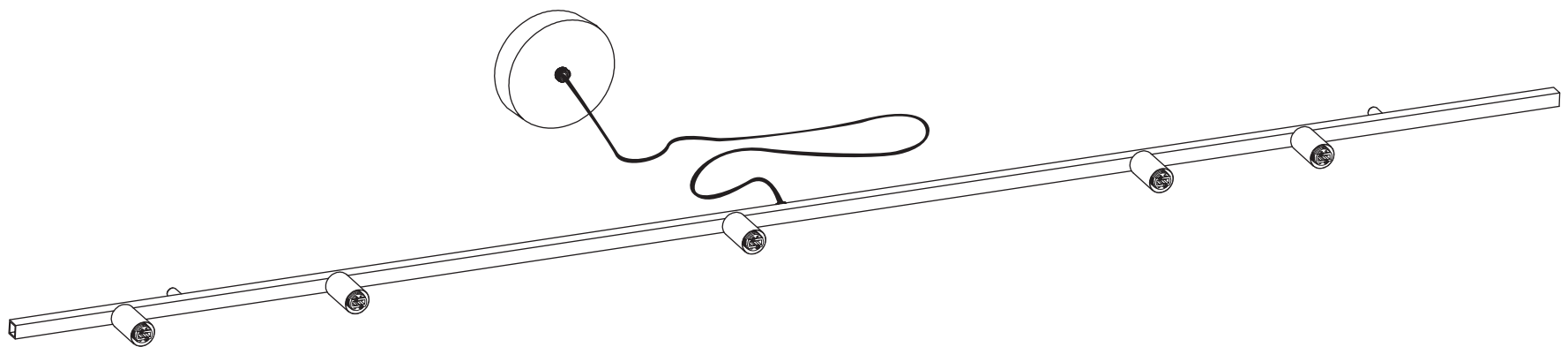

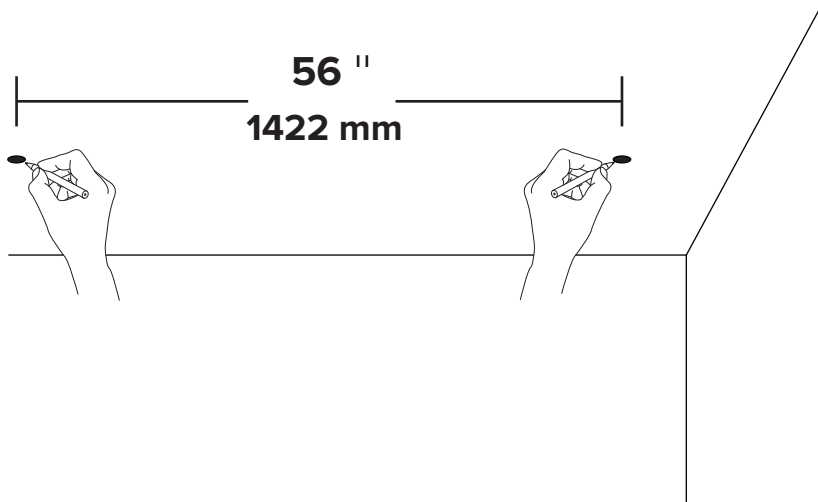

1

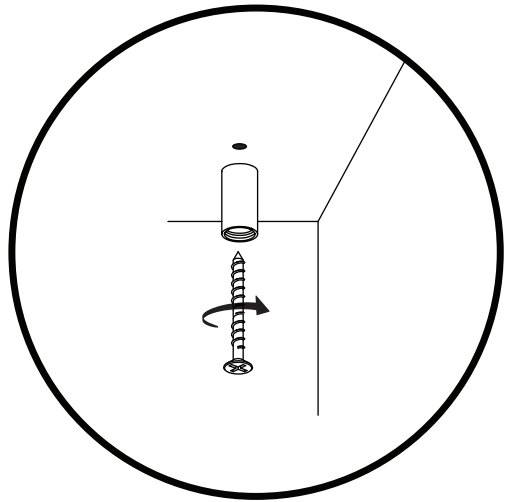

2

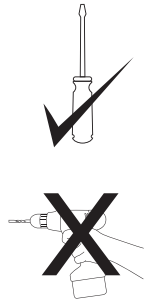

*** Use appropriate anchors**
Each anchor must
be able to support
27lbs / 12kg

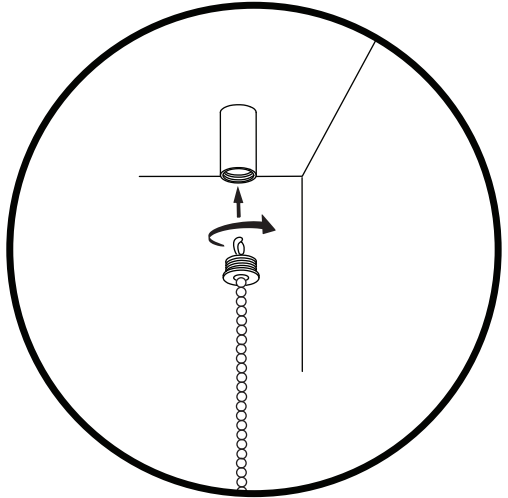

3

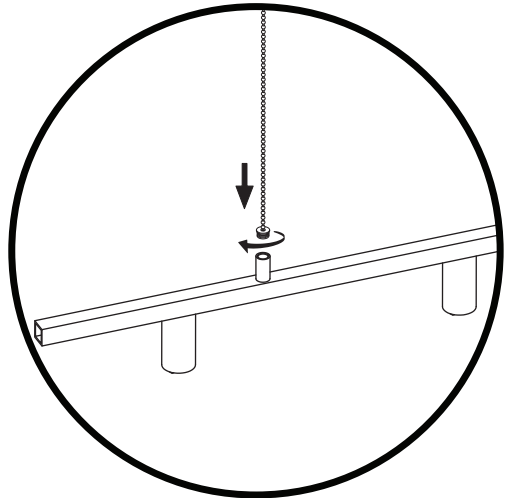

4

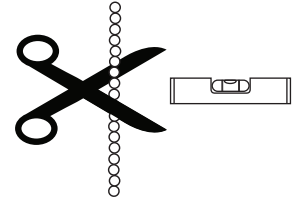

Do not install at less
than 4" from the ceiling

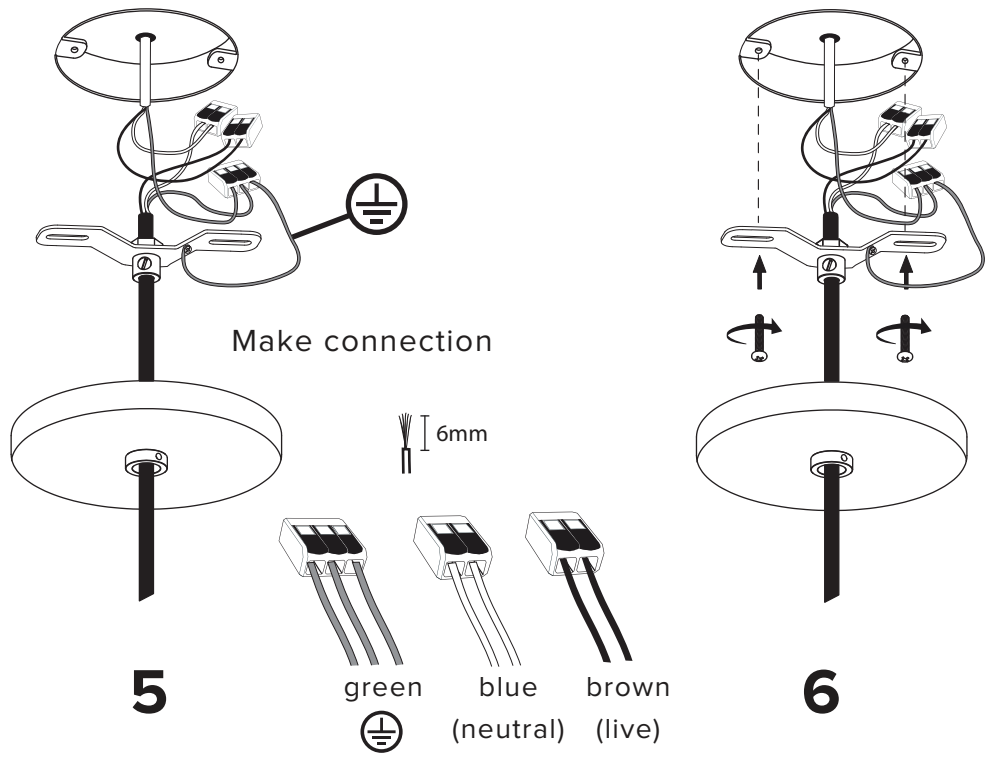

5

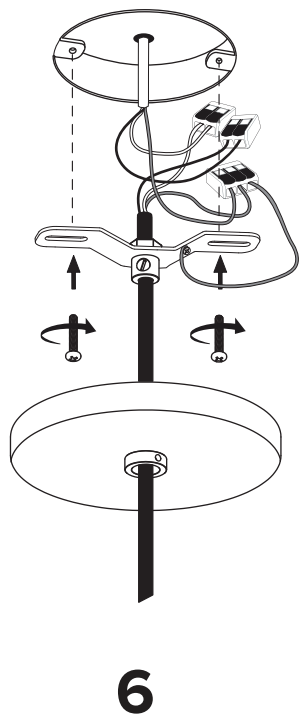

6

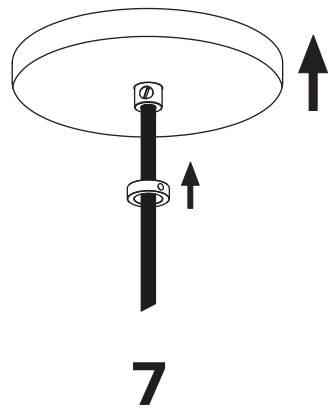
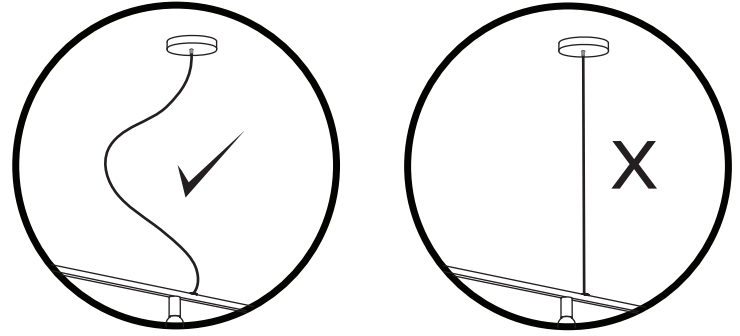

7

* Screw gently, but firmly

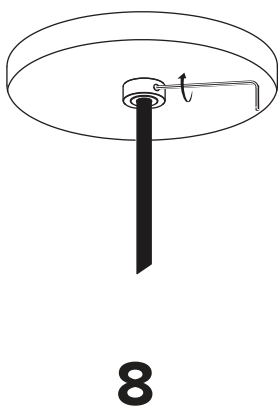

8

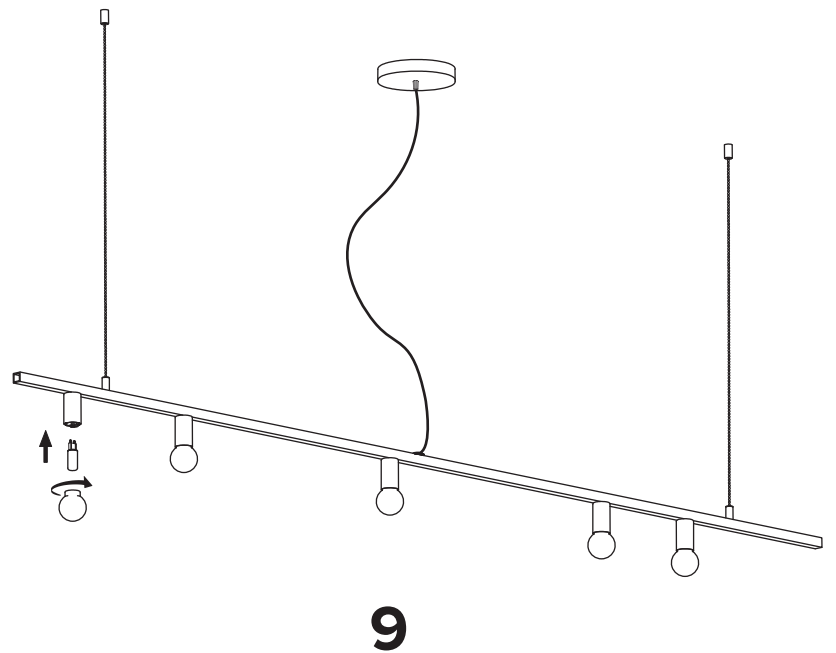

9