

CLIFF SUSPENSION

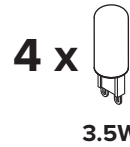

3.5W

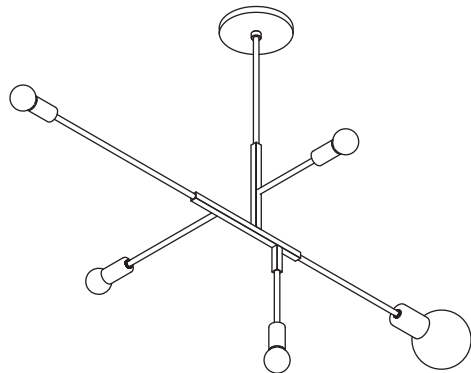

G50

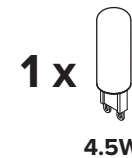

4.5W

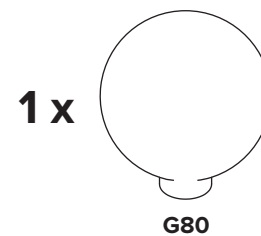

G80



- To be installed by an electrician to an electrical box
- Use appropriate screws where necessary
- Wear enclosed gloves when handling lamp
- Handle materials with care. Please consult lamp maintenance sheet on our web site

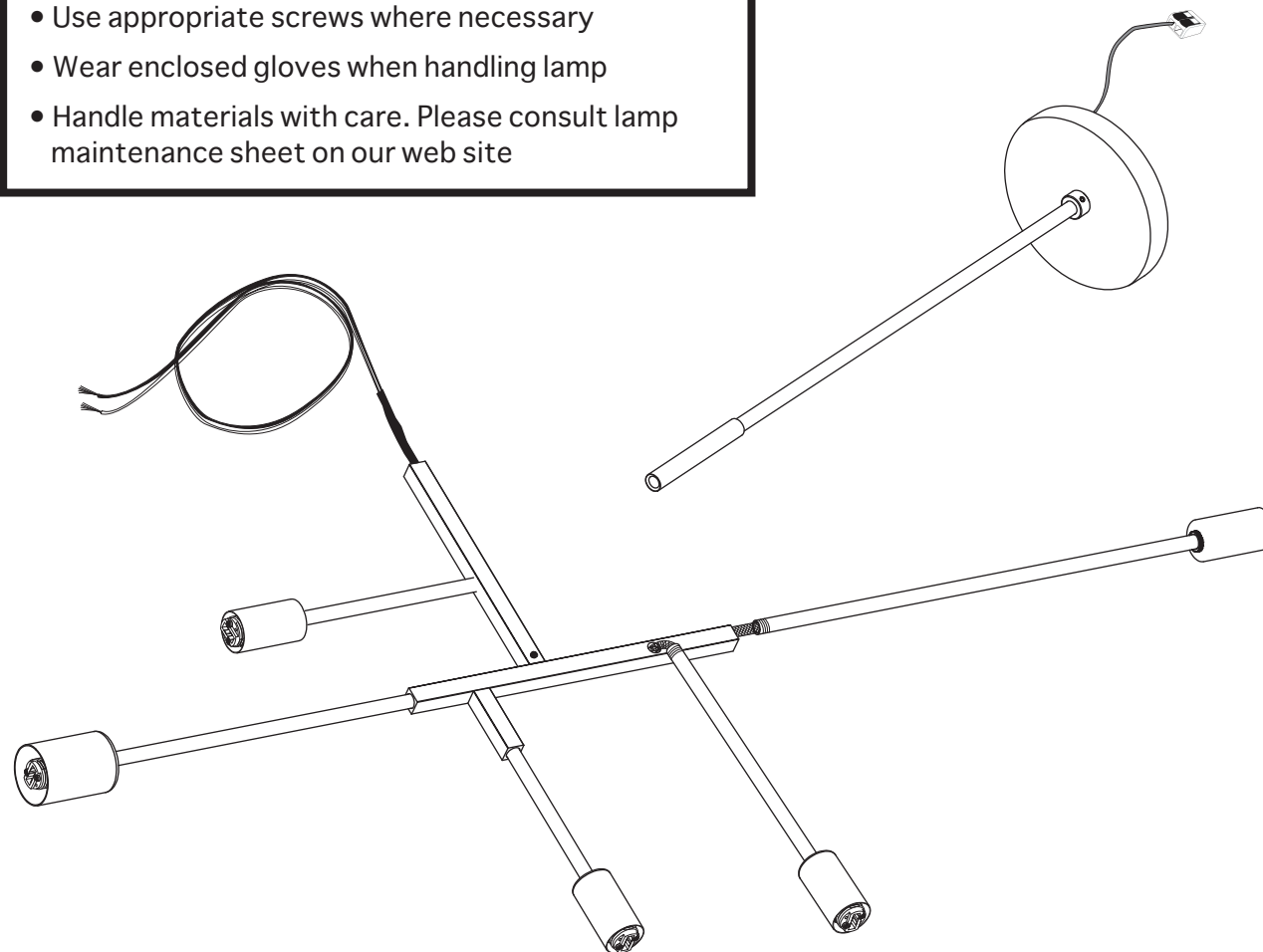

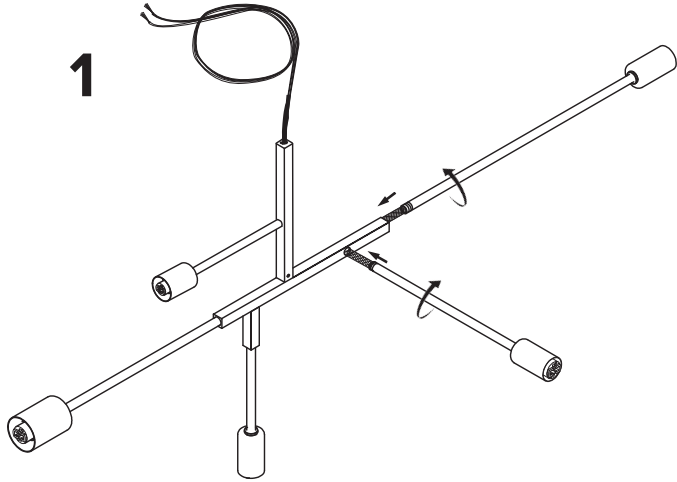

Rotate each arm 5 full rotations counterclockwise before inserting arms into body to prevent wires from over twisting.

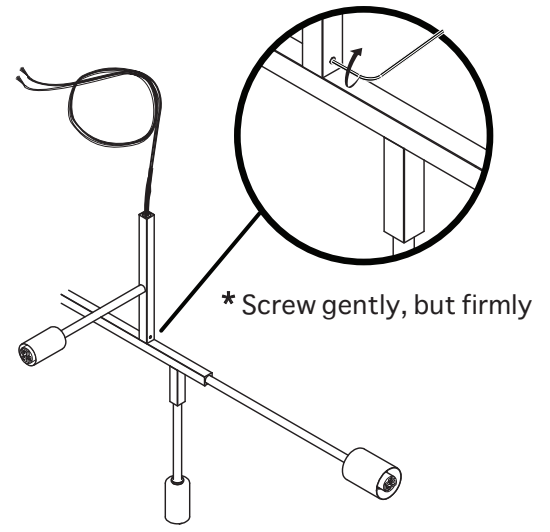
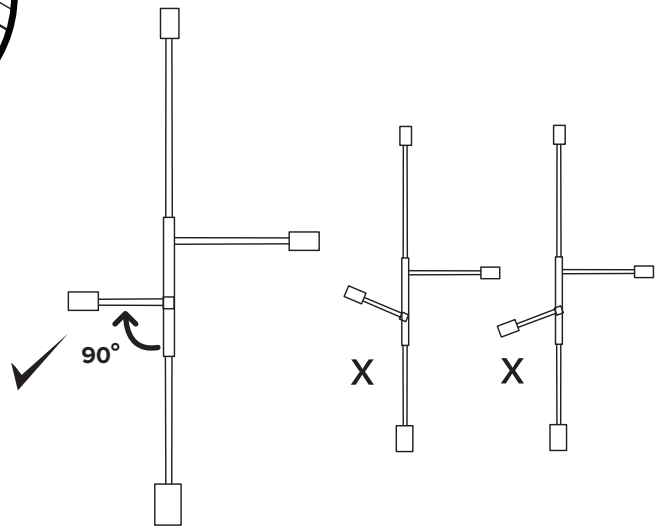
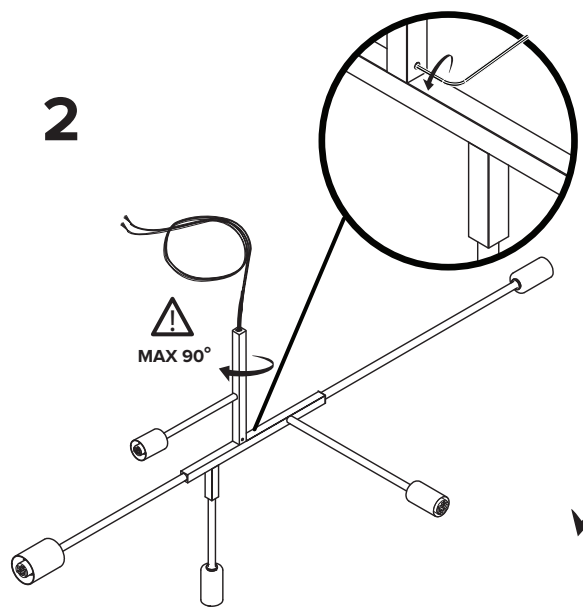

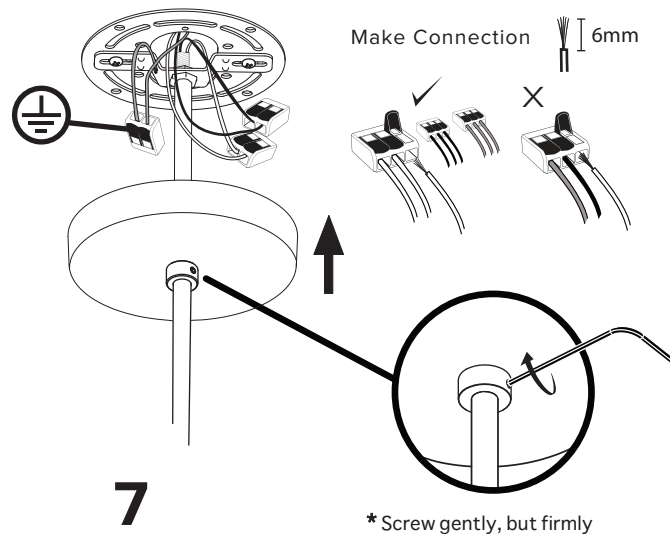
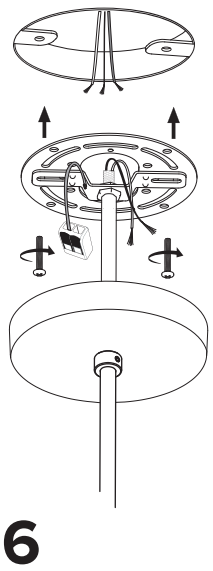
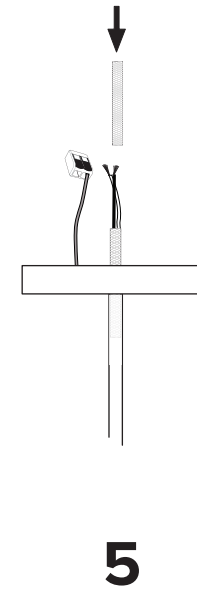
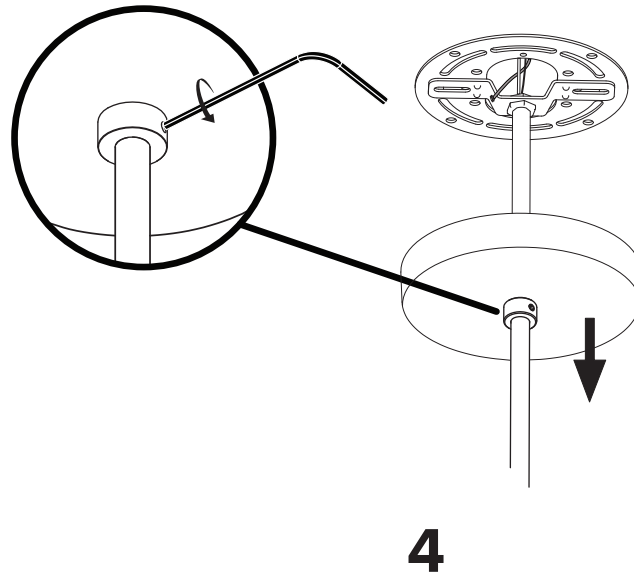
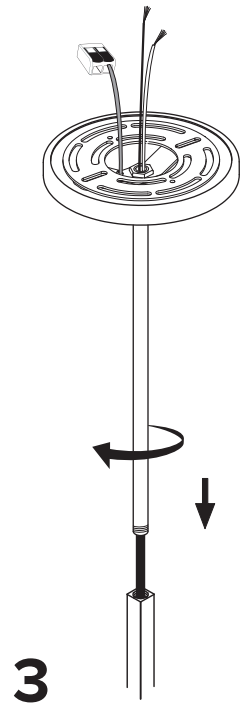

* Screw gently, but firmly

