

BEAUBIEN SUSPENSION

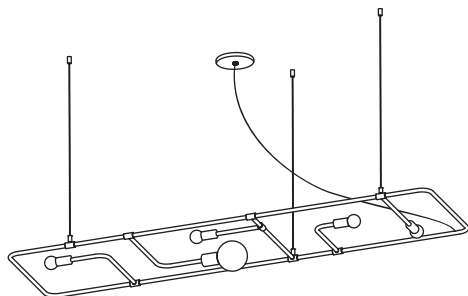

1 x

4 x

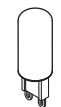

3.5W

1 x



4.5W

4 x



G50

1 x

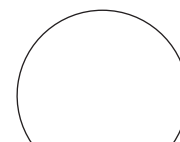

G80

3 x

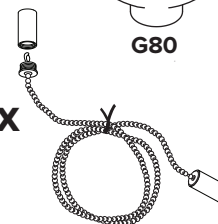

- To be installed by an electrician to an electrical box
- Use appropriate screws and anchors where necessary. Do not use the wall anchors for the ceiling position
- Wear enclosed gloves when handling lamp
- Hold lamp by the frame
- Handle materials with care. Please consult lamp maintenance sheet on our web site

lamp weight **17 lbs / 7.7 kg**

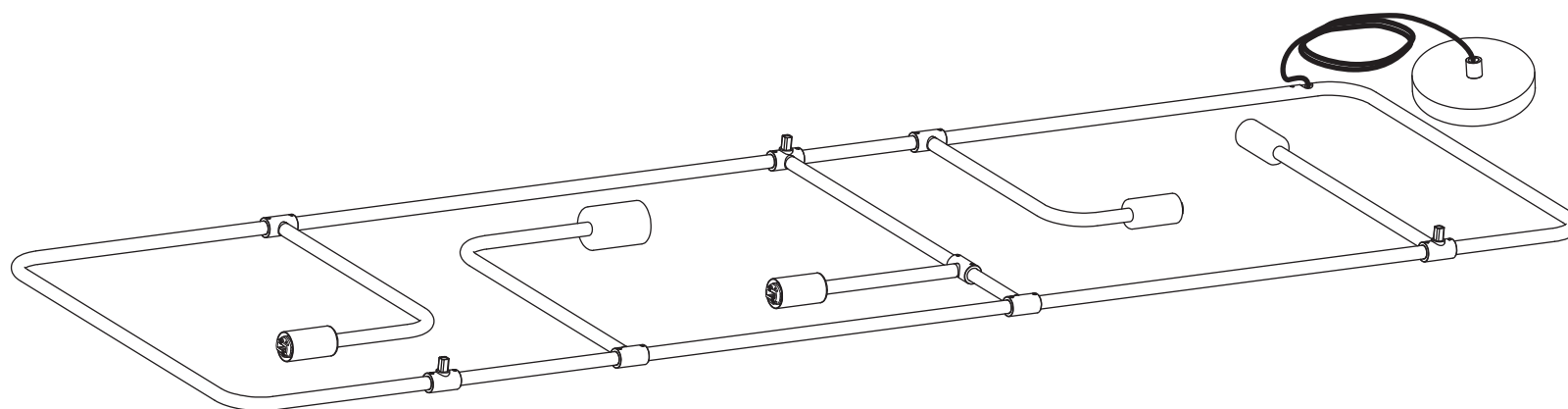

Do not install at less
than 4" from the ceiling

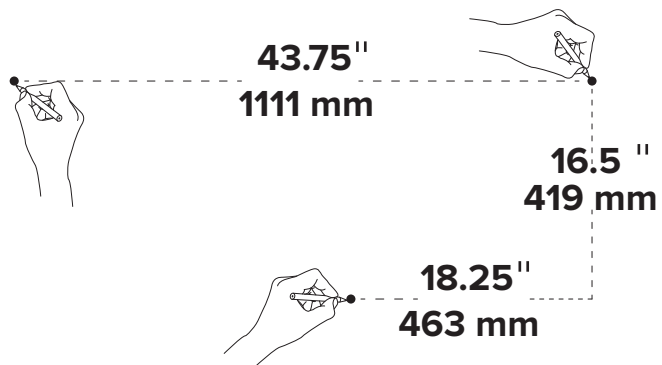

1

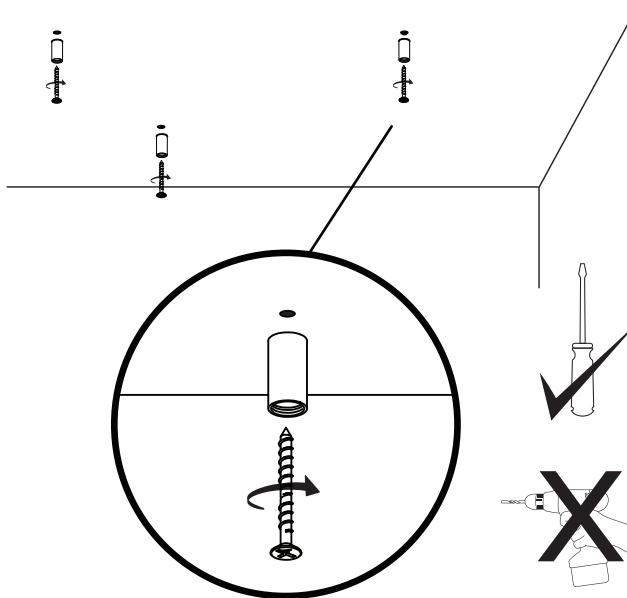

2

* Use appropriate anchors
Each anchor must
be able to support
43 lbs / 19 kg

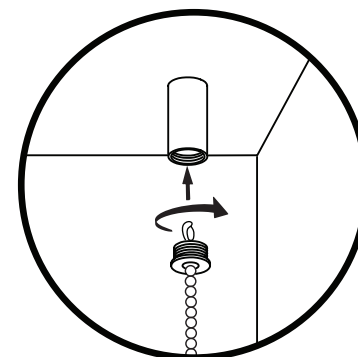

3

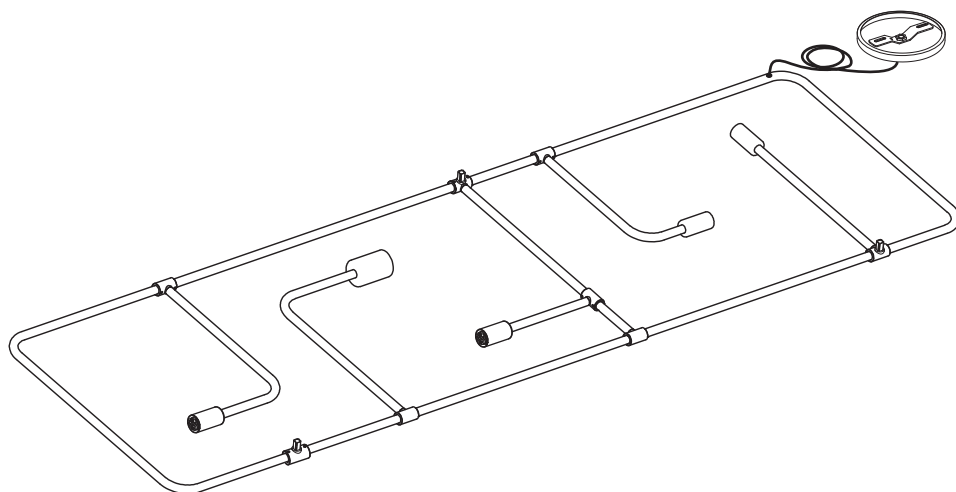

4

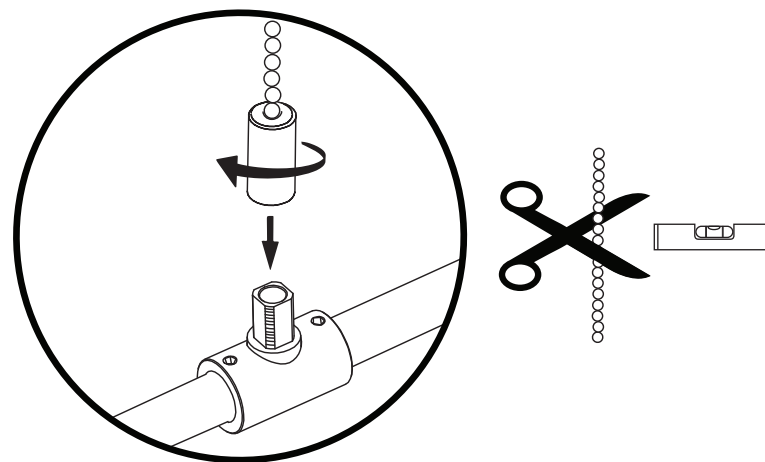

5

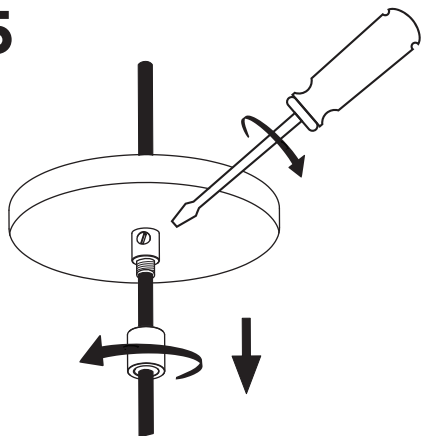

6

Tighten nylon set screw.
Make connection.

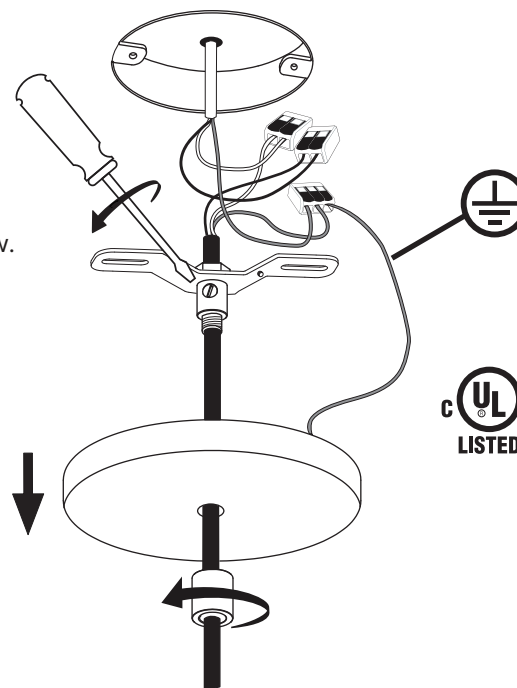

UL
LISTED

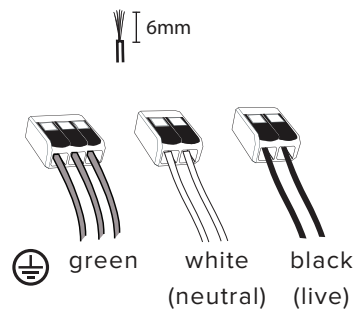

7

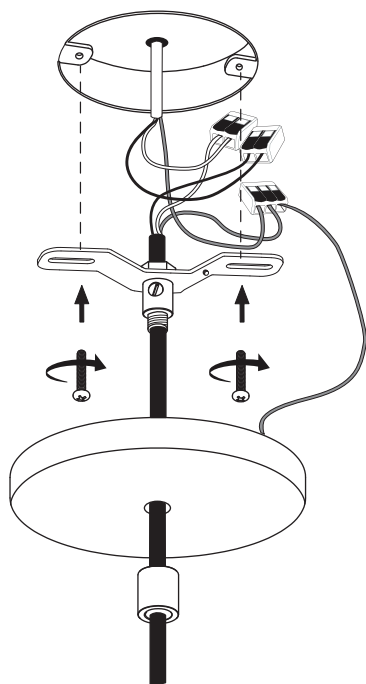

8

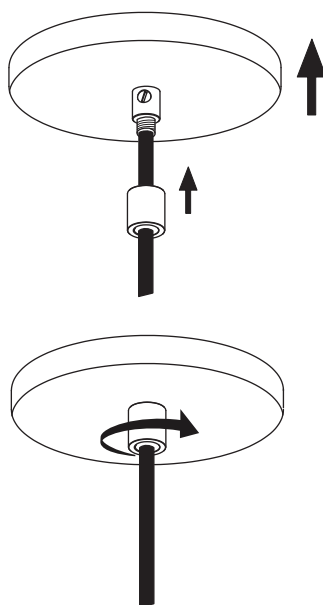

9

