

CLARK SUSPENSION

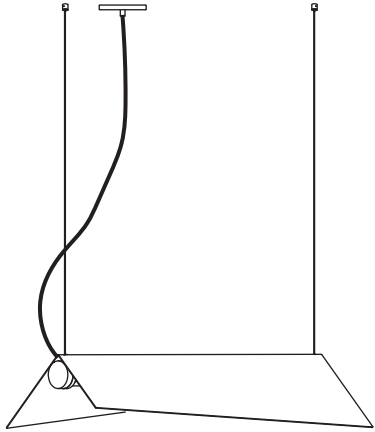

1 x  2 x 



- To be installed by an electrician to an electrical box
- Use appropriate screws and anchors where necessary
- Wear enclosed gloves when handling lamp
- Handle materials with care. Please consult lamp maintenance sheet on our web site

lamp weight **30 lbs / 13 kg**

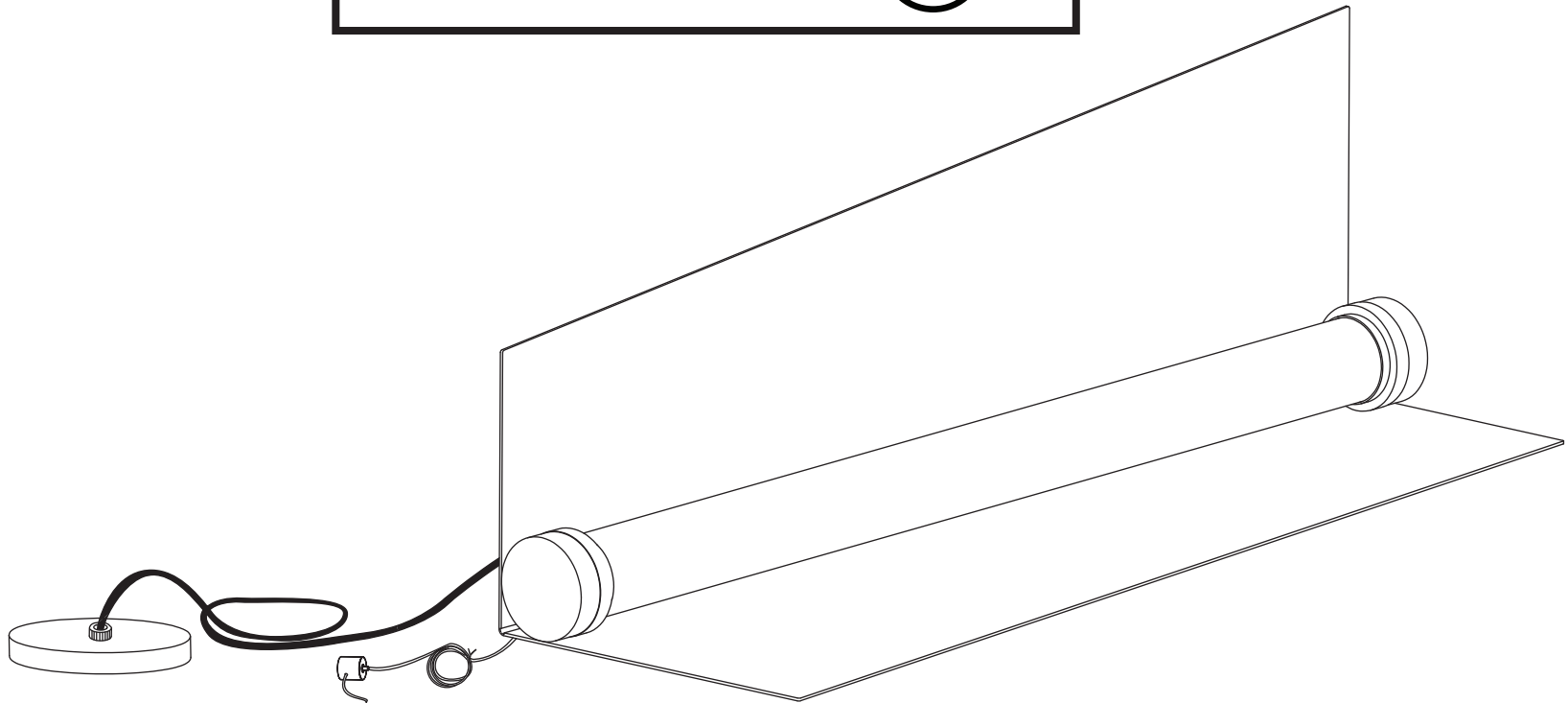

45 ³/₄ "
1162 mm



1

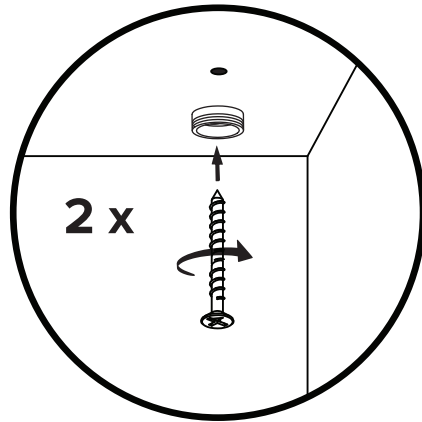

* Use appropriate anchors

2

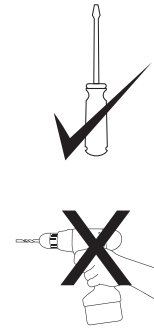

Each anchor must
be able to support
75 lbs / 34 kg

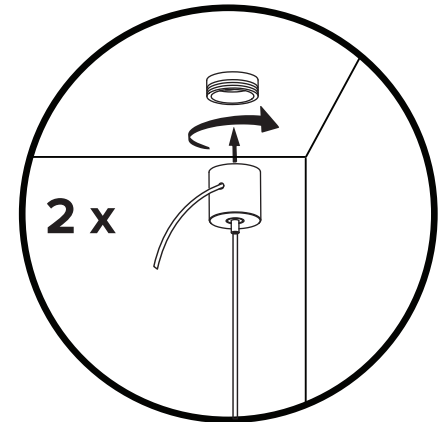

3

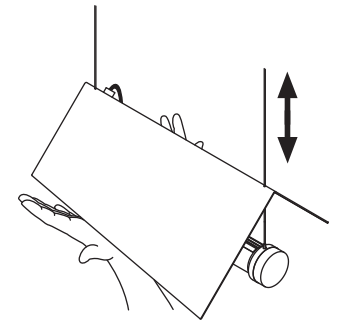
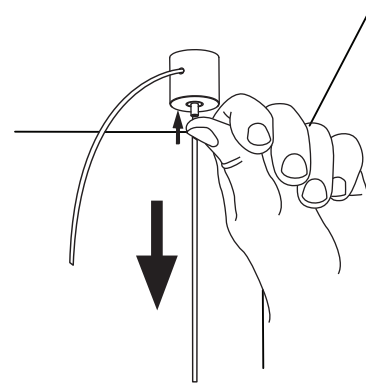
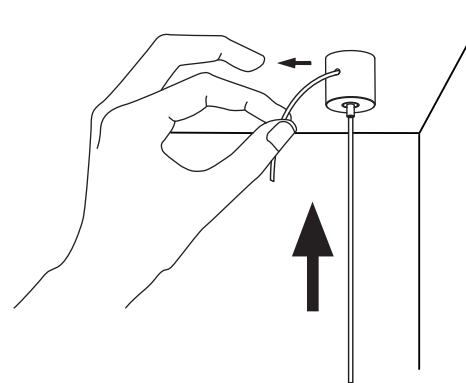
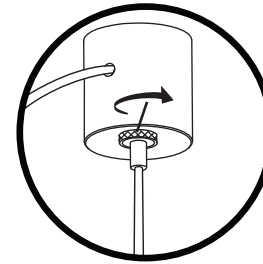
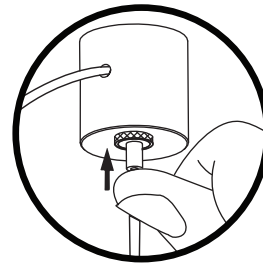
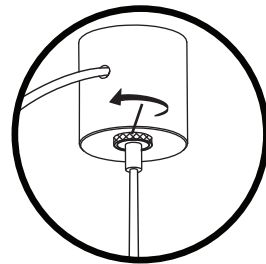
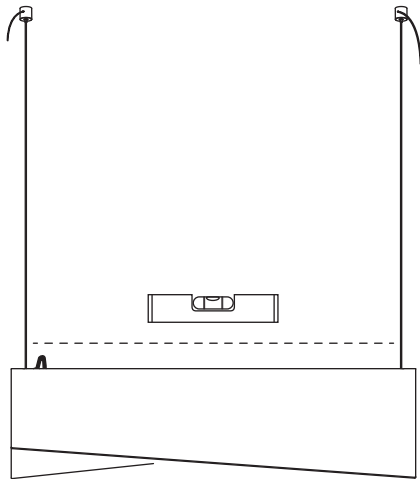

4

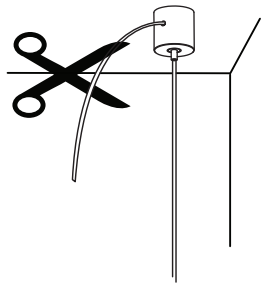

5

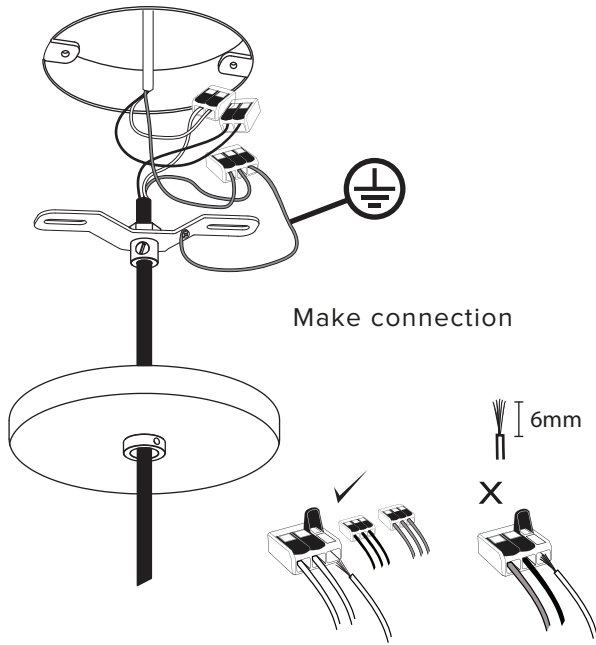

6

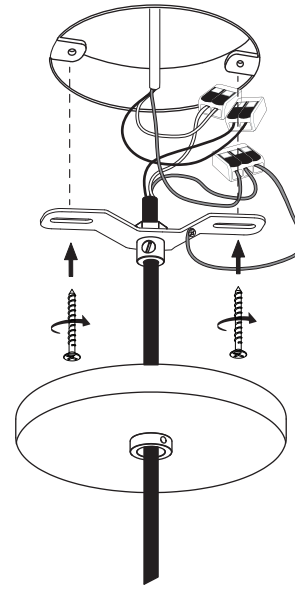

7

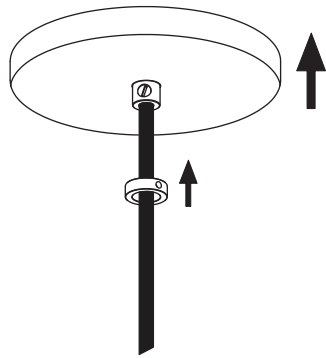

8

* Screw gently, but firmly

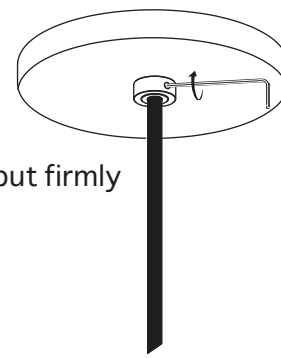

9

