

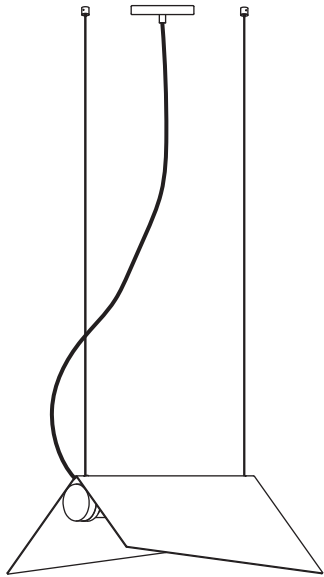

# CLARK SUSPENSION

2 x  1 x  1 x  2 x  2 x 





- To be installed by an electrician to an electrical box
- Use appropriate screws and anchors where necessary
- Wear enclosed gloves when handling lamp
- Handle materials with care. Please consult lamp maintenance sheet on our web site

**lamp weight 13 lbs.**



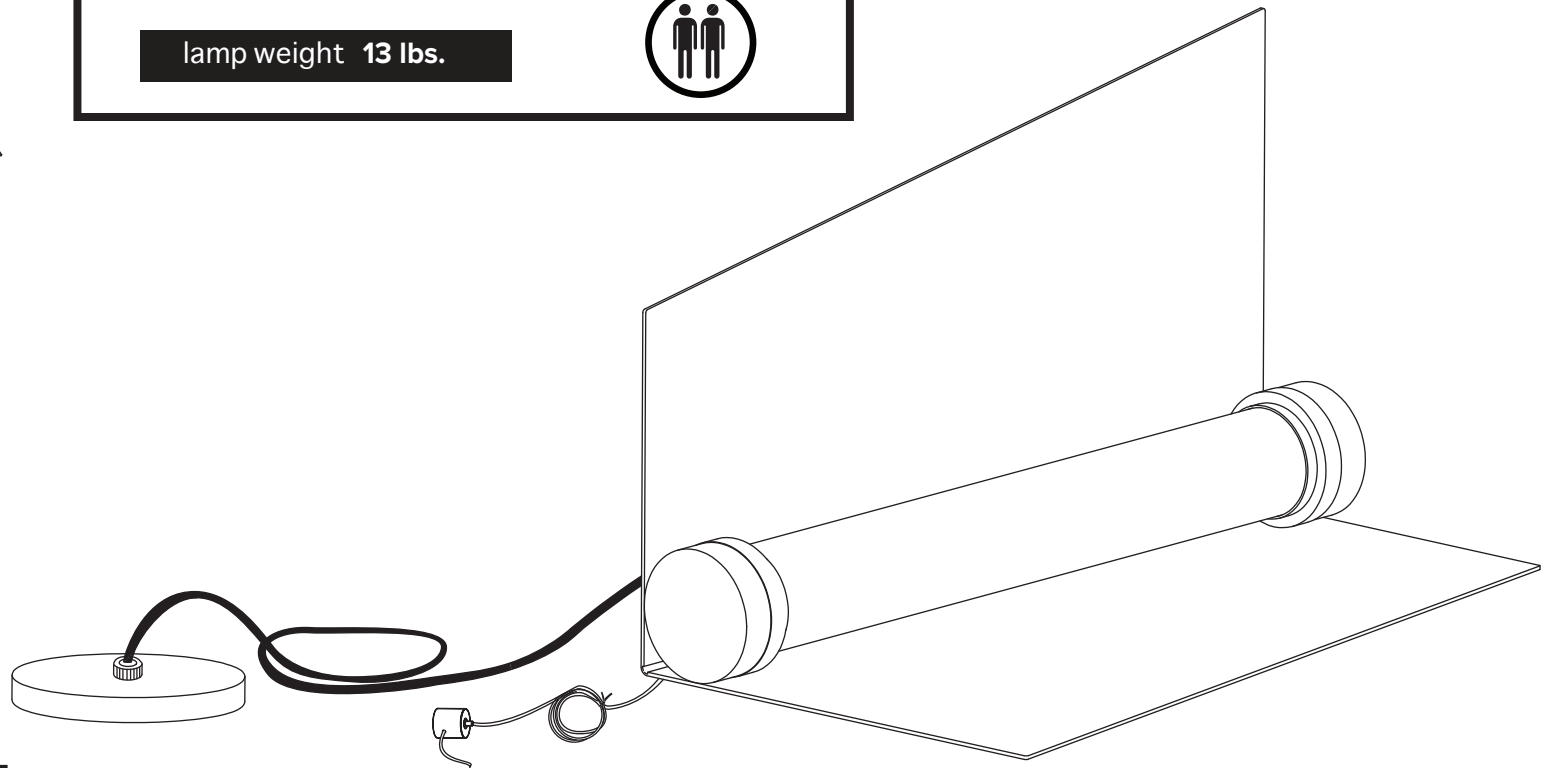

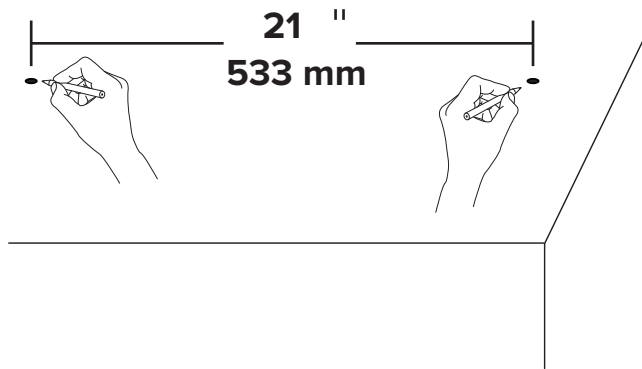

**1**

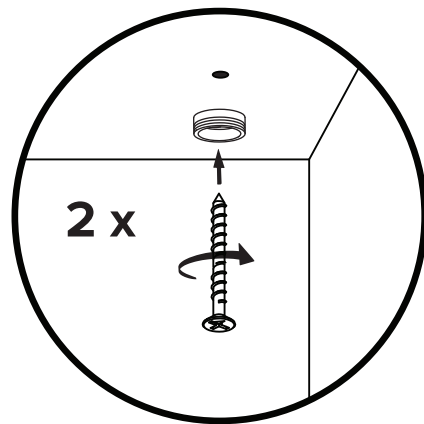

\* Use appropriate anchors

**2**

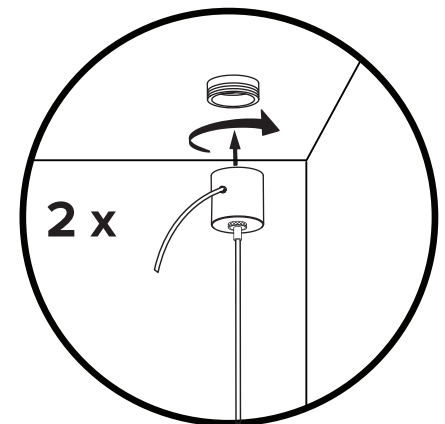
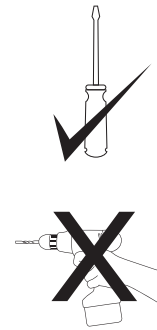

**3**

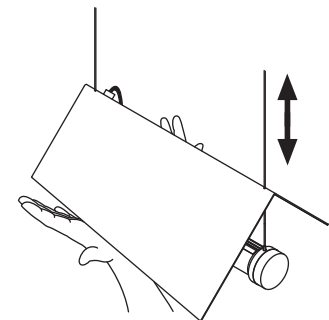
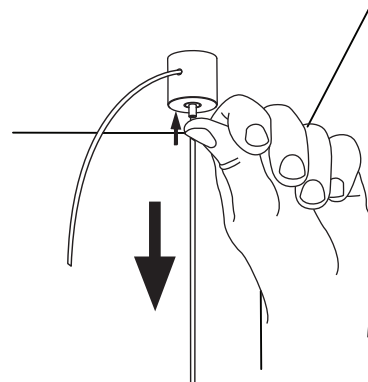
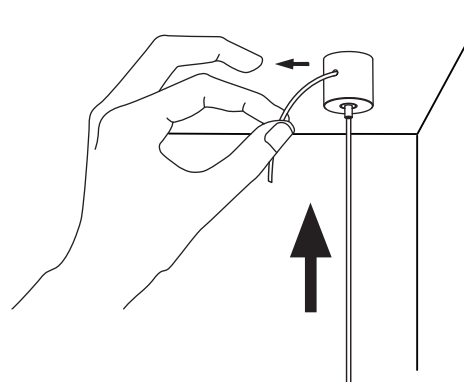
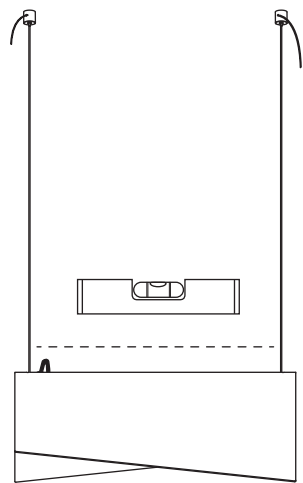
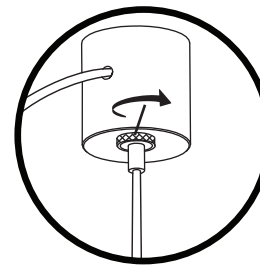
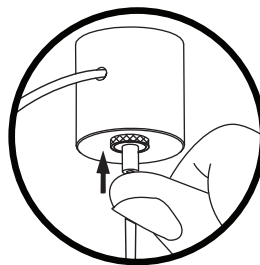
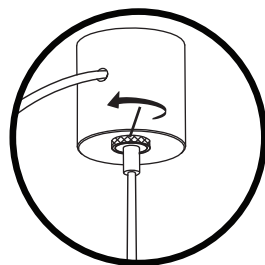

**4**

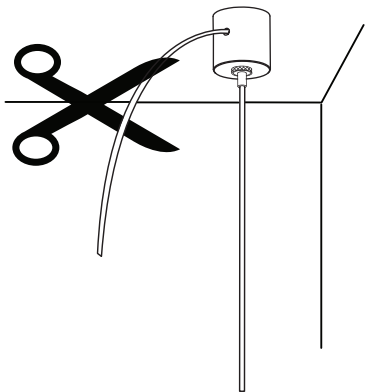

5

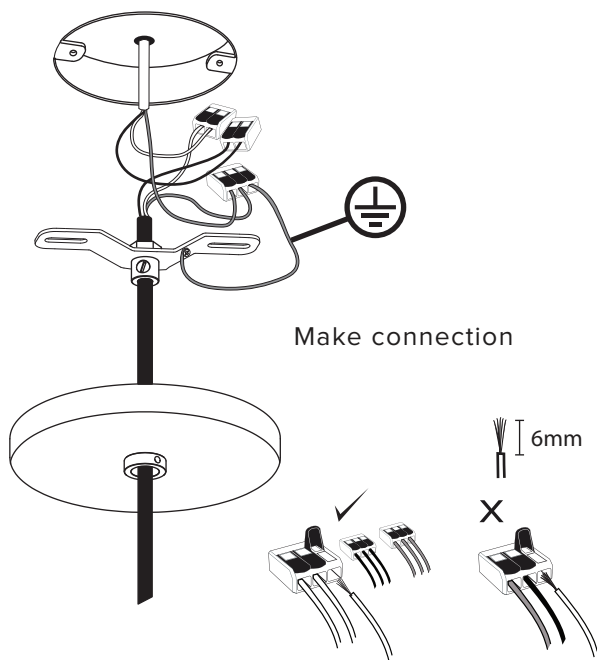

Make connection

6

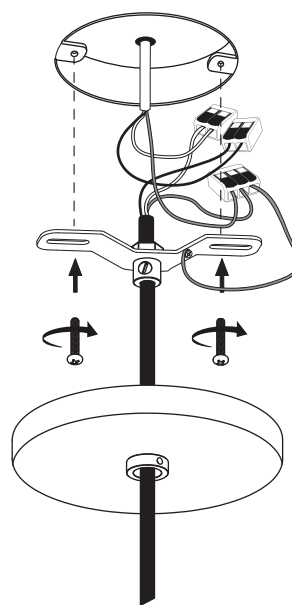

7

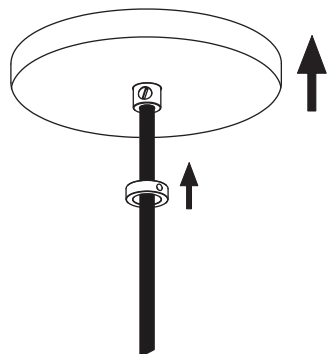
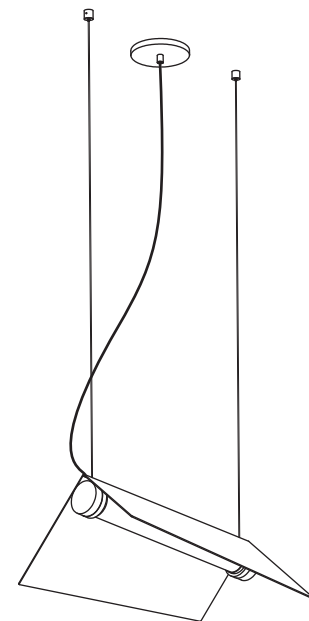

8

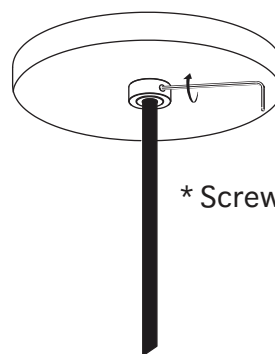

\* Screw gently, but firmly

9